



**2/1 2 WINDSOR PLACE**

MAIN STREET, BRIDGE OF WEIR

[www.corumproperty.co.uk](http://www.corumproperty.co.uk)



- 1 | BEDROOM
- 1 | BATHROOM
- 1 | PUBLIC ROOM

A charming traditional top floor flat offering well presented accommodation in the heart of the popular village of Bridge of Weir.

- Traditional tenement flat
- Central village location
- Lounge with bay window
- Double bedroom and box room
- Fitted kitchen
- Family bathroom
- Gas central heating
- Double glazing

#### Amenities

Bridge of Weir has good road links towards the M8 motorway, Glasgow International Airport and Glasgow city centre. The village offers a wide range of local amenities including restaurants, shops and a library. The village has a popular Primary School with a nursery and secondary education is at the prestigious Gryffe High School. There is also private schooling nearby at St. Columba's in Kilmacolm. The village has two 18 hole golf courses and there is fishing available on the River Gryffe.

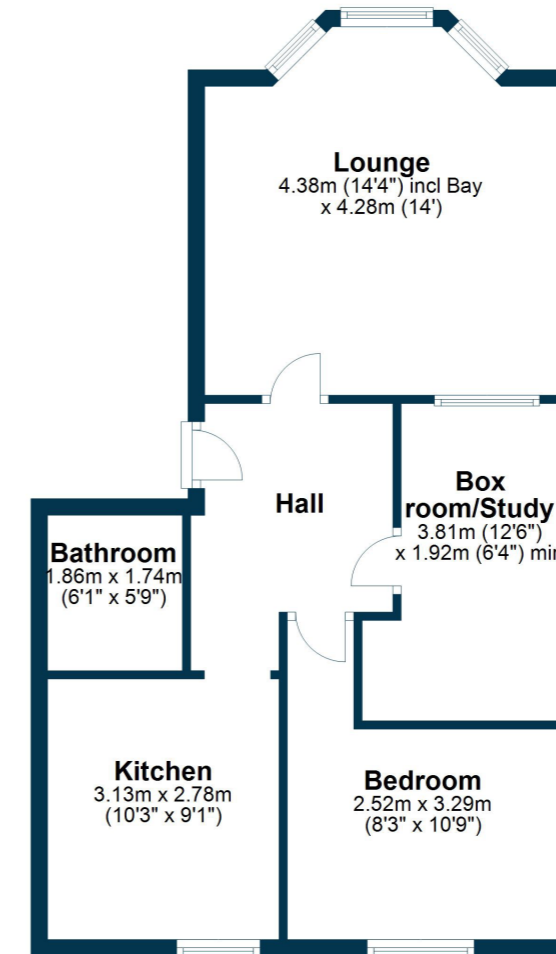

**Sat Nav:**  
2 Windsor Place, Main Street, Bridge of Weir, PA11 3AF

**BW2426**

\*All measurements and distances are approximate.  
Floorplans are for illustration purposes and may not be to scale.

For the full home report visit  
[www.corumproperty.co.uk](http://www.corumproperty.co.uk)





WE'RE **SOLD** ON  
YOUR FUTURE

  
C O R U M

Corum Bridge of Weir  
2 Windsor Place, Main Street, Bridge Of Weir, PA11 3AF

T: 01505 691 400

E: [bridgeofweir@corumproperty.co.uk](mailto:bridgeofweir@corumproperty.co.uk)

[www.corumproperty.co.uk](http://www.corumproperty.co.uk)