



Marseilles Close, Duston, Northampton

£240,000



 2
  1
  1

| EPC rating: D

- Two Double bedrooms
- Popular Location
- Private Garden

- Cul de Sac
- Excellent Access to A45 & M1
- Off Road Parking For 2 Cars



Email
northampton@northwooduk.com

Phone
01604607080

Description

A two bed end of terrace property located in the sought after area of Duston, which offers excellent access to the A45 & M1. Locally, it's a 5 minute walk to a local convenience store, and a quick drive away from schools and parks. It is also located within short driving distance to the Sixfields leisure complex with many restaurants, public houses and a cinema on offer.

The property features a fitted kitchen, one reception room, two double bedrooms, and a fitted family bathroom. To the outside of the property is a south-facing rear garden. With gas central heating and private off-road parking space for 2 cars, this property is a fantastic option for a home to settle down in for a professional couple or a small family.

Photographs



More photographs



Floorplan

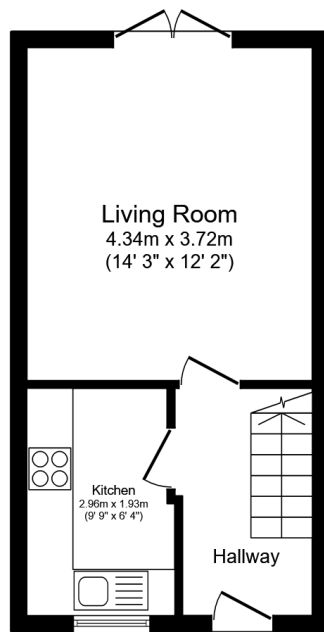

Ground Floor

Floor area 27.5 sq.m. (296 sq.ft.)

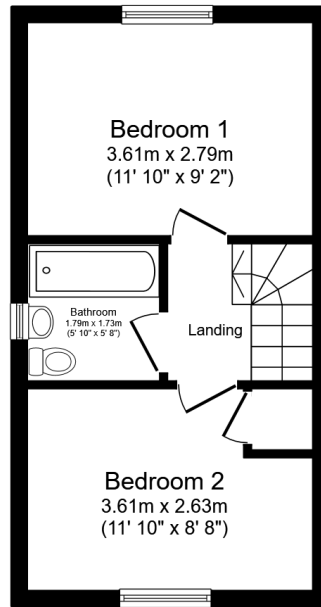

First Floor

Floor area 27.5 sq.m. (296 sq.ft.)

Total floor area: 55.0 sq.m. (592 sq.ft.)

This floor plan is for illustrative purposes only. It is not drawn to scale. Any measurements, floor areas (including any total floor area), openings and orientations are

Map

