

Crucible

Homes



Church Street
Sheffield, S35 9WE

£140,000

Overview

Two bedrooms

Village location

Set over four floors

Occasional attic room

Basement

Lovely garden



Description

SUMMARY ACCOMMODATION Make it your own ... imagine living in a picture perfect cottage in the heart of the village, with countryside walks on the doorstep and a garden made for pottering in, this lovely two bed home with an occasional attic room could be the one to make it all come true.

Accommodation in brief comprises: Lounge, inner hall, Kitchen, stairs down to cellar (also accessible via front of property), first floor landing, two first floor bedrooms, bathroom, stairs to attic room.

Outside the property has a small garden to the front, to the rear is a fantastic garden with raised patio area for seating and steps down to a lawned rear garden backing on to local parkland.

The property is in the heart of Ecclesfield Village with views to the front overlooking the Church, just a short stroll away there are a host of local amenities and transport links. Local schools are within walking distance, and the M1 motorway is just a few minutes drive away making it ideal for commuting. The property benefits from no onward chain.

LOUNGE 12' 1" x 11' 5" (3.7m x 3.49m)

KITCHEN 12' 9" x 11' 5" (3.9m x 3.5m)

BEDROOM ONE 12' 1" x 11' 5" (3.7m x 3.5m)



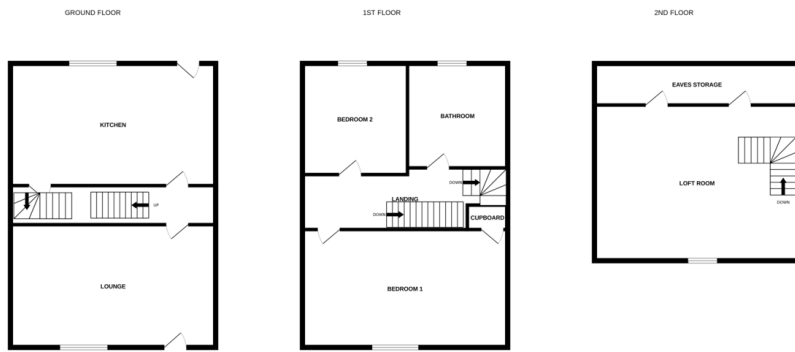

Whilst every attempt has been made to ensure the accuracy of the description contained here, measurements of doors, windows, rooms and any other items are approximate and no responsibility is taken for any error, omission or mis-statement. This plan is for guidance purposes only and should be used as such by any prospective purchaser. The services, systems and appliances shown have not been tested and no guarantee as to their operability or efficiency can be given.
Made with floorplan 62025

BEDROOM TWO 9' 4" x 6' 3" (2.85m x 1.91m)

ATTIC ROOM 14' 1" x 10' 2" (4.3m x 3.1m)

