

Crucible

Homes



Burncross Road
Sheffield, S35 1SG

Guide Price
£600,000

Overview

Three generous bedrooms

Elegant living spaces

Character throughout

Garden/sun room

Stunning garden

No onward chain



Description

SUMMARY ACCOMMODATION Accommodation in brief comprises: spacious and grand entrance hallway, living room, dining room/second reception room, country style kitchen with Yorkshire stone flooring, rear porch/sun room. Staircase with feature stained glass window leading to spacious first floor landing, master bedroom, two further double bedrooms, family bathroom with free standing bath, walk in shower/bathroom.

Outside the property sits on a stunning private plot with mature borders providing lots of privacy, to the front is a good size lawned garden and gated access to the large driveway with parking for multiple cars also running to the side of the house and providing access to the detached garage. To the rear is a detached stone built building currently used as a garden room and with storage. Steps to the rear side of the property provide access to the basement for extra storage space. The rear garden has seating area's large lawned garden and mature borders.

The property is ideally located for commuting with the M1 motorway just a few minutes drive from the property and Chapeltown Train station within walking distance. the local amenities of Chapeltown and Burncross are also within walking distance, as are local schools. Local parkland, woodland and countryside is nearby.

LIVING ROOM 16' 5" x 11' 11" (5.01m x 3.64m)



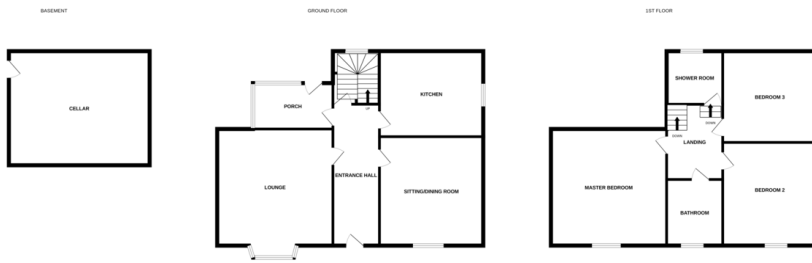

Whilst every attempt has been made to ensure the accuracy of the description contained herein, measurements of doors, windows, rooms and any other items are approximate and no responsibility is taken for any error, omission or mis-statement. This plan is for illustrative purposes only and should be used as such by any prospective purchaser. The services, systems and appliances shown have not been tested and no guarantee as to their operability or efficiency can be given.
Made with floorplan 62025

DINING ROOM 13' 6" x 11' 11" (4.12m x 3.65m)

KITCHEN 10' 9" x 10' 5" (3.3m x 3.2m)

MASTER BEDROOM 13' 9" x 12' 2" (4.2m x 3.72m)

BEDROOM TWO 12' 11" x 11' 7" (3.96m x 3.55m)

BEDROOM THREE 10' 4" x 10' 0" (3.17m x 3.06m)

FAMILY BATHROOM

SHOWER ROOM

REAR PORCH

CELLAR/BASEMENT

OUTSIDE GARDEN ROOM

