

Crucible

Homes



Millau
Sheffield, S3 8RD

Guide Price
£210,000

Overview

Kelham Island apartment

Two Bedrooms

Pets allowed

Close to City Centre

Balcony with river views

Well presented

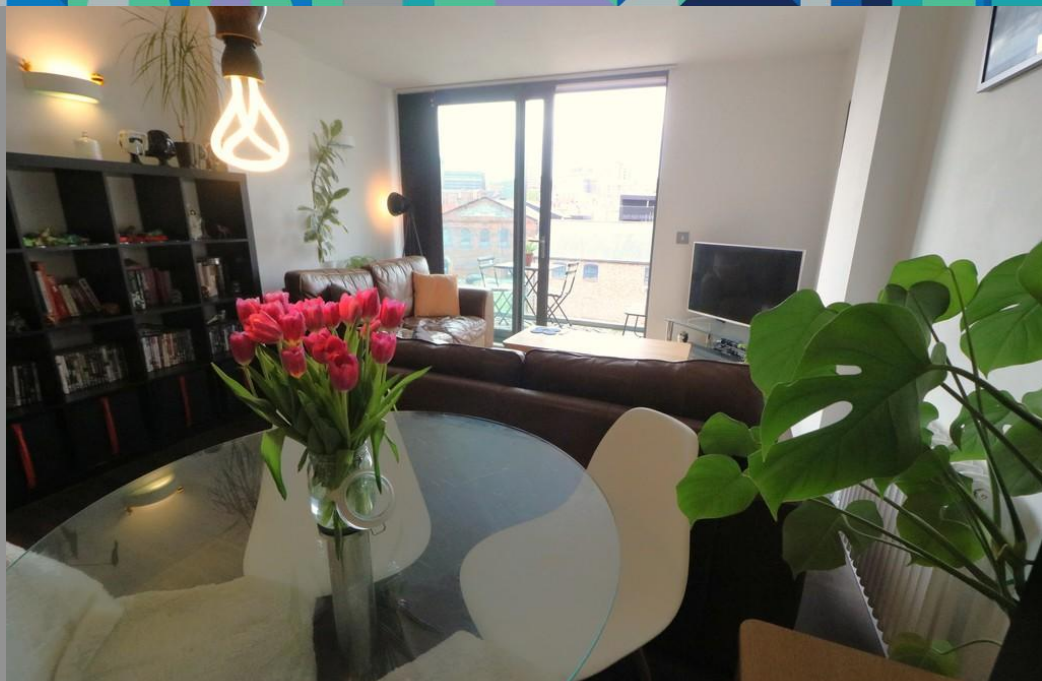

Description

SUMMARY ACCOMMODATION Accommodation in brief comprises: communal entrance, stairs and lift to apartments, private entrance hall with storage, spacious living area with open plan access to kitchen, and front facing patio doors providing access to the balcony which enjoys a south facing position, master bedroom with en suite shower room, second double bedroom, and bathroom.

The property is located in the heart of Kelham Island offering a fantastic lifestyle, and is close to transport links to Sheffield City Centre.



GROUND FLOOR

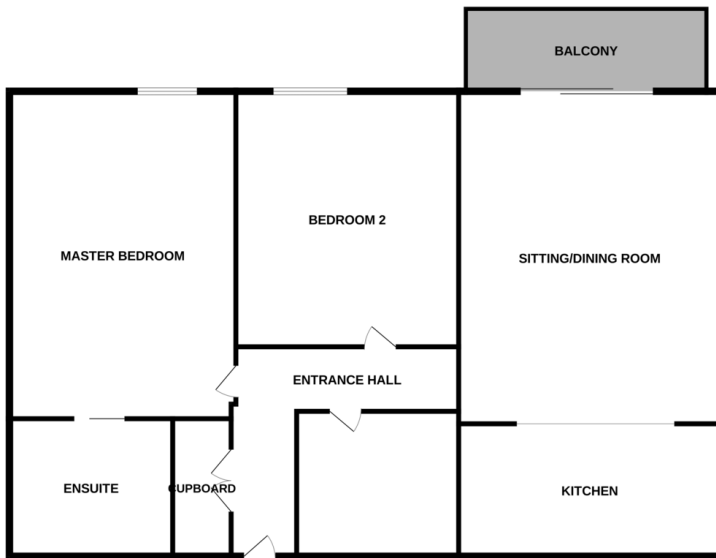

Whilst every attempt has been made to ensure the accuracy of the floorplan contained here, measurements of doors, windows, stairs and any other items are approximate and no responsibility is taken for any error, omission or mis-statement. This plan is for illustrative purposes only and should be used as such by any prospective purchaser. The services, systems and appliances shown have not been tested and no guarantee as to their operability or efficiency can be given.
Made with Metriplan ©2025

Score	Energy rating	Current	Potential
92+	A		
81-91	B		
69-80	C	71 C	72 C
55-68	D		
39-54	E		
21-38	F		
1-20	G		

PRS
Property Redress Scheme

