

Crucible Homes



Taverner Close
Sheffield, S35 4LF

Guide Price
£230,000

Overview

Three bedrooms

Close to countryside

Beautiful kitchen/conservatory

Summer house/office

Well presented

Close to schools



Description

Peaceful and perfect ... Guide Price £230,000-£240,000 ... beautifully presented and boasting an outside summer house/office and fantastic views, this three bedroom home has it all.

Accommodation in brief comprises: Entrance porch and hallway, modern lounge, breakfast kitchen with open plan access to generous conservatory, first floor landing, three bedrooms and modern bathroom.

Outside the property has a private driveway to the front and side. To the rear is a private garden with patio and lawned area's. The garden also hosts a summer house ideal for further office or working space and a separate storage shed.

Located on the edge of countryside this lovely home is also ideal for commuting with the M1 motorway just a few minutes drive from the property. Local schools and amenities are within walking distance in High Green village.



GROUND FLOOR
481 sq.ft. (44.7 sq.m.) approx.

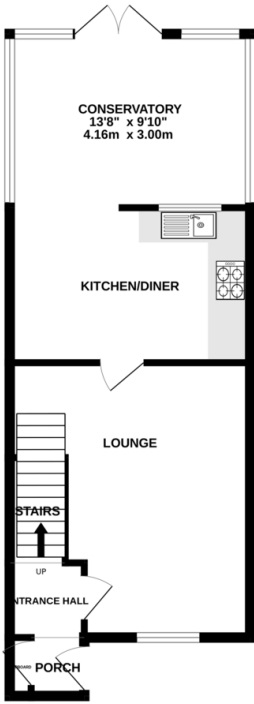

1ST FLOOR
333 sq.ft. (30.9 sq.m.) approx.

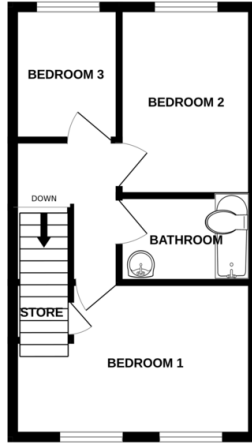

TOTAL FLOOR AREA : 814 sq.ft. (75.6 sq.m.) approx.
Whilst every attempt has been made to ensure the accuracy of the floorplan contained here, measurements of plots, buildings, rooms and any other items are approximate and no responsibility is taken for any errors, omissions or mis-statements. This plan is for illustrative purposes only and should be dated as such by any prospective purchaser. The services, systems and appliances shown have not been tested and no guarantee as to their operability or efficiency can be given.
Made with Metropix C0204

