

Crucible Homes



Sunny Bank
Sheffield, S35 4NP

Guide Price
£160,000

Overview

Three bedrooms

Modern kitchen

Open plan dining kitchen

Ground floor shower room

Front and rear garden

Close to M1



Description

SUMMARY DESCRIPTION Presenting this stunning three bedroom mid terraced home for sale in High Green.

Ideally located, the property is situated close to amenities such as local shops, public transport links and Mortomley Park, and a 10 minute drive to the M1 motorway, and 20 minute drive to Sheffield City Centre.

The accommodation briefly comprises; spacious entrance hallway, living room, modern kitchen diner with breakfast bar, utility room, modern downstairs shower room, three bedrooms and bathroom. There is also a lawned garden to the front and low maintenance back garden too.

This home would be ideal for first time buyers or a family looking to upsize, as the third bedroom would be a perfect home office or nursery. Contact the office today for a viewing.



GROUND FLOOR

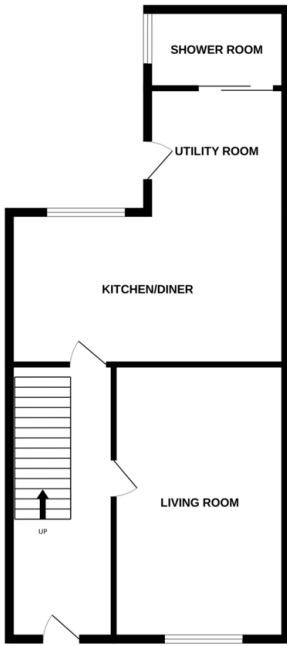

1ST FLOOR

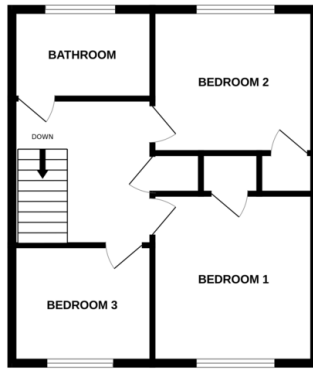

SHERINGHAM GARDENS

Whilst every attempt has been made to ensure the accuracy of the floorplan contained here, measurements of doors, windows, stairs and any other items are approximate and no responsibility is taken for any error, omission or mis-statement. This plan is for illustrative purposes only and should be used as such by any prospective purchaser. The services, systems and appliances shown have not been tested and no guarantee as to their operability or efficiency can be given.
Made with floorplan 2024.

Score	Energy rating	Current	Potential
92+	A		
81-91	B		86 B
69-80	C	73 C	
55-68	D		
39-54	E		
21-38	F		
1-20	G		

