

Crucible Homes



Dowland Avenue
Sheffield, S35 4LA

Asking Price Of
£170,000

Overview

Stunning home

Ideal first home

Close to M1

Popular location

Countryside nearby

Ready to move in to



Description

Perfect home for you ... this lovely two bedroom semi detached home is ready for you to move straight in and relax in style. With everything you need close by, including the amenities of High Green Village and the M1 motorway, this perfect home on the edge of countryside could be the one for you.

Accommodation in brief comprises: Entrance porch and hall, lounge, dining room, kitchen, two bedrooms and bathroom. Outside the property has a private driveway to the front, to the rear is a good size lawned garden and seating area.

The property is conveniently located close to the amenities and transport links of High Green village, local schools are also within walking distance. Local countryside including Westwood Country Park and Westwood Reservoir are on the doorstep.



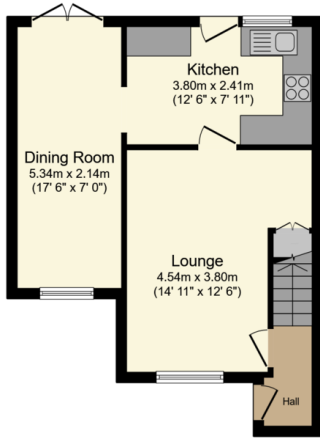

Ground Floor
Floor area 39.8 sq.m. (429 sq.ft.)

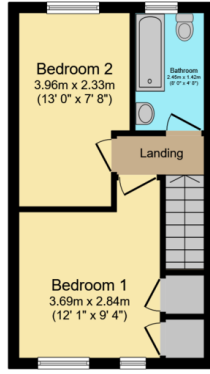

First Floor
Floor area 26.8 sq.m. (288 sq.ft.)

TOTAL: 66.6 sq.m. (717 sq.ft.)

This floor plan is for illustrative purposes only. It is not drawn to scale. Any measurements, floor areas (including any total floor area), openings and orientations are approximate. No details are guaranteed, they cannot be relied upon for any purpose and do not form any part of any agreement. No liability is taken for any error, omission or misstatement. A party must rely upon its own inspection(s). Powered by www.Propertybox.io

