

Crucible Homes

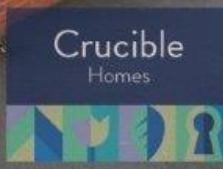

North Quadrant
Firth Park , S5 6NR

£130,000

Overview

No Chain

Three Bedrooms

Spacious Kitchen/Diner

Works and Upgrading Required

Large Enclosed Rear Garden

EPC Rating - Pending



Description

SUMMARY Crucible Homes welcome this THREE bedroom END TERRACE property selling with NO CHAIN.

A property perfect for FIRST TIME buyers or growing FAMILY, which can be made into a home and put your own stamp on all of the rooms. Property benefits from having gas central heating and UPVC windows and doors.

The layout comprises of; entrance hall with stairs leading to the first floor, through to the spacious living room leading to the well proportioned kitchen/diner.

To the first floor are three good sized bedrooms and shower room.

Externally to the rear is a large enclosed mainly laid to lawn garden which would be great in the summer evenings, along with brick built storage area.

This property is ideally situated in good distance to local amenities including shops, medical center, library and eateries. Also in good distance to motorway links, surround cities and Meadowhall shopping center.

A property that must be viewed!!



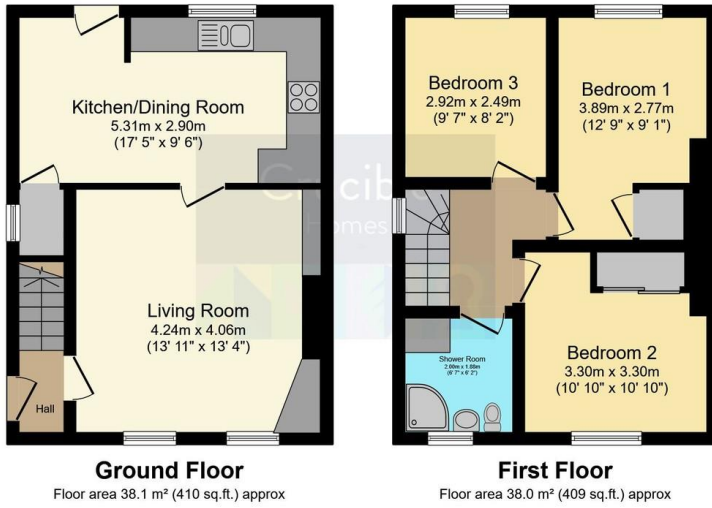

Total floor area 76.1 m² (819 sq.ft.) approx

This plan is for illustration purposes only and may not be representative of the property. Plan not to scale. Powered by PropertyBox

AGENCY NOTE Council Tax Band - A
EPC Rating - Pending
End Of Terrace
Construction Type - Brick

