

Crucible Homes



Linden Road
Ecclesfield, S35 9XL

£135,000

Overview

No Chain

Two Bedrooms

Downstairs Bathroom

Breakfasting Kitchen

Well Presented Throughout

EPC Rating - C



Description

SUMMARY Selling with NO CHAIN is this TWO bedroom MID TERRACE property located in the popular area of Ecclesfield.

The property is ideal for anyone wanting to get onto the property ladder or for investment.

The layout of the property consist of; lounge, breakfasting kitchen and bathroom fitted in a white suite having bath with shower over, WC and wash hand basin. To the first floor are two well proportioned bedrooms.

Externally there is a rear enclosed paved yard area with access to the front, along with on street parking.

Property is ideally situated close to local amenities including shops, major supermarkets, social clubs and places of worship.

Call Crucible Homes to arrange a viewing.

AGENCY NOTE EPC Rating - C

Council Tax Band - A



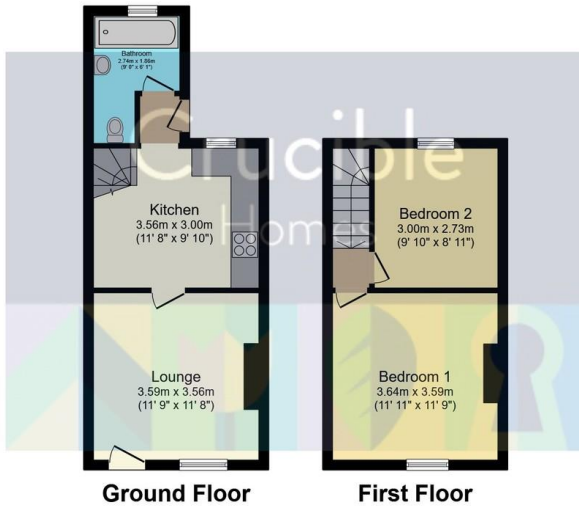

Score	Energy rating	Current	Potential
92+	A		
81-91	B		88 B
69-80	C	70 C	
55-68	D		
39-54	E		
21-38	F		
1-20	G		

Total floor area 52.9 m² (570 sq.ft.) approx

This plan is for illustration purposes only and may not be representative of the property. Plan not to scale. Powered by PropertyBox

