

R

www.robertsproperty.co.uk

Roberts

Sales, Lettings & Block Management

SECOND FLOOR FLAT

£165,000



Carlton Mount, 2 Cranborne Road, Bournemouth, BH2 5BR

- **Second Floor Lift Served Flat**
- **54.9 Square Metres**
- **One Double Bedroom**
- **19ft6 x 11ft9 Lounge**
- **14ft3 x 7ft10 Kitchen**
- **One Parking Bay Conveyed**
- **Distant Sea Views**

- **Share in Freehold**
- **992-Year Lease**
- **Maintenance £2092pa**
- **Ground Rent Nil**
- **EPC C-Rating**
- **Council Tax Band B**
- **Chain Free & Vacant**

158 Charminster Road, Bournemouth, Dorset, BH8 8UU Tel: 01202 565758 Fax: 01202 530955

Please note that the services within this property were not tested, also please note all room sizes are approximate measurements and into recesses and bay windows where appropriate.

Carlton Mount, 2 Cranborne Road, Bournemouth, BH2 5BR

Communal entrance leading to stairs, lift & landings, the flat lies on the second floor.

- Entrance Hallway:** An L-shaped room. Having papered ceiling with ceiling light point, mains wired smoke detector and entry phone receiver. UPVC double-glazed window to side aspect. Cupboard housing pre-lagged hot water cylinder.
- Lounge:** **19' 6 x 11' 9 / 5.95m x 3.59m (approx')**. Papered ceiling, ceiling light point and picture rail. UPVC double-glazed bay window to front aspect. Night storage heater and cupboard housing electrics.
- Kitchen / Diner:** **14' 3 x 7' 10 / 4.34m x 2.38m (approx')**. Having papered ceiling with ceiling light point and UPVC double-glazed window to side aspect. Fitted extractor fan. A range of wall and base mounted units with work surfaces over. One-and-a-quarter bowl single drainer sink unit with mixer tap. Integrated electric oven with electric hob and cooker hood over. Space for fridge / freezer, space and plumbing for washing machine and space and plumbing for dishwasher. Splash back tiling.
- Bedroom:** **11' 10 x 11' 10 / 3.62m x 3.61m (approx')**. Papered ceiling, ceiling light point & UPVC double-glazed window to front aspect with distant sea views. Night storage heater point.
- Bathroom:** **7' 6 x 5' 1 / 2.29m x 1.55m (approx')**. Papered ceiling, ceiling light point & UPVC double-glazed frosted window to side aspect. Panelled bath with shower mixer tap, electric shower over and fitted shower screen. Pedestal wash hand basin with mixer tap and low-level WC. Ladder style electrically heated towel rail and splash back tiling.
- Outside:** The property sits in communal grounds with one allocated parking space situated to the front of the property.
- Tenure:** Leasehold with a share in the freehold: 992-years remaining
Maintenance: £2,092.19 per annum **Ground Rent:** £Nil
Council Tax: Band B



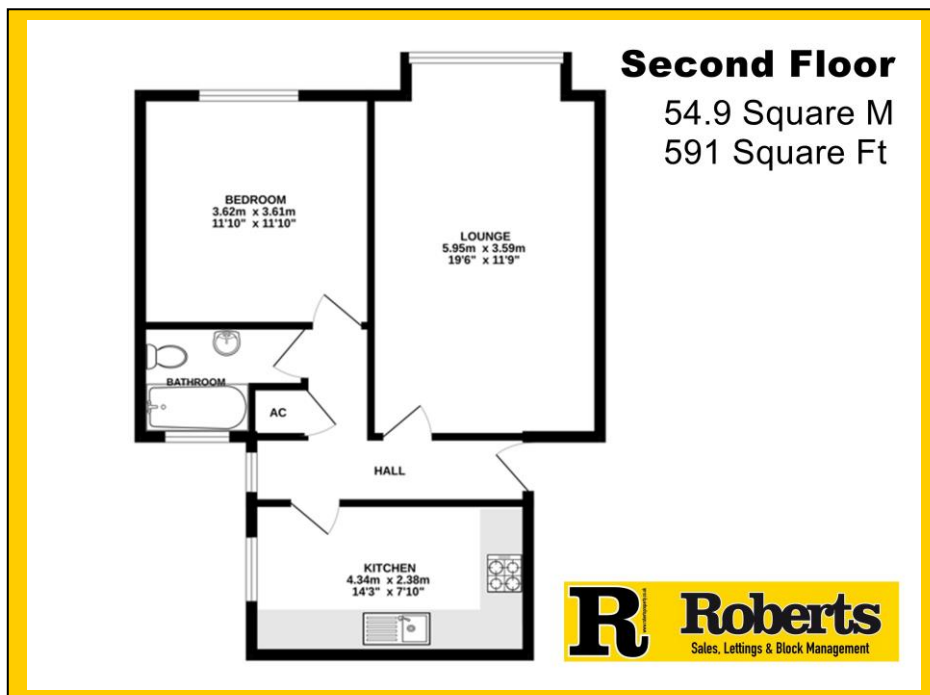

Score	Energy rating	Current	Potential
92+	A		
81-91	B		
69-80	C	70 C	79 C
55-68	D		
39-54	E		
21-38	F		
1-20	G		

