

for sale

offers in the region of **£80,000** Leasehold



Warren Close Tipton DY4 9PG

Purpose Built First Floor Flat offering Very Spacious Accommodation with the benefit of gas central heating and Upvc Double Glazing. Great Location close to amenities

- Energy Rating: C
- Purpose built First Floor Flat
- Gas Central Heating + Upvc Double Glazing
- Immaculate Spacious Accommodation + viewing recommended

Property Details

Reception Hall

stairs off to first floor

First Floor Landing

upvc double glazed window, store cupboard, loft hatch

Lounge 16' 6" x 12' 1" (5.03m x 3.68m)

upvc double glazed window, central heating radiator

Fitted Kitchen

sink unit, fitted base and drawer cupboards, roll top working surfaces, built in oven with hob, extractor hood, appliance space, wall cupboards, upvc double glazed window.

Bedroom One 13' 7" x 8' 9" (4.14m x 2.67m)

upvc double glazed window, central heating radiator, range of superbly fitted wardrobes.

Bedroom Two 9' 2" x 7' 8" (2.79m x 2.34m)

upvc double glazed window, central heating radiator, fitted wardrobes

Bathroom 6' 7" x 5' 9" (2.01m x 1.75m)

panelled bath, wash hand basin, low level w.c. upvc double glazed window

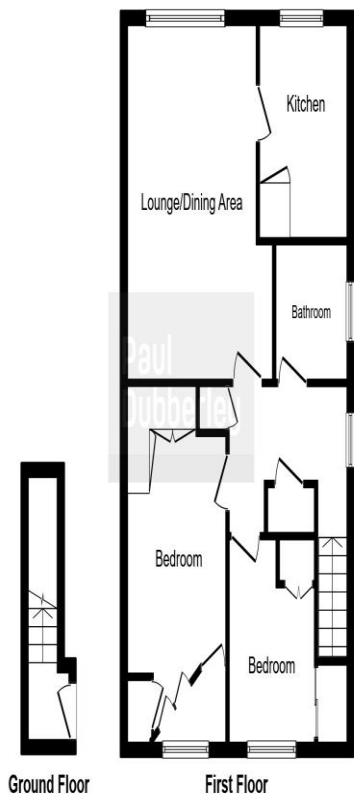

To view this property please contact Paul Dubberley on

T 0121 522 3733
E greatbridge@pauldubberley.co.uk

73 Great Bridge
TIPTON DY4 7HF

Tenure: Leasehold

EPC Rating: C

Property Ref: PT1100810 - 0005

Lease details are currently being compiled. For further information please contact the branch. Please note additional fees could be incurred for items such as leasehold packs.

This plan is for illustration purposes only and may not be representative of the property. Plan not to scale.

Powered by [audioagent.com](https://www.audioagent.com)

1. MONEY LAUNDERING REGULATIONS Intending purchasers will be asked to produce identification documentation at a later stage and we would ask for your co-operation in order that there will be no delay in agreeing the sale. 2. These particulars do not constitute part or all of an offer or contract. 3. The measurements indicated are supplied for guidance only and as such must be considered incorrect. Potential buyers are advised to recheck measurements before committing to any expense. 4. We have not tested any apparatus, equipment, fixtures, fittings or services and it is in the buyers interest to check the working condition of any appliances.

see all our properties at www.pauldubberley.co.uk | www.rightmove.co.uk | www.zoopla.co.uk