

for sale

from **£115,000** Leasehold



## Creed Way West Bromwich B70 9JT

The property comprises of communal entrance with a secure intercom system for each apartment. The Apartment Offers two double bedrooms, lounge, kitchen and allocated parking space. Direct transport links to Birmingham Grand Central Station and Wolverhampton via West Midlands metro,

# Creed Way West Bromwich B70 9JT

## Entrance

Having an intercom entry system, further door to the flat storage cupboard and doors to.

## Lounge

17' 8" x 12' ( 5.38m x 3.66m )

Having two double glazed windows to the rear elevation and central heating radiator.

## Kitchen

7' 10" x 7' 1" ( 2.39m x 2.16m )

Having a double glazed window to the front elevation, fitted kitchen with a range of wall and base units, with worksurfaces over, sink and drainer, tiling to splash prone areas, integrated electric oven and hob, with cooker hood over, fridge freezer, plumbing for appliances, central heating boiler and central heating radiator.

## Bedroom One

13' 7" x 10' 7" ( 4.14m x 3.23m )

Having a double glazed window to the front elevation and central heating radiator.

## Bedroom Two

13' 7" x 11' 6" ( 4.14m x 3.51m )

Having a double glazed window to the front elevation and central heating radiator.

## Bathroom

Part tiled, having bath with shower over, low level WC, wash hand basin, extractor fan and central heating radiator.









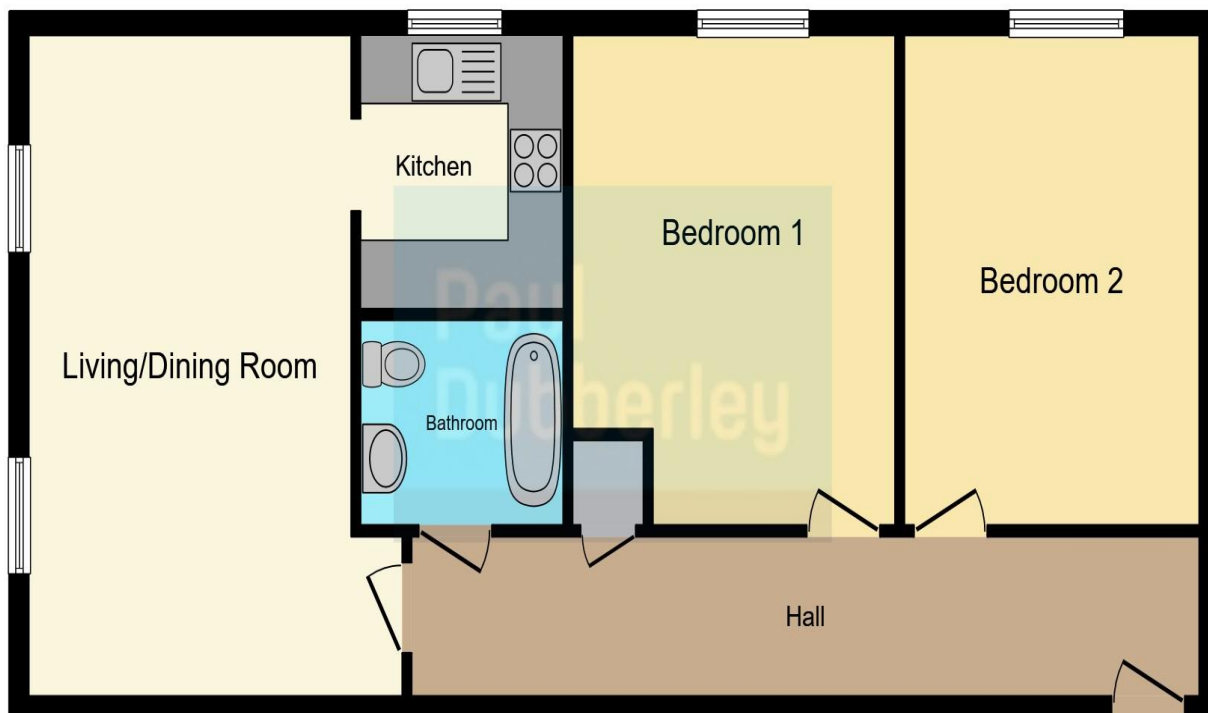

This floorplan is for illustrative purposes only and is not drawn to scale. Measurements, floor-areas, openings and orientations are approximate. They should not be relied upon for any purpose and do not form any part of an agreement. No liability is taken for any error or mis-statement. All parties must rely on their own inspections.

To view this property please contact Paul Dubberley on

**T** 0121 525 2111  
**E** [westbrom@pauldubberley.co.uk](mailto:westbrom@pauldubberley.co.uk)

290 - 292 High Street  
WEST BROMWICH B70 8EN

Property Ref: PWB102644 - 0004

**Tenure:** Leasehold

**EPC Rating:** B C / T Band B

**view this property online** [PaulDubberley.co.uk/Property/PWB102644](http://PaulDubberley.co.uk/Property/PWB102644)

This is a Leasehold property with details as follows; Term of Lease 150 years from 01 Sep 2006. Should you require further information please contact the branch. Please Note additional fees could be incurred for items such as Leasehold packs.

1. MONEY LAUNDERING REGULATIONS Intending purchasers will be asked to produce identification documentation at a later stage and we would ask for your co-operation in order that there will be no delay in agreeing the sale. 2. These particulars do not constitute part or all of an offer or contract. 3. The measurements indicated are supplied for guidance only and as such must be considered incorrect. Potential buyers are advised to recheck measurements before committing to any expense. 4. We have not tested any apparatus, equipment, fixtures, fittings or services and it is in the buyers interest to check the working condition of any appliances.

Paul Dubberley is a trading name of Connells Residential which is registered in England and Wales under company number 1489613, Registered Office is Cumbria House, 16-20 Hockliffe Street, Leighton Buzzard, Bedfordshire, LU7 1GN. VAT Registration Number is 500 2481 05.

see all our properties at [www.pauldubberley.co.uk](http://www.pauldubberley.co.uk) | [www.rightmove.co.uk](http://www.rightmove.co.uk) | [www.zoopla.co.uk](http://www.zoopla.co.uk)