

for sale

offers in the region of **£280,000** Freehold



## Slater Street Wednesbury WS10 8EE

**\*\*BEAUTIFULLY PRESENTED THREE BEDROOM DETACHED PROPERTY\*\* NO CHAIN!** Located in a popular area of Wednesbury (Darlaston). Close to local shops and amenities. We recommend internal viewings to appreciate the accommodation we have to offer.



# Property Details

## Entrance Porch

Front aspect double glazed window, radiator and laminate flooring.

## Entrance Hall

Radiator and laminate flooring.

## Lounge 12' 3" x 14' 7" ( 3.73m x 4.45m )

Front aspect double glazed window, x 2 radiators, laminate flooring and fireplace.

## Dining Room 9' 9" x 13' 1" ( 2.97m x 3.99m )

Rear aspect double glazed window, rear aspect patio doors to conservatory and laminate flooring.

## Kitchen 8' 3" x 13' 1" ( 2.51m x 3.99m )

Rear and side aspect double glazed window, laminate flooring, wall and base units.

## Downstairs W/C

W/C

## Conservatory 9' 8" x 13' 2" ( 2.95m x 4.01m )

Dual aspect double glazed windows, tiled flooring and doors to garden.

## Landing

Side aspect double glazed windows and doors to bedrooms.

## Bedroom One 11' 9" x 13' 1" ( 3.58m x 3.99m )

Front aspect double glazed window, radiator and laminated floor.

## Bedroom Two 10' 4" x 13' 1" ( 3.15m x 3.99m )

Rear aspect double glazed window, radiator and built in wardrobes.

## Bedroom Three 8' 2" x 7' 8" ( 2.49m x 2.34m )

Rear aspect double glazed window.

## Family Bathroom

Front aspect double glazed window, fully tiled, sink and wash hand basin, w/c and walk in shower.

## Front Garden

Large driveway and shrub borders.

## Rear Garden

Patio and lawn area.

## Garage





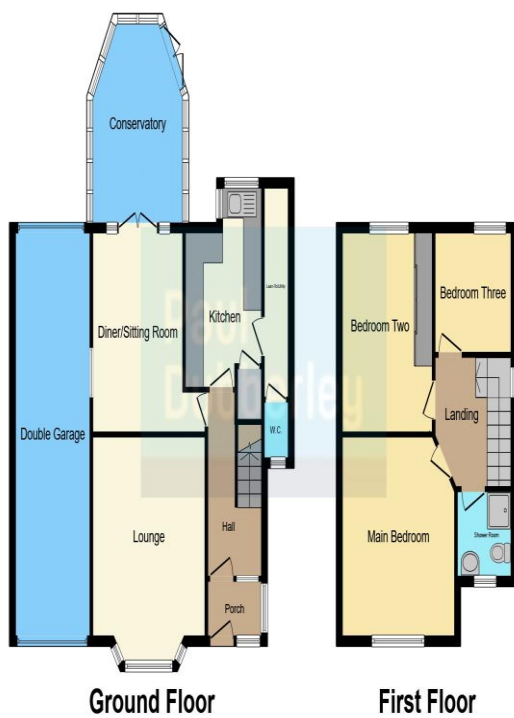

To view this property please contact Paul Dubberley on

**T 0121 505 3533**  
**E [wednesbury@pauldubberley.co.uk](mailto:wednesbury@pauldubberley.co.uk)**

97 Walsall Street  
 WEDNESBURY WS10 9BY

Property Ref: PWE103880 - 0003

Tenure: Freehold EPC Rating: E

Council Tax Band: C

This floor plan is for illustrative purposes only. It is not drawn to scale. Any measurements, floor areas (including any total floor area), openings and orientation are approximate. No details are guaranteed, they cannot be relied upon for any purpose and they do not form part of any agreement. No liability is taken for any error, omission or misstatement. A party must rely upon its own inspection(s). Powered by [www.focalagent.com](http://www.focalagent.com)

1. MONEY LAUNDERING REGULATIONS Intending purchasers will be asked to produce identification documentation at a later stage and we would ask for your co-operation in order that there will be no delay in agreeing the sale. 2. These particulars do not constitute part or all of an offer or contract. 3. The measurements indicated are supplied for guidance only and as such must be considered incorrect. Potential buyers are advised to recheck measurements before committing to any expense. 4. We have not tested any apparatus, equipment, fixtures, fittings or services and it is in the buyers interest to check the working condition of any appliances.

Paul Dubberley is a trading name of Connells Residential which is registered in England and Wales under company number 1489613, Registered Office is Cumbria House, 16-20 Hockliffe Street, Leighton Buzzard, Bedfordshire, LU7 1GN. VAT Registration Number is 500 2481 05.

see all our properties at [www.pauldubberley.co.uk](http://www.pauldubberley.co.uk) | [www.rightmove.co.uk](http://www.rightmove.co.uk) | [www.zoopla.co.uk](http://www.zoopla.co.uk)