

for sale

offers over **£90,000** Leasehold



Brookside Wednesbury WS10 0QF

****TWO BEDROOM GROUND FLOOR FLAT**** Located in Wednesbury and close to local transport links, shops and amenities. Ideal for a first time buyer. We would recommend internal viewings on this property.



Property Details

Entrance Hall

With side door, storage heater and storage cupboard.

Lounge 14' 10" x 11' 9" (4.52m x 3.58m)

Front aspect double glazed window and storage heater.

Kitchen 6' 1" x 9' 8" (1.85m x 2.95m)

Fitted kitchen, wall and base units, sink and drainer, electric oven, electric hob, cook hood, space for washing machine and fridge freezer.

Bedroom One 10' 9" x 10' 3" (3.28m x 3.12m)

Front aspect double glazed window and storage heater.

Bedroom Two 10' 1" x 6' 11" into recess (3.07m x 2.11m into recess)

Rear aspect double glazed window, electric radiator and storage cupboard.

Bathroom

Rear aspect double glazed window, heated towel rail, bath with shower over, wash hand basin and extractor fan.

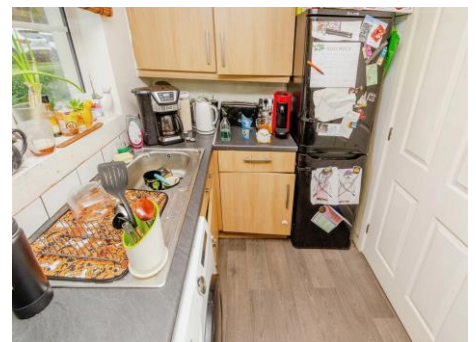

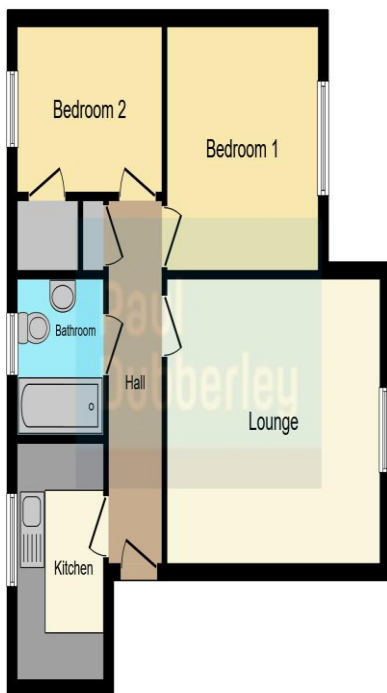

This floor plan is for illustrative purposes only. It is not drawn to scale. Any measurements, floor areas (including any total floor area), openings and orientation are approximate. No details are guaranteed, they cannot be relied upon for any purpose and they do not form part of any agreement. No liability is taken for any error, omission or misstatement. A party must rely upon its own inspection(s). Powered by www.focalagent.com

1. MONEY LAUNDERING REGULATIONS Intending purchasers will be asked to produce identification documentation at a later stage and we would ask for your cooperation in order that there will be no delay in agreeing the sale. 2. These particulars do not constitute part or all of an offer or contract. 3. The measurements indicated are supplied for guidance only and as such must be considered incorrect. Potential buyers are advised to recheck measurements before committing to any expense. 4. We have not tested any apparatus, equipment, fixtures, fittings or services and it is in the buyers interest to check the working condition of any appliances.

Paul Dubberley is a trading name of Connells Residential which is registered in England and Wales under company number 1489613, Registered Office is Cumbria House, 16-20 Hockliffe Street, Leighton Buzzard, Bedfordshire, LU7 1GN. VAT Registration Number is 500 2481 05.

To view this property please contact Paul Dubberley on

T 0121 505 3533
E wednesbury@pauldubberley.co.uk

97 Walsall Street
 WEDNESBURY WS10 9BY

Tenure: Leasehold

EPC Rating: D

Property Ref: PWE103560 - 0006

This is a Leasehold property with details as follows; Term of Lease 155 years from 01 Jun 2007. Should you require further information please contact the branch. Please Note additional costs could be incurred for items such as Council Tax, etc.

see all our properties at www.pauldubberley.co.uk | www.rightmove.co.uk | www.zoopla.co.uk