



*** NO FORWARD CHAIN * TWO GOOD SIZED BEDROOMS ***

*** LARGE REAR GARDEN * SHORT WALK TO LOCAL SHOPS ***

*** OFF ROAD PARKING TO FRONT ***

*** SUN LOUNGE/CONSERVATORY * SPACIOUS RECEPTION ROOM ***



**42 Ambleside Road
Bexleyheath, DA7 5DS**

**Guide Price £425,000 -
£450,000**

Village Estates are pleased to present this spacious TWO BEDROOM, SEMI DETACHED bungalow situated in a popular road within a short walk to local schools, shops and transport links. With off road parking and a good sized garden are offered to the market with the benefit of NO FORWARD CHAIN. Internal viewing comes highly recommended...



EPC RATING E
COUNCIL TAX BAND D

GROUND FLOOR
699 sq.ft. (65.0 sq.m.) approx.

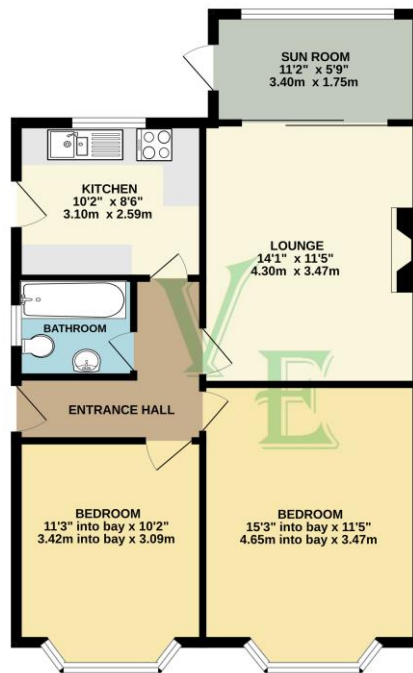

TOTAL FLOOR AREA: 699 sq.ft. (65.0 sq.m.) approx.
Whilst every attempt has been made to ensure the accuracy of the floorplan contained herein, measurements of doors, windows, rooms and any other items are approximate and no responsibility is taken for any errors, omissions or mis-statements. This plan is for illustrative purposes only and should be used as such by any prospective purchaser. The services, systems and appliances shown have not been tested and no guarantee as to their quantity or efficiency can be given.
Made with floorplan 12025

We understand this property is Freehold.

VIEWING:

Via **Village Estates** on 01322 522111
Monday to Friday 9am-6pm, Saturday 9am-5pm

SELLING YOUR HOME?

If you are thinking of selling your own property, **VILLAGE ESTATES** will be pleased to provide you with a free market appraisal for sale purposes and professional marketing advice **FREE OF CHARGE, WITHOUT OBLIGATION**. Call one of our experienced sales staff on 01322 522111.

Whilst we endeavour to make our sales details reliable and accurate they should not be relied on as representations or statements of fact, and do not form any part of an offer or contract. The Seller does not make or give nor do we or our employees have authority to make or give any representation or warranty in relation to the property. We would strongly recommend that all the information which we provide about the property is verified by yourself on inspection and also by your conveyancer, especially where statements have been made by us to the effect that the information provided has not been verified. If there are any other points which are of particular importance to you, we would be only too happy to check the information and indeed confirm the availability of the property. Please contact the above office to arrange a convenient viewing appointment.