



## 6 Elm Close, Bracklesham Bay

Guide Price £600,000



Henry Adams  
estate agents

## 6 Elm Close

Bracklesham Bay, Chichester

Presenting a rare opportunity to acquire a lovely two-bedroom detached bungalow, this property is nestled perfectly within reach of the beach. The interior comprises, kitchen/breakfast room, accompanied by a welcoming sitting room that benefits from doors onto the garden.

Greeting you outdoors is an attractive large south-facing rear garden, creating a peaceful retreat within the confines of your own property. Added conveniences include a garage and off-road parking for hassle-free arrivals. Furthermore, a large loft space holds immense potential, with planning permission obtainable for a planned extension (REF: 21/02425/DOM).

Council Tax band: D

Tenure: Freehold

EPC Energy Efficiency Rating: D

EPC Environmental Impact Rating: E

- TWO BEDROOM DETACHED BUNGALOW
- SPACIOUS KITCHEN
- SITTING/DINING ROOM
- CLOAKROOM & SHOWER ROOM
- ATTRACTIVE LARGE SOUTH-FACING REAR GARDEN
- GARAGE & OFF-ROAD PARKING
- LARGE LOFT WITH PLANNING PERMISSION TO EXTEND (REF: 21/02425/DOM)
- WALKING DISTANCE OF THE BEACH







# Elm Close, PO20 8HY

Approximate Gross Internal Area = 86.9 sq m / 935 sq ft

Garage = 12.0 sq m / 129 sq ft

Total = 98.9 sq m / 1064 sq ft

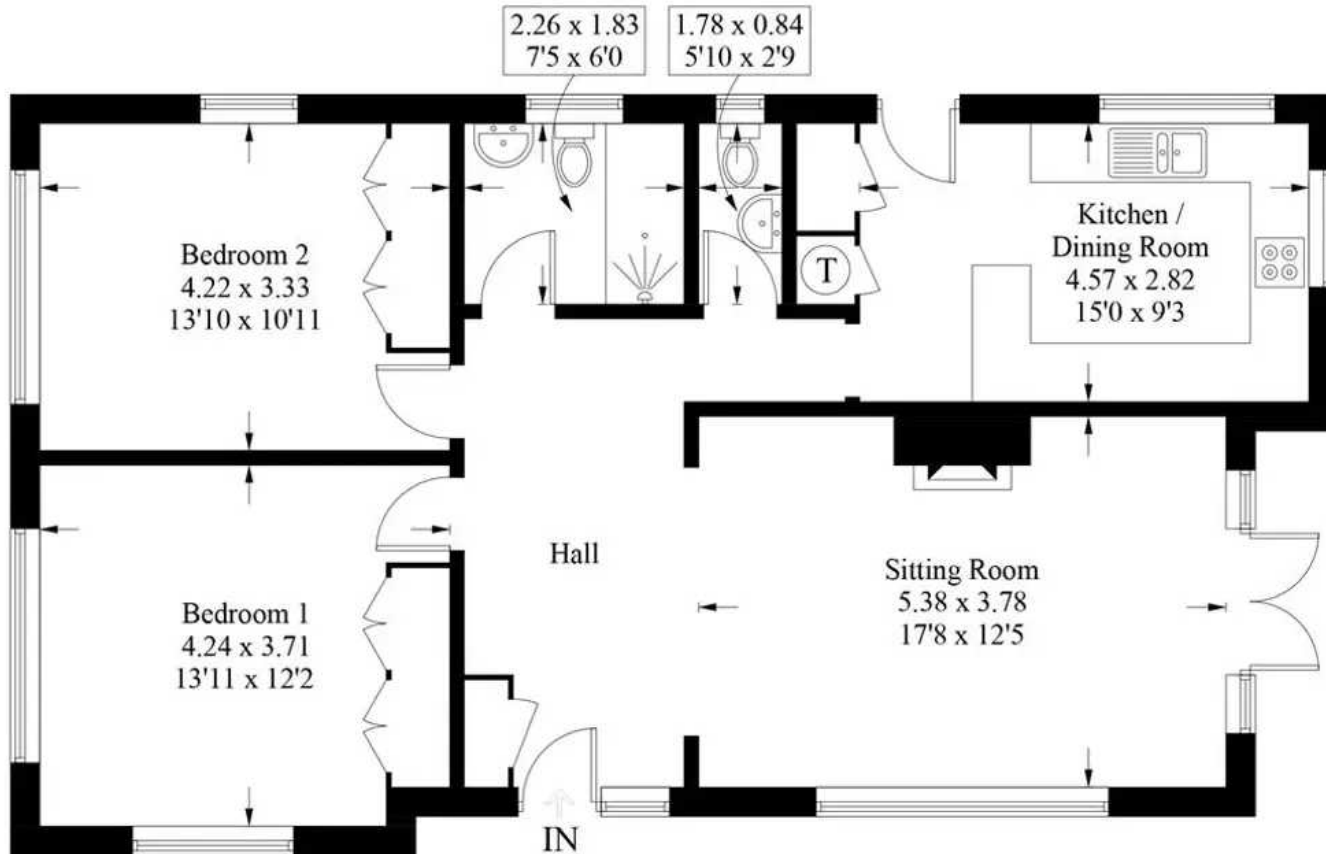

**Ground Floor**

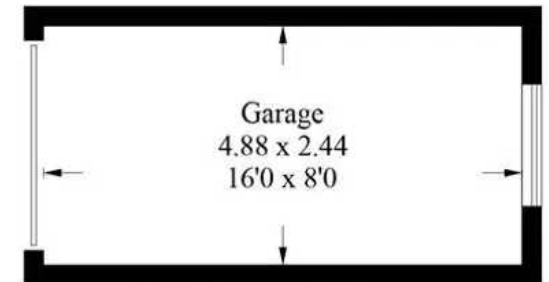

(Not Shown In Actual Location / Orientation)

These plans are for illustration purposes only as defined by RICS - Code of Measuring Practice.  
Not to scale. Created by Emzo Marketing



## Henry Adams – East Wittering

Henry Adams LLP, 14 Shore Road, East Wittering – PO20 8DZ

01243 672721

[eastwittering@henryadams.co.uk](mailto:eastwittering@henryadams.co.uk)

[www.henryadams.co.uk/](http://www.henryadams.co.uk/)

Agents Note – Our particulars are for guidance only and are intended to give a fair overall summary of the property. They do not form part of any contract or offer, and should not be relied upon as a statement or representation of fact. Measurements, areas and distances are approximate only. Photographs may include lifestyle shots and pictures of local views. No undertaking is given as to the structural condition of the property, or any necessary consents or the operating ability or efficiency of any service, system or appliance. Please ask if you would like further information, especially before you travel to the property.