



2 Pegasus Court Deanery Close, Chichester

Guide Price £250,000

2 Pegasus Court Deanery Close

Chichester, Chichester

Two bedroom retirement property, located in a highly sought-after area within walking distance of Chichester City Centre. This spacious apartment boasts a comfortable living space, with direct access to a private garden providing a tranquil retreat.

Residents of this esteemed development benefit from access to delightful communal gardens, perfect for leisurely strolls and outdoor relaxation. Further enhancing the lifestyle on offer, there is a dedicated residents lounge for social gatherings and events, as well as convenient laundry facilities for added practicality.

With its prime location and abundance of amenities, including easy access to shops, restaurants, and cultural attractions, this retirement property offers a harmonious blend of comfort, convenience, and community spirit.

Council Tax band: D

Tenure: Leasehold

EPC Energy Efficiency Rating: C

- Direct access to a private garden
- Within walking distance of Chichester City Centre
- Communal Gardens
- Residents Lounge
- Laundry Facilities
- Two bedroom Ground floor retirement apartment



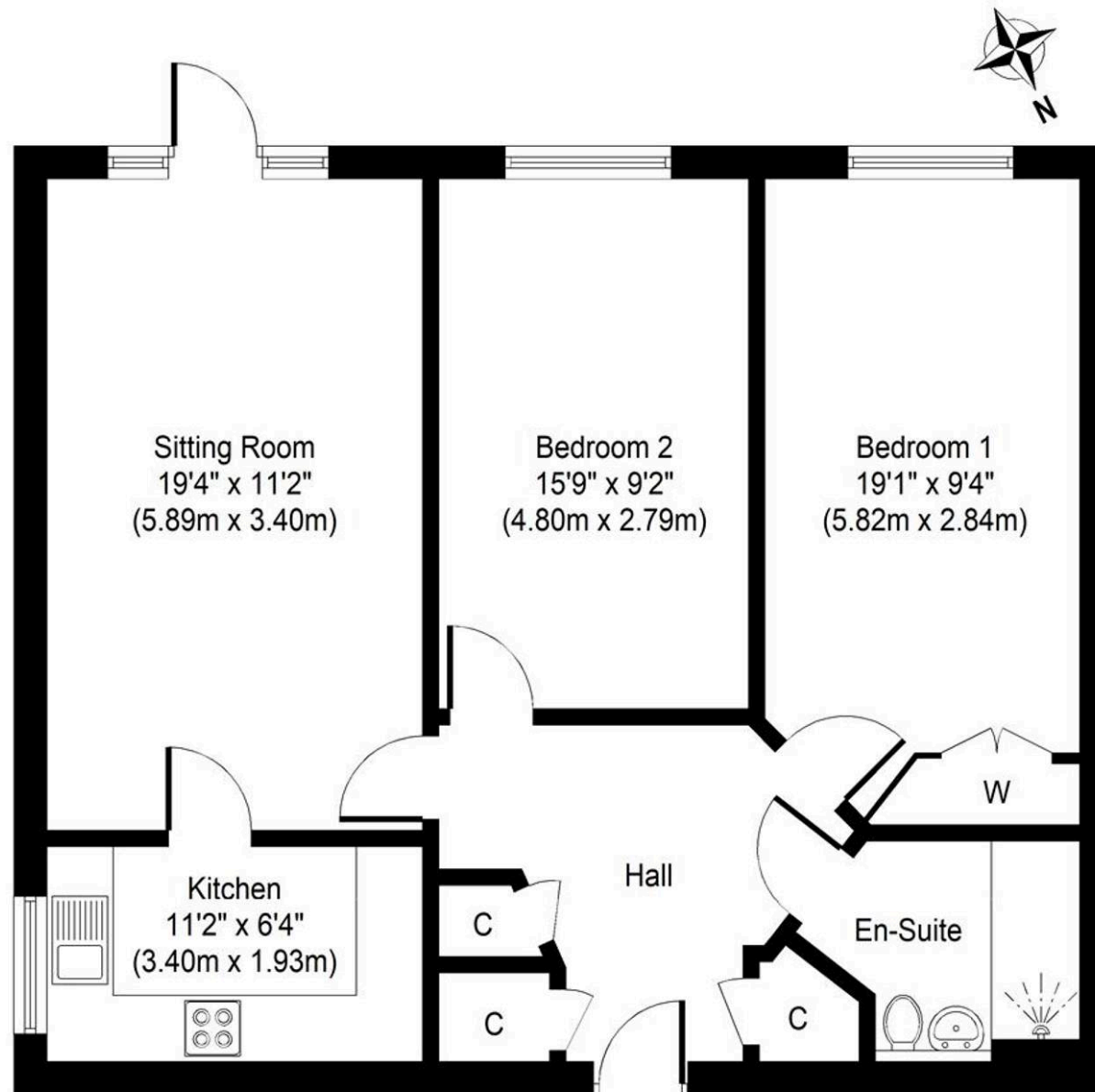

Ground Floor
Approximate Floor Area
801 Sq. ft.
(74.0 Sq. m.)

Whilst every attempt has been made to ensure the accuracy of the floor plan contained here, measurements of doors, windows, rooms and any other items are approximate and no responsibility is taken for any error, omission, or mis-statement. This plan is for illustrative purposes only and should be used as such by any prospective purchaser or tenant. The services, systems and appliances shown have not been tested and no guarantee as to their operability or efficiency can be given.

Copyright V360 Ltd 2021 | www.houseviz.com



Henry Adams - Chichester

Henry Adams LLP, Rowan House Baffins Lane - PO19 1UA

01243 533377

chichester@henryadams.co.uk

www.henryadams.co.uk/

Agents Note - Our particulars are for guidance only and are intended to give a fair overall summary of the property. They do not form part of any contract or offer, and should not be relied upon as a statement or representation of fact. Measurements, areas and distances are approximate only. Photographs may include lifestyle shots and pictures of local views. No undertaking is given as to the structural condition of the property, or any necessary consents or the operating ability or efficiency of any service, system or appliance. Please ask if you would like further information, especially before you travel to the property.