



Connells

Meredith Drive
Aylesbury



Property Description

Connells are delighted to bring to the market this excellent two-bedroom end-of-terrace Cluster home located on a popular residential road in Haydon Hill, Aylesbury. The property comprises of a sizeable reception room, a fitted kitchen, two bedrooms and a family bathroom. The property also benefits from driveway parking and a large front garden with a workshop and a shed.

Ideal for first time buyers, the property is located with access to several transport links including the new Aylesbury Parkway railway station linking with London Marylebone as well as the A41. There are a variety of nurseries, primary schools and secondary schools within catchments including Aylesbury Vale Academy and Aylesbury Grammar Schools.

Viewing comes highly recommended.

Entrance Porch

Door to front aspect, space for coats and shoes, a further door leads into the living room.

Living Room

Irregular Shaped Room 11' x 14' 7" (3.35m x 4.45m)

Window to the front and side aspect, wood effect flooring, light fitting to ceiling, radiators, spiral stairs to the first floor landing.

Kitchen

7' 2" x 7' 1" (2.18m x 2.16m)

Fitted kitchen comprising of wall and base units with work surfaces to complement, window to front aspect, inset stainless steel sink unit with mixer tap, wall mounted boiler, space for a free standing cooker, washing machine and fridge/freezer.

First Floor Landing

Stairs from living room, window to side aspect, airing cupboard.

Bedroom One

10' 8" x 9' 9" (3.25m x 2.97m)

Window to the front aspect, carpet laid to floor, light fitting to ceiling, radiator.

Bedroom Two

7' 5" x 7' 1" (2.26m x 2.16m)

Window to the front aspect, carpet laid to floor, light fitting to ceiling, radiator

Bathroom

Low level wc, hand wash basin, panelled bathtub with overhead shower and screen, heated towel rail and extractor fan.

Outside

Parking

Off road parking.

Front Garden

Paved pathway leading to the front door with graveled frontage, grass area with garden shed & workshop.







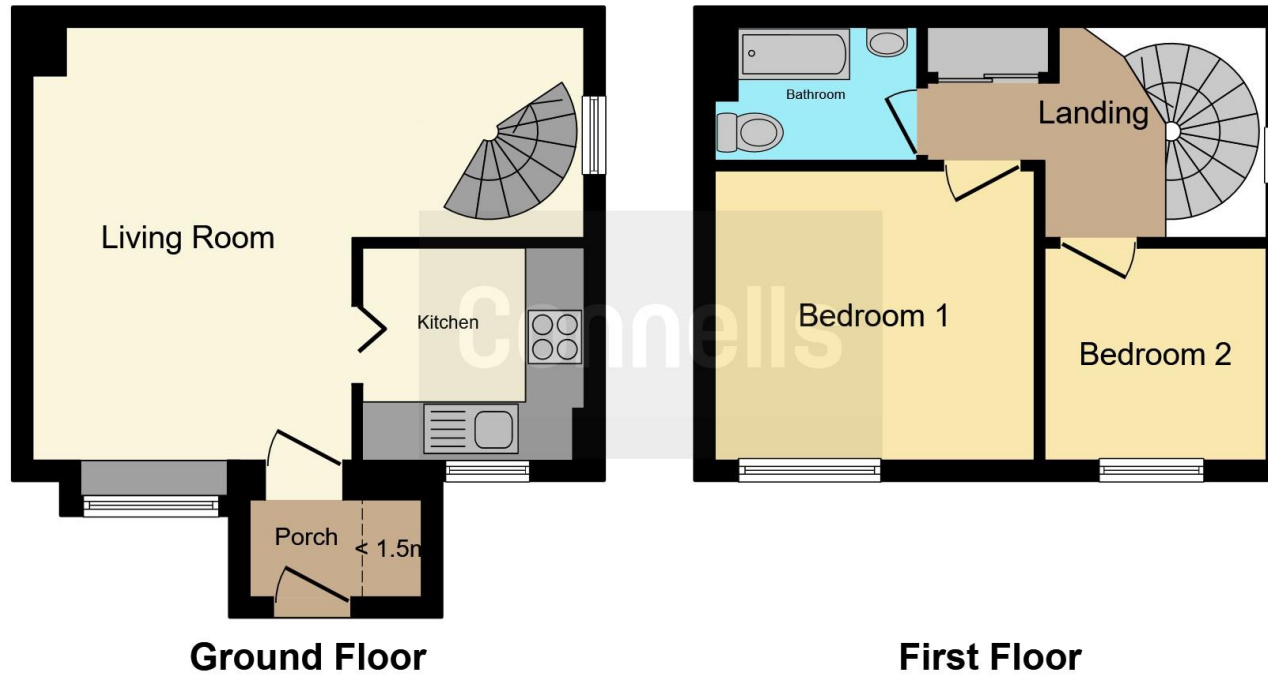

This floor plan is for illustrative purposes only. It is not drawn to scale. Any measurements, floor areas (including any total floor area), openings and orientation are approximate. No details are guaranteed, they cannot be relied upon for any purpose and they do not form part of any agreement. No liability is taken for any error, omission or misstatement. A party must rely upon its own inspection(s). Powered by www.focalagent.com

To view this property please contact Connells on

T 01296 395710
E fairfordleys@connells.co.uk

6 Hampden Square
 AYLESBURY HP19 7HT

EPC Rating: C

Tenure: Freehold

view this property online connells.co.uk/Property/LEY304122



1. MONEY LAUNDERING REGULATIONS Intending purchasers will be asked to produce identification documentation at a later stage and we would ask for your co-operation in order that there will be no delay in agreeing the sale. 2. These particulars do not constitute part or all of an offer or contract. 3. The measurements indicated are supplied for guidance only and as such must be considered incorrect. Potential buyers are advised to recheck measurements before committing to any expense. 4. We have not tested any apparatus, equipment, fixtures, fittings or services and it is in the buyers interest to check the working condition of any appliances.

Connells Residential is registered in England and Wales under company number 1489613, Registered Office is Cumbria House, 16-20 Hockliffe Street, Leighton Buzzard, Bedfordshire, LU7 1GN. VAT Registration Number is 500 2481 05.

See all our properties at www.connells.co.uk | www.rightmove.co.uk | www.zoopla.co.uk

Property Ref: LEY304122 - 0005