



Manor Estate, SE16

£807 Per week

Situated on a quiet leafy street, this four bedroom split level flat is immaculately presented and boasts a large living space, modern kitchen and bathroom, ample storage, parking and private garden. **SHORT LET.**

Holford House is located 0.3 miles from South Bermondsey station and 0.7 miles from Bermondsey station offering excellent transport links to all of London. A wide range of shops, cafés and restaurants are close by.

Features

SHORT LET
Four Bedrooms
Private Garden
Split Level
Excellent Condition
Parking
Furnished

Manor Estate, London, SE16

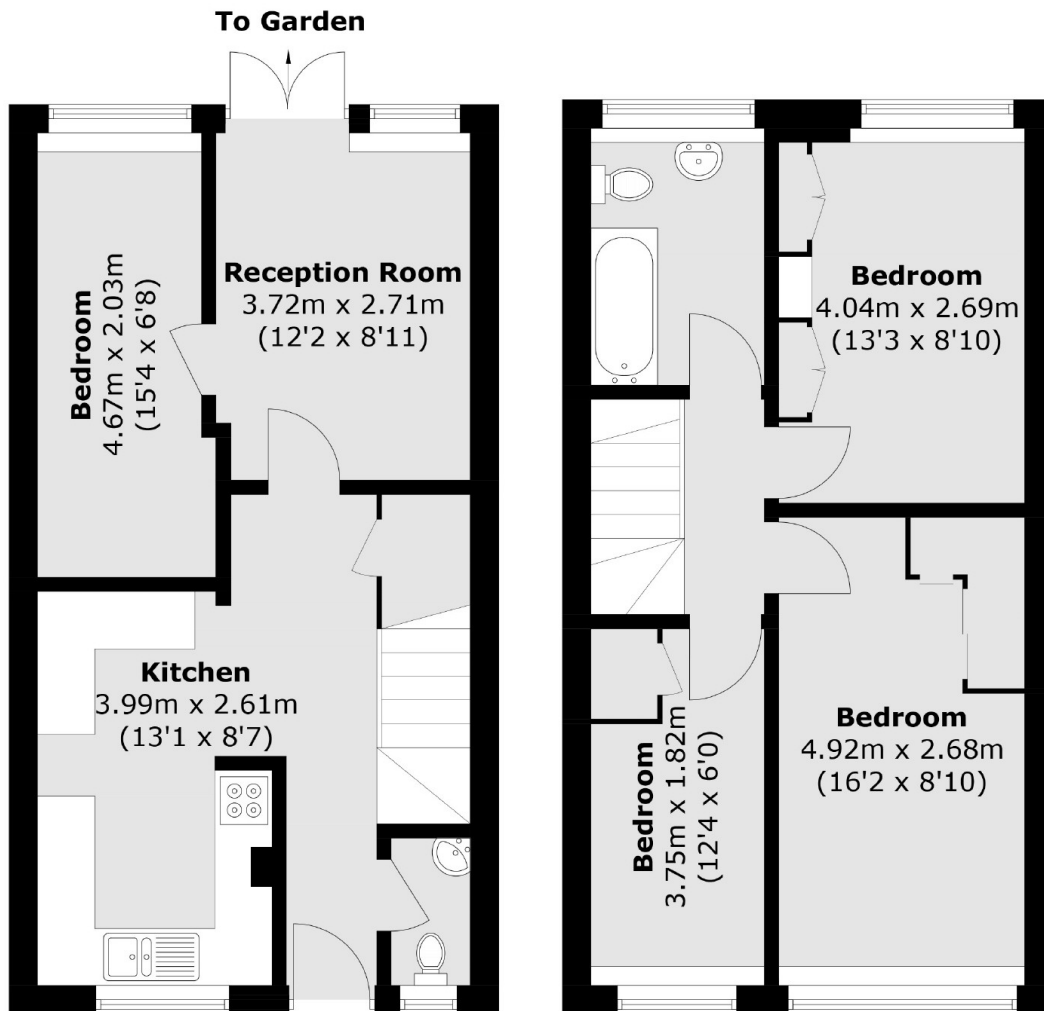

Ground Floor

First Floor

Total area (approx.): 82.0 sq. m (882.6 sq. ft)