

Gainsford Street, SE1

£473 Per week

A one double bedroom apartment on the first floor of this popular development in Shad Thames. Spacious throughout, this property would suit a single occupant or professional couple and has recently had double glazing installed.

Located in core Shad Thames with its quaint warehouse conversions, cobbled streets and trendy shops & eateries. Tower Bridge and the River Thames are close by.

Features

- One Double Bedroom
- Good Condition
- Wood Flooring
- Double Glazing
- Storage
- Shad Thames

Gainsford Street,
London, SE1

Second Floor

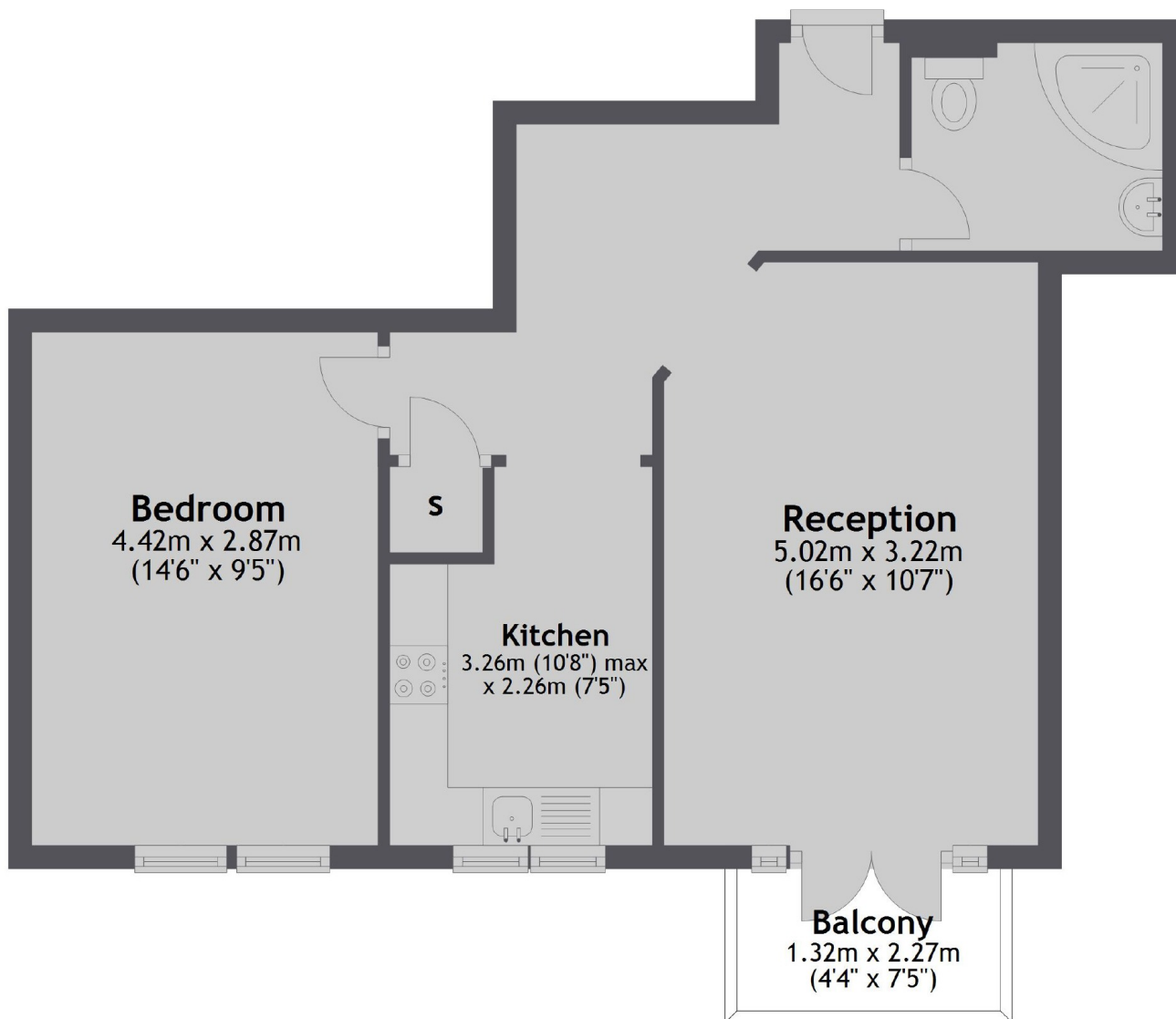

Total area: approx. 49.3 sq. metres (530.4 sq. feet)