



Frean Street, SE16

£484 Per week

This smart and stylish one double bedroom apartment, with a modern finish, is ideal for a single professional or young couple. This property comes with a large balcony with views over St. James' Church.

Prospect House is part of a recently developed area in the heart of Bermondsey, less than 0.2 miles from the Jubilee Line which gives easy access to the city and Canary Wharf. Maltby Street Market is close by, as is Shad Thames and Bermondsey Street.

Features

- One Double Bedroom
- Balcony
- First Floor
- Furnished
- Dishwasher
- Open Plan

Frean Street, London, SE16

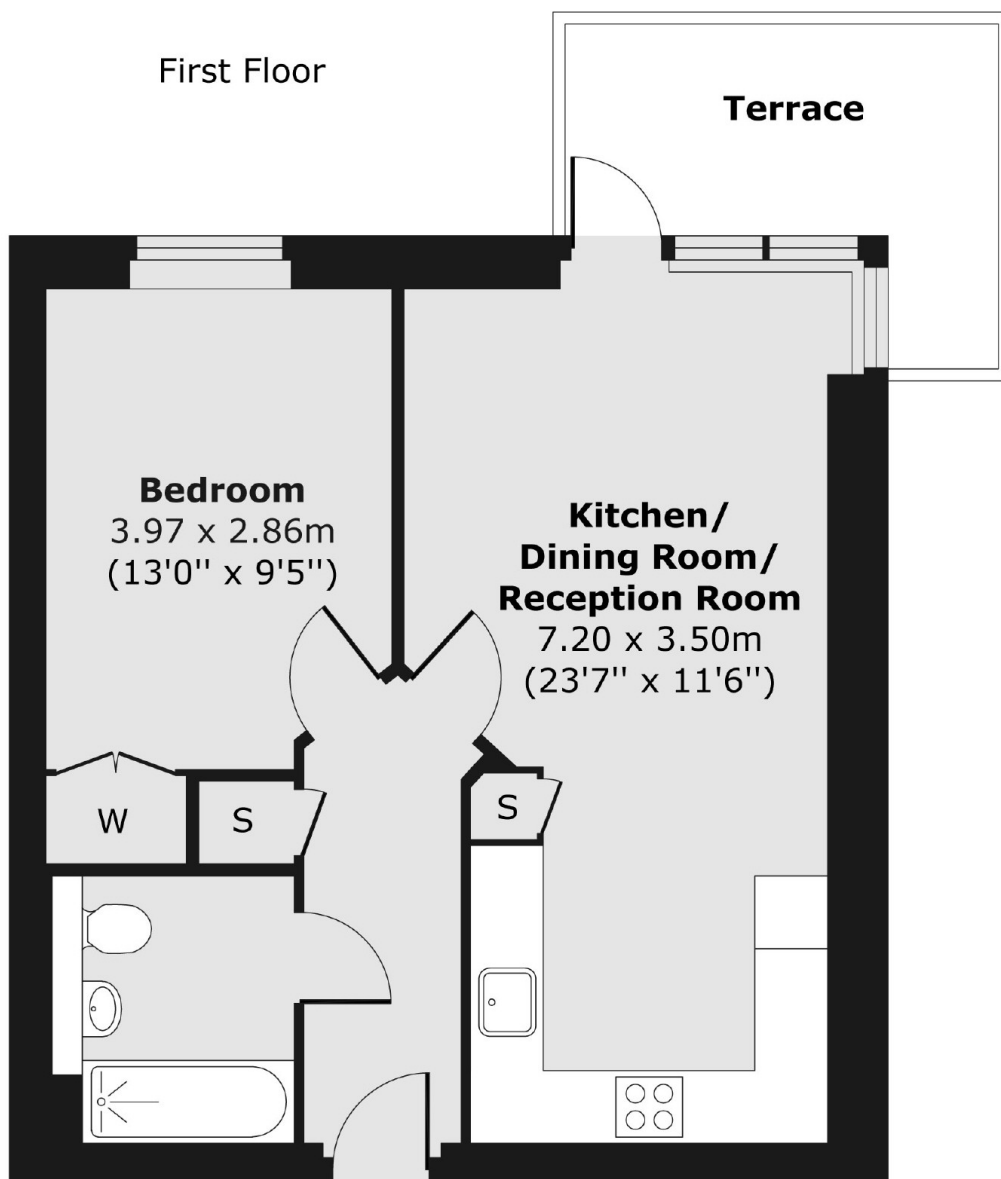

Total area (approx.): 46.18 sq. m (497 sq. ft)
Terrace area (approx.): 7.27 sq. m (78 sq. ft)