



BROMPTON SQUARE LONDON SW3
£575 PER WEEK AVAILABLE 27/06/2024

Hamptons

THE HOME EXPERTS

{ THE PARTICULARS

Brompton Square London SW3

**£575 Per Week
Furnished**

 **1 Bedroom**
 **1 Bathroom**
 **1 Reception**

Features

- One Bedroom, - One Bathroom, - Second Floor, - Communal Garden, - Furnished, - Council Tax Band F

Council Tax

Council tax band not specified

Hamptons

168 Brompton Road
Knightsbridge, London, SW3 1HW
020 7584 2014
KnightsbridgeLettings@hamptons.co.uk
www.hamptons.co.uk

{ A BRIGHT ONE BEDROOM APARTMENT ON A POPULAR GARDEN SQUARE

The Property

A bright one bedroom apartment on a popular garden square. Located on the second floor of this period building, this apartment offers excellent accommodation. The apartment also benefits from access to the communal square garden.

Location

Located on at the bottom of Brompton Square accessed from the Brompton Road with easy access to South Kensington underground station (half a mile) offering Circle & District along with the Piccadilly Line. Benefiting from a variety of shops and restaurants in the surrounding area.



Brompton Square, SW3
Approx. Gross Internal Area
443 Sq Ft - 41.15 Sq M

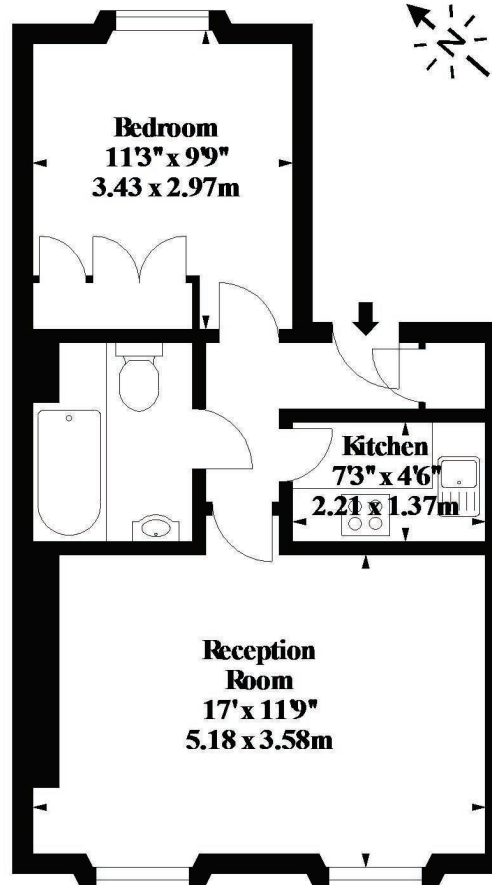

Second Floor

Measured in accordance with RICS guidelines. Every attempt is made to ensure accuracy, however all measurements are approximate. This floor plan is for illustrative purposes only and is not to scale.

© Datography UK Ltd 2008

Photographs * Floorplans * Virtual Tours
Tel: 08707 66 30 30 www.datography.com

For Clarification

We wish to inform prospective tenants that we have prepared these particulars as a general guide and they have been confirmed as accurate by the landlord. We have not verified permissions, nor carried out a survey, tested the services, appliances and specific fittings. Room sizes are approximate and measurement figures rounded: they are taken between internal wall surfaces and therefore include cupboards/shelves, etc. Accordingly, they should not be relied upon for

carpets and furnishings. It should also be noted that all fixtures and fittings, carpeted, curtains/blinds, kitchen equipment and garden statuary, whether fitted or not, are deemed removable by the landlord unless specifically itemised with these particulars. Please enquire in office or on our website for details on holding deposit and tenancy deposit figures.



ESTABLISHED 1869
lh
THE HOME EXPERTS