



BROMPTON ROAD LONDON SW3
£1,131 PER WEEK AVAILABLE NOW



Hamptons

THE HOME EXPERTS

{ THE PARTICULARS

Brompton Road London SW3

**£1,131 Per Week
Furnished**

 **2 Bedrooms**
 **2 Bathrooms**
 **1 Reception**

Features

- 2 Bedrooms, - 2 Bathrooms, - Air Conditioning, - Communal Heating, - Under Floor Heating, - CCTV & Security, - Cloakroom, - Lift, - Porter, - Council Tax Band G

Council Tax

Council Tax Band G

Hamptons

168 Brompton Road
Knightsbridge, London, SW3 1HW
020 7584 2014
KnightsbridgeLettings@hamptons.co.uk
www.hamptons.co.uk

{ A TWO BEDROOM APARTMENT IN PRIME KNIGHTSBRIDGE WITH CONCIERGE.

The Property

This spacious apartment comprises a large reception/dining room with a modern kitchen, a principal bedroom with a modern en-suite shower room and built in wardrobes, a further double bedroom, a separate family bathroom and further guest WC. The property benefits from a contemporary feel with hardwood floors through the main reception and hallway and benefits from 24hr concierge and air conditioning.

Location

Princes Court is located in the heart of Knightsbridge directly opposite Harrods, moments from many shops and restaurants of the surrounding area with Knightsbridge underground station being less than quarter of a mile away offering the Piccadilly Line for easy to travel in to London and or Heathrow.



PRINCES COURT

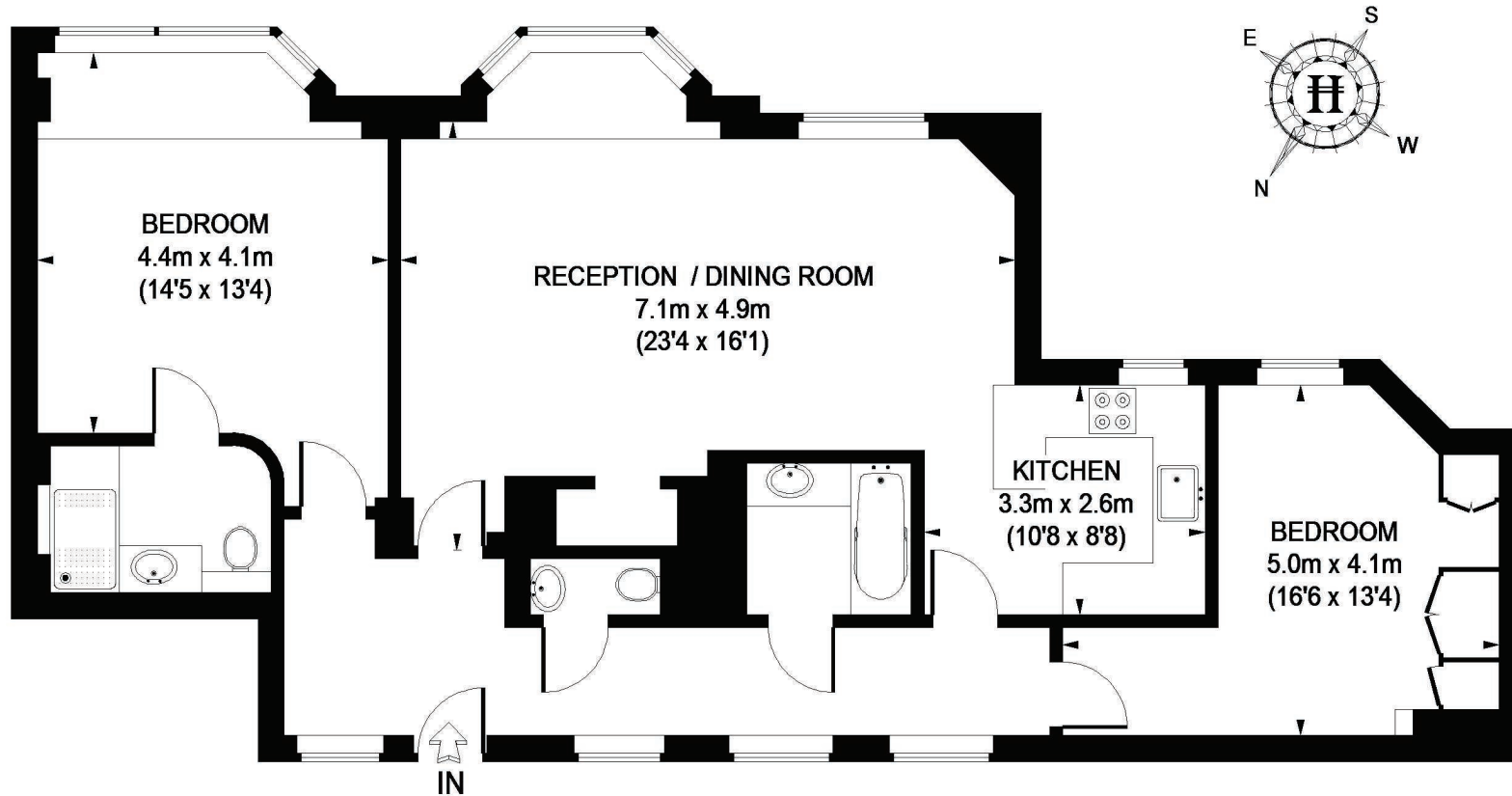

SECOND FLOOR

APPROXIMATE GROSS INTERNAL AREA
1087 SQ. FT. (101 SQ. M.)

This plan is for layout guidance only. Not drawn to scale unless stated. Windows & door openings are approximate. Whilst every care is taken in the preparation of this plan, please check all dimensions, shapes & compass bearings before making any decisions reliant upon them. Please be advised that Hamptons International / our agents have not seen or reviewed any building regulations or planning permission in relation to works carried out to the property. (ID55297)

For Clarification

We wish to inform prospective tenants that we have prepared these particulars as a general guide and they have been confirmed as accurate by the landlord. We have not verified permissions, nor carried out a survey, tested the services, appliances and specific fittings. Room sizes are approximate and measurement figures rounded: they are taken between internal wall surfaces and therefore include cupboards/shelves, etc. Accordingly, they should not be relied upon for

carpets and furnishings. It should also be noted that all fixtures and fittings, carpeted, curtains/blinds, kitchen equipment and garden statuary, whether fitted or not, are deemed removable by the landlord unless specifically itemised with these particulars. Please enquire in office or on our website for details on holding deposit and tenancy deposit figures.

