



{ KENSINGTON COURT LONDON W8
£3,650 PER MONTH AVAILABLE 09/12/2025

Hamptons
THE HOME EXPERTS

{ THE PARTICULARS

Kensington Court London W8

£3,650 Per Month
Furnished

 2 Bedrooms
 1 Bathroom
 1 Reception

Features

- Two Bedrooms, - One Bathroom, -
Wooden flooring throughout, - 4th
floor/lift, - Furnished, - Excellent Location

Council Tax

Council Tax Band F

Hamptons
8 Hornton Street
Kensington, London, W8 4NW
020 7937 9372
KensingtonLettings@hamptons.co.uk
www.hamptons.co.uk

{ A BEAUTIFULLY PRESENTED PRIME TWO BEDROOM APARTMENT IN KENSINGTON

The Property

A beautifully refurbished two bedroom residence located in one of Kensington's most exclusive addresses. Moments from Kensington High Street station and just steps from the idyllic Kensington Gardens, this bright top floor apartment (with lift) sits within an elegant, well-maintained red-brick mansion block in the very heart of London's cultural and lifestyle district. Offering an inviting open plan living and kitchen area with wooden flooring throughout, the flat combines modern comfort with classic London charm. The property features two well proportioned bedrooms, a contemporary shower room, and is bathed in natural light throughout the day. Surrounded by world class museums, boutiques, cafés, and concert halls, this is an exceptional home in a truly unbeatable location. Available furnished.

Location

Kensington Court is located moments from the shops, restaurants and transport links (District and Circle lines) of Kensington High Street and the green open spaces of Kensington Gardens and Hyde Park.



KENSINGTON COURT

Approximate Gross Internal Area

747 sq. ft. (69.4 sq. m.)

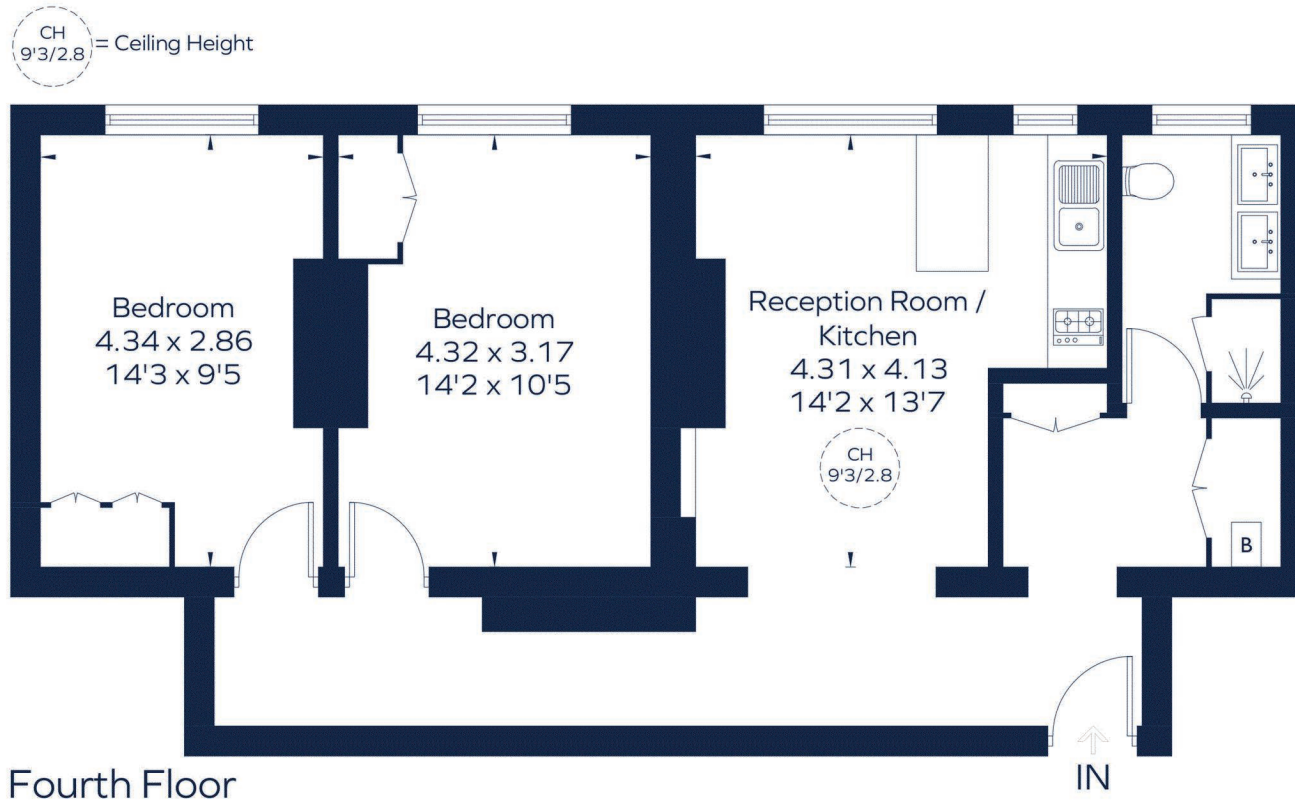

This plan is for layout guidance only. Not drawn to scale unless stated. Windows and door openings are approximate. Whilst every care is taken in the preparation of this plan, please check all dimensions, shapes and compass bearings before making any decisions reliant upon them.
ID 825489

For Clarification

We wish to inform prospective tenants that we have prepared these particulars as a general guide and they have been confirmed as accurate by the landlord. We have not verified permissions, nor carried out a survey, tested the services, appliances and specific fittings. Room sizes are approximate and measurement figures rounded: they are taken between internal wall surfaces and therefore include cupboards/shelves, etc. Accordingly, they should not be relied upon for

carpets and furnishings. It should also be noted that all fixtures and fittings, carpeted, curtains/blinds, kitchen equipment and garden statuary, whether fitted or not, are deemed removable by the landlord unless specifically itemised with these particulars. Please enquire in office or on our website for details on holding deposit and tenancy deposit figures.

