



{ OAKWOOD COURT LONDON W14  
£675 PER WEEK AVAILABLE NOW

Hamptons  
THE HOME EXPERTS



# { THE PARTICULARS

Oakwood Court London W14

£675 Per Week  
Unfurnished

 1 Bedroom  
 1 Bathroom  
 1 Reception

## Features

- One Bedroom, - Large Bathroom, -  
Separate Kitchen, - 24 Hour Porter, -  
Communal Gardens, - Communal Heating  
and Hotwater, - Unfurnished

## Council Tax

Council Tax Band E

Hamptons  
8 Hornton Street  
Kensington, London, W8 4NW  
020 7937 9372  
[KensingtonLettings@hamptons.co.uk](mailto:KensingtonLettings@hamptons.co.uk)  
[www.hamptons.co.uk](http://www.hamptons.co.uk)

# { A REFURBISHED BRIGHT ONE BEDROOM APARTMENT WITH PORTER

## The Property

A refurbished one bedroom apartment located on the second floor with lift of this highly popular portered mansion block. The apartment comprises large reception with wooden floors, separate kitchen, double bedroom with excellent built-in storage and bathroom. Oakwood Court benefits from a 24 hour concierge and communal garden for residents use. Heating and hot water are communal to the building. Offered unfurnished.

## Location

Oakwood Court is conveniently located for the shopping, entertainment and transport facilities of both Kensington High Street and Holland Park Avenue and is minutes from the open spaces of Holland Park.



750 sq. ft. (69.7 sq. m.)



$\frac{CH}{8'10/2.7}$  = Ceiling Height

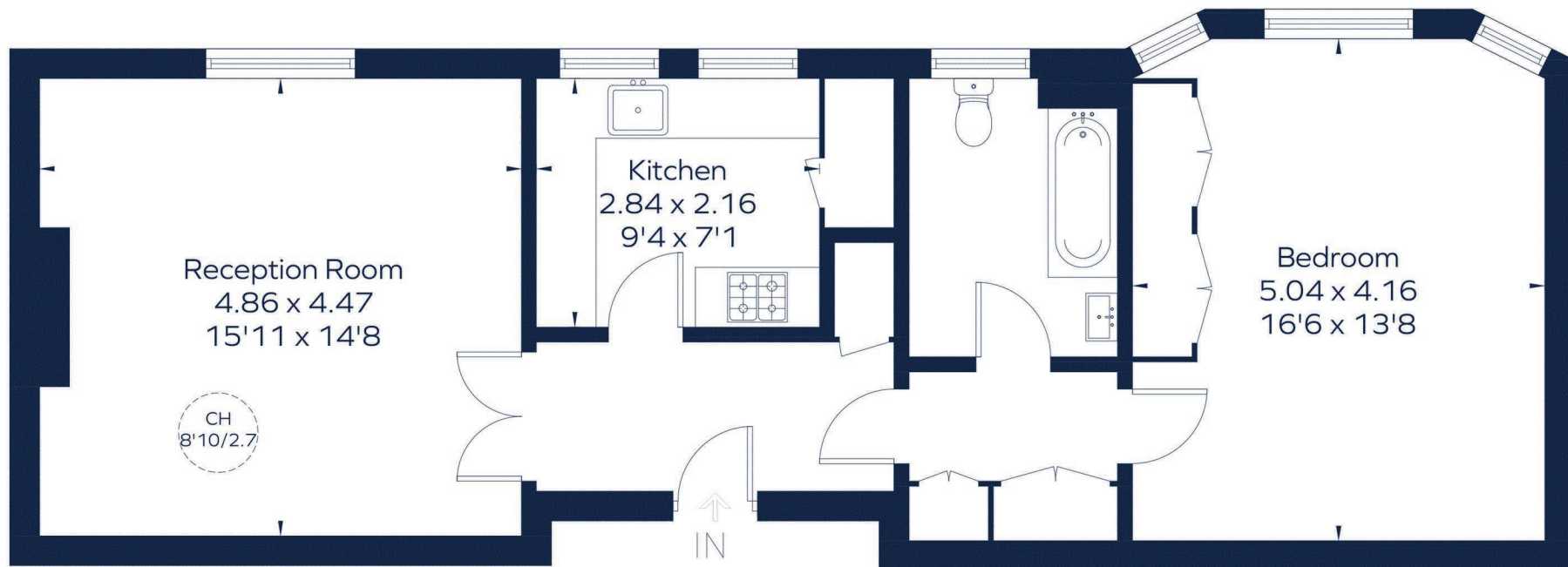

## Second Floor

This plan is for layout guidance only. Not drawn to scale unless stated. Windows and door openings are approximate. Whilst every care is taken in the preparation of this plan, please check all dimensions, shapes and compass bearings before making any decisions reliant upon them.

### For Clarification

We wish to inform prospective tenants that we have prepared these particulars as a general guide and they have been confirmed as accurate by the landlord. We have not verified permissions, nor carried out a survey, tested the services, appliances and specific fittings. Room sizes are approximate and measurement figures rounded: they are taken between internal wall surfaces and therefore include cupboards/shelves, etc. Accordingly, they should not be relied upon for

carpets and furnishings. It should also be noted that all fixtures and fittings, carpeted, curtains/blinds, kitchen equipment and garden statuary, whether fitted or not, are deemed removable by the landlord unless specifically itemised with these particulars. Please enquire in office or on our website for details on holding deposit and tenancy deposit figures.

Energy Efficiency Rating		Current	Potential
For energy efficient - high heating costs	A		
For energy efficient - high heating costs	B		81
For energy efficient - high heating costs	C		
For energy efficient - high heating costs	D	70	
For energy efficient - high heating costs	E		
For energy efficient - high heating costs	F		
For energy efficient - high heating costs	G		
For energy efficient - high heating costs			

England & Wales

EU Directive expected





Awaiting Photograph