



**KENSINGTON COURT LONDON W8**  
*£625 PER WEEK AVAILABLE 02/09/2024*

**Hamptons**

THE HOME EXPERTS

# { THE PARTICULARS

Kensington Court London W8

**£625 Per Week  
Furnished**

 **1 Bedroom**  
 **1 Bathroom**  
 **1 Reception**

## Features

- One Bedroom, - One Bathroom, - Guest WC, - Patio, - Modern Kitchen, - Wooden floors, - Furnished

## Council Tax

Council Tax Band E

## Hamptons

8 Hornton Street  
Kensington, London, W8 4NW  
020 7937 9372  
KensingtonLettings@hamptons.co.uk  
www.hamptons.co.uk

# { A PRETTY ONE BEDROOM APARTMENT WITH PATIO

## The Property

A wonderfully refurbished one bedroom apartment in the heart of Kensington, benefiting from a pretty private patio, modern fixtures and stylish furnishings. This apartment comprises a good sized reception room leading to a modern kitchen and access out to the lovely private patio. There is a large double bedroom with good storage, en-suite bathroom and a separate guest WC with utility cupboard. There are wood floors throughout and the apartment is offered furnished. \*\*Furniture differs to the photography\*\*

## Location

Kensington Court is located moments from Kensington High Street (District and Circle lines) and Kensington Gardens are close by.



# KENSINGTON COURT

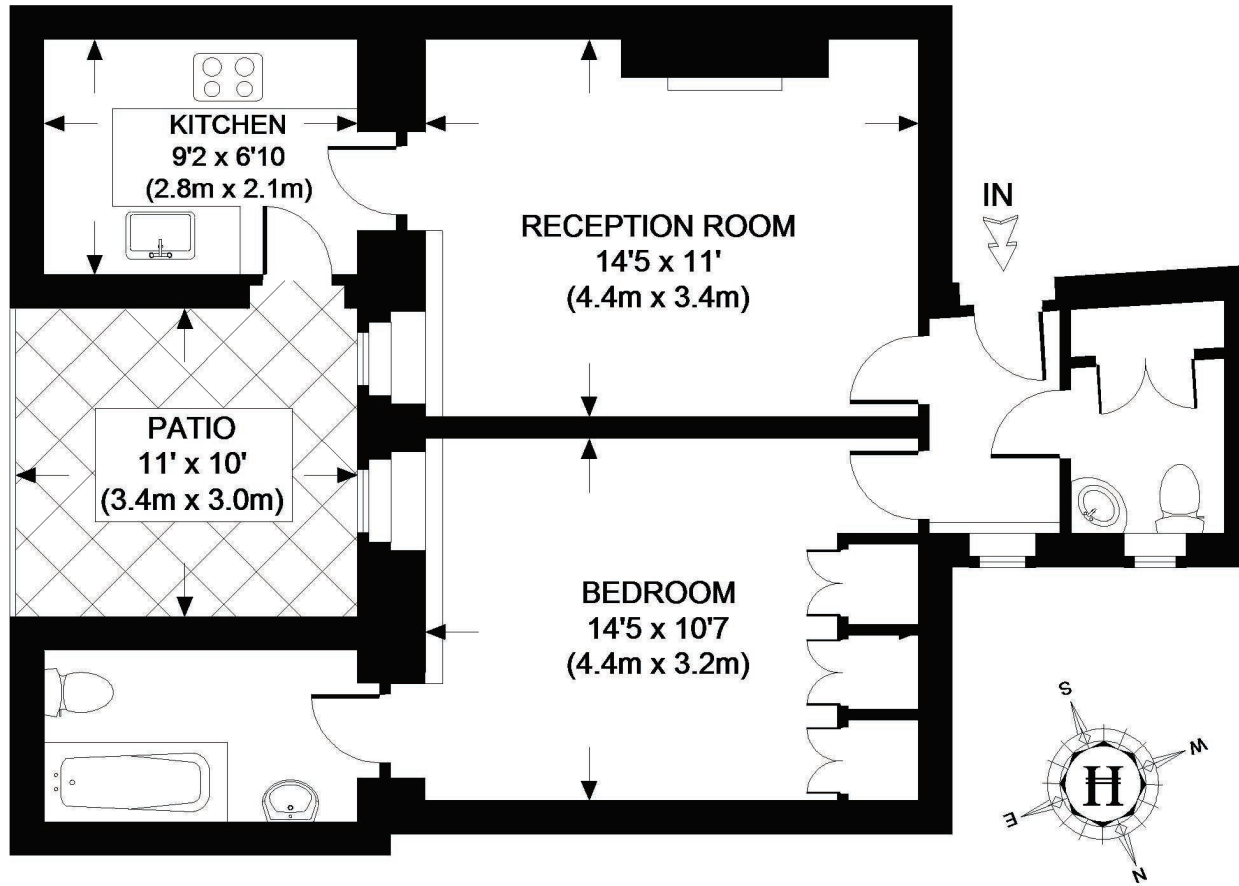

LOWER GROUND FLOOR

**APPROXIMATE GROSS INTERNAL AREA = 506 SQ.FT. (47 SQ. M.)**

This plan is for layout guidance only. Not drawn to scale unless stated. Windows & door openings are approximate. Whilst every care is taken in the preparation of this plan, please check all dimensions, shapes & compass bearings before making any decisions reliant upon it.

**For Clarification**

We wish to inform prospective tenants that we have prepared these particulars as a general guide and they have been confirmed as accurate by the landlord. We have not verified permissions, nor carried out a survey, tested the services, appliances and specific fittings. Room sizes are approximate and measurement figures rounded: they are taken between internal wall surfaces and therefore include cupboards/shelves, etc. Accordingly, they should not be relied upon for

carpets and furnishings. It should also be noted that all fixtures and fittings, carpeted, curtains/blinds, kitchen equipment and garden statuary, whether fitted or not, are deemed removable by the landlord unless specifically itemised with these particulars. Please enquire in office or on our website for details on holding deposit and tenancy deposit figures.

Energy Efficiency Rating		Current	Potential
Band A	91-100		
Band B	81-90		
Band C	71-80		
Band D	61-70		
Band E	51-60	55	67
Band F	41-50		
Band G	1-40		

EU Directive 2002/91/EC  
England & Wales





Awaiting Photograph