



WARWICK GARDENS LONDON W14
£1,000 PER WEEK AVAILABLE NOW

Hamptons
THE HOME EXPERTS

{ THE PARTICULARS

Warwick Gardens London W14

£1,000 Per Week
Furnished

 1 Bedroom
 1 Bathroom
 1 Reception

Features

- Bedroom, - Bathroom, - Reception Room,
- Kitchen/Breakfast Room, - Wooden
Flooring, - Large Garden, - Short Let

Council Tax

Council Tax Band D

Hamptons

8 Hornton Street
Kensington, London, W8 4NW
020 7937 9372
KensingtonLettings@hamptons.co.uk
www.hamptons.co.uk

{ SHORT LET A SUPERB GARDEN FLAT

The Property

** SHORT LET** ALL BILLS INCLUDED A charming and elegant well appointed property providing a comfortable living space and superb outside area, close to Kensington High Street and Earls Court. The living room area is ideal for relaxation and benefits from wooden flooring and views out to the private spacious patio garden. There is a separate eat-in kitchen and a spacious bedroom with good storage. Additionally, the abundance of natural light creates a bright and inviting ambiance throughout the space. Offered fully furnished.

Location

Located on Warwick Gardens the property is ideally placed for access to Holland Park, High Street Kensington and Earls Court Underground Stations (Central, District, Circle and Piccadilly lines). The local amenities are all within walking distance.



WARWICK GARDENS

Approximate Gross Internal Area

609 sq. ft. (56.6 sq. m.)

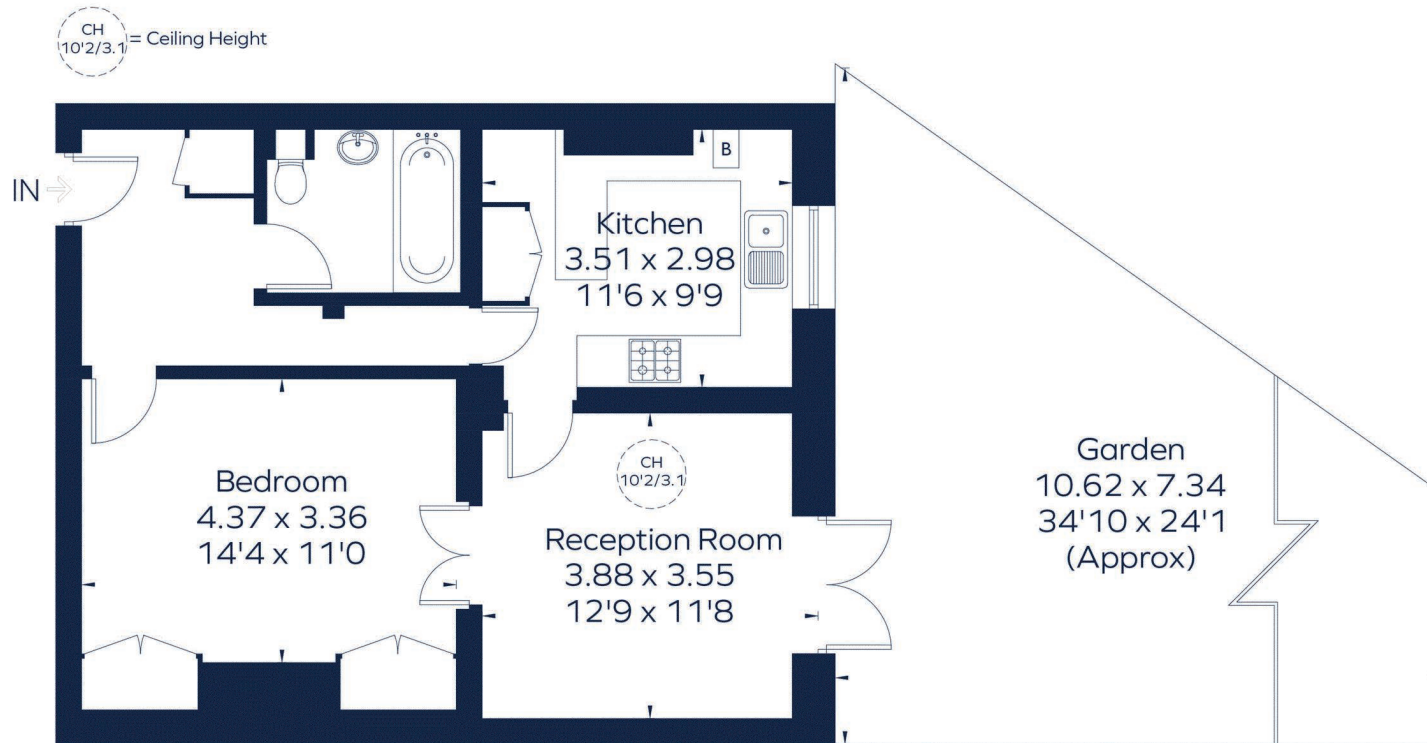

Lower Ground Floor

This plan is for layout guidance only. Not drawn to scale unless stated. Windows and door openings are approximate. Whilst every care is taken in the preparation of this plan, please check all dimensions, shapes and compass bearings before making any decisions reliant upon them.
ID 1023590

For Clarification

We wish to inform prospective tenants that we have prepared these particulars as a general guide and they have been confirmed as accurate by the landlord. We have not verified permissions, nor carried out a survey, tested the services, appliances and specific fittings. Room sizes are approximate and measurement figures rounded: they are taken between internal wall surfaces and therefore include cupboards/shelves, etc. Accordingly, they should not be relied upon for

carpets and furnishings. It should also be noted that all fixtures and fittings, carpeted, curtains/blinds, kitchen equipment and garden statuary, whether fitted or not, are deemed removable by the landlord unless specifically itemised with these particulars. Please enquire in office or on our website for details on holding deposit and tenancy deposit figures.

Energy Efficiency Rating		Current	Potential
92-100	A		
81-91	B		
69-80	C		
55-68	D		
49-54	E		
35-48	F		
1-34	G		
		71	78

EU Directive 2002/91/EC
England & Wales

