



Instinct Guides You



Farwell Crescent, Weymouth, DT3 4FR £265,000

Final property of BRAND NEW three bedroom homes in FARWELL CRESCENT, CHICKERELL.

Traditional architecture, with luxuriously finishes internally, including wood burners to each living room.

Within walking distance of local shops/ amenities, Farwell Crescent sits on the outskirts of Weymouth, in the village of CHICKERELL approximately three miles from Weymouth Town Centre and railway station.

There are local schools nearby and a wealth of recreational and sporting facilities, these homes are ideal for young families, professionals and retired alike.

Accommodations with come fully carpeted and all benefit from garages and parking.

All units also boast modern fitted kitchens and bathrooms plus low maintenance rear gardens with a finish to be confirmed at the purchasers discretion.

The Help To Buy scheme is available on all units. Please call now for further details on 01305 775500.



Registration No. 08079158 Directors Mr Wilson, Mr Tominey

Courtesy Notice Upon using WilsonTominey as selling agents ensure we are made aware of contractual obligations you may be under. We can then proceed accordingly.

WilsonTominey Ltd
15 Westham Rd.
DT4 8NS

T 01305 775500
E sales@wilsontominey.co.uk
W www.wilsontominey.co.uk



- Entrance
- Hallway
- Downstairs Cloakroom
- Lounge
- Kitchen/ Diner
- Landing
- Bedroom One
- Bedroom Two
- Bathroom
- Second Floor Landing
- Master Bedroom
- Second Bathroom
- Rear Garden
- Garage
- Parking

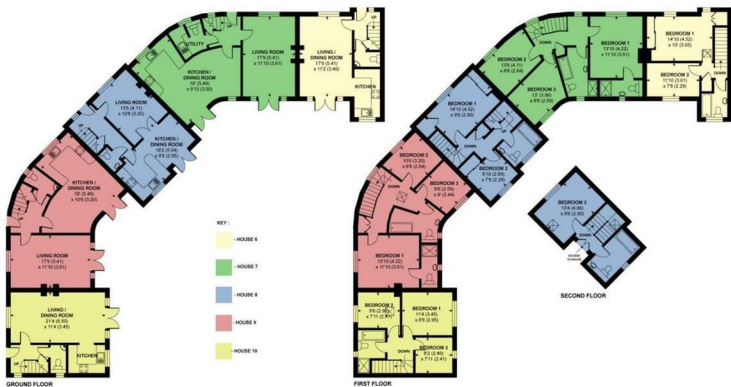

Energy Efficiency Rating		
	Current	Potential
Very energy efficient - lower running costs		
(92 plus) A		
(81-91) B		
(69-80) C		
(55-68) D		
(39-54) E		
(21-38) F		
(1-20) G		
Not energy efficient - higher running costs		
England & Wales		
EU Directive 2002/91/EC		

Environmental Impact (CO ₂) Rating		
	Current	Potential
Very environmentally friendly - lower CO ₂ emissions		
(92 plus) A		
(81-91) B		
(69-80) C		
(55-68) D		
(39-54) E		
(21-38) F		
(1-20) G		
Not environmentally friendly - higher CO ₂ emissions		
England & Wales		
EU Directive 2002/91/EC		

Important Notice: Particulars are prepared for marketing purposes only and should not be treated as a statement of the condition of any building, fixture or appliance. All measurements, floor plans and lease/ maintenance are approximate and not to be relied upon. Purchasers should make their own checks before relying on any of the information provided herein. * For double glazing and gas radiator heating, it is where specified.