



Instinct Guides You



## Hope Square, Weymouth £1,200 PCM

- Three Double Bedrooms
- Two Modern En-Suites
- Spacious Living Room
- Feature Fireplace
- EPC: TBC
- Characterful Hope Square Location
- Moments From Harbour
- Close To Sandy Beach
- Restaurants And Cafes Nearby
- Council Tax Band: TBC

**Submit Your  
Application  
Today...**

Head to [www.wilsontominey.co.uk](http://www.wilsontominey.co.uk)  
to complete our application form

**Complete Our Application Form**

All applications will be shortlisted for viewings. Once shortlisted, Wilson Tominey aims to be in contact within 7 working days.

WilsonTominey  
PROPERTY & COASTLINE



Registration No. 08079158 Directors Mr Wilson, Mr Tominey

Courtesy Notice Upon using WilsonTominey as selling agents ensure we are made aware of contractual obligations you may be under. We can then proceed accordingly.

WilsonTominey Ltd  
15 Westham Rd.  
DT4 8NS

T 01305 775500  
E [sales@wilsontominey.co.uk](mailto:sales@wilsontominey.co.uk)  
W [www.wilsontominey.co.uk](http://www.wilsontominey.co.uk)



Situated in the heart of Hope Square, one of Weymouth's most desirable and characterful areas, this spacious three-bedroom maisonette offers a rare opportunity to enjoy generous accommodation in a highly sought-after location. The property is set moments from the harbour, local restaurants and cafes, and is within easy reach of the town centre and sandy beaches. Offering three bedrooms, two en-suite bathrooms, a large living room and a separate kitchen, the apartment combines modern finishes with period charm.

The private entrance leads into the first floor, where the kitchen is located to the front of the property. Fitted with a range of white units and shelving, it provides a bright and practical space. From here the hallway opens into the first of the bedrooms, a spacious double. This room is served by En-Suite One, fitted with a separate shower, WC and wash basin, finished with neutral modern tiling.

The living room occupies the opposite side of the ground floor and offers an excellent amount of space for both seating and dining. A fireplace with surround creates a central focal point, and the large window allows natural light to fill the room.

Stairs rise to the first floor where two further double bedrooms can be found. Bedroom One is the largest of the three and includes a exposed brick work and fresh décor, creating a bright and airy feel. Bedroom Two also offers generous proportions and provides access to En-Suite Two, a modern bathroom with a bathtub, WC and wash basin.

Throughout, the property is finished in a light, neutral style, combining modern bathrooms and kitchen fittings with attractive period features. This maisonette offers flexible accommodation across two floors in a highly desirable Weymouth location.

EPC: TBC  
Council Tax Band: A

## Room Dimensions

Livingroom

Kitchen

Bedroom One

En-Suite One

Bedroom Two

En-Suite Two

Bedroom Three

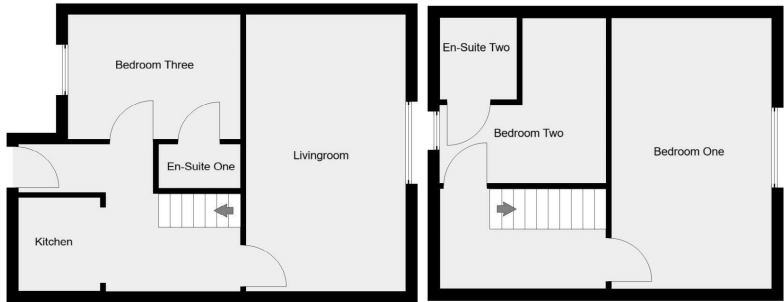

Energy Efficiency Rating		
	Current	Potential
Very energy efficient - lower running costs		
(92 plus) <b>A</b>		
(81-91) <b>B</b>		
(69-80) <b>C</b>		
(55-68) <b>D</b>		
(39-54) <b>E</b>		
(21-38) <b>F</b>		
(1-20) <b>G</b>		
Not energy efficient - higher running costs		
England & Wales		
EU Directive 2002/91/EC		

Environmental Impact (CO <sub>2</sub> ) Rating		
	Current	Potential
Very environmentally friendly - lower CO <sub>2</sub> emissions		
(92 plus) <b>A</b>		
(81-91) <b>B</b>		
(69-80) <b>C</b>		
(55-68) <b>D</b>		
(39-54) <b>E</b>		
(21-38) <b>F</b>		
(1-20) <b>G</b>		
Not environmentally friendly - higher CO <sub>2</sub> emissions		
England & Wales		
EU Directive 2002/91/EC		

Important Notice: Particulars are prepared for marketing purposes only and should not be treated as a statement of the condition of any building, fixture or appliance. All measurements, floor plans and lease/ maintenance are approximate and not to be relied upon. Purchasers should make their own checks before relying on any of the information provided herein. \* For double glazing and gas radiator heating, it is where specified.