



Instinct Guides You



Rodwell Street, Weymouth £1,325 PCM

- Three Bedroom Home
- Well Presented Throughout
- Walking Distance To Weymouth Harbour
- Views
- EPC - E
- CALL 01305 775500 TO BOOK A VIEWING
- Walking Distance To Town
- Close To Amenities
- Available Soon
- Council Tax - TBC



Submit Your Application Today...

Head to www.wilsontominey.co.uk to complete our application form

Complete Our Application Form

All applications will be shortlisted for viewings. Once shortlisted, Wilson Tominey aims to be in contact within 7 working days.



Registration No. 08079158 Directors Mr Wilson, Mr Tominey

Courtesy Notice Upon using WilsonTominey as selling agents ensure we are made aware of contractual obligations you may be under. We can then proceed accordingly.

WilsonTominey Ltd
15 Westham Rd.
DT4 8NS

T 01305 775500
E sales@wilsontominey.co.uk
W www.wilsontominey.co.uk



TO LET – Characterful Three Bedroom Home Close to Weymouth Harbour

Full of charm and history, this three bedroom home offers the perfect blend of character and modern comfort. Ideally located within walking distance of Weymouth Harbour, the town centre, and local amenities, the property also enjoys pleasant views, making it a truly special place to live.

Inside, the kitchen is filled with natural light, creating a bright and welcoming space for cooking and dining. The comfortable living room retains a homely feel, perfect for relaxing after a long day. Upstairs, you'll find a large bathroom complete with both a bath and separate shower cubicle, adding flexibility and convenience to daily life.

With three bedrooms, this home provides plenty of space for families or professionals, while its rich history adds a unique charm rarely found in modern properties.

Well presented throughout and available soon, this is a wonderful opportunity to rent a home that combines practicality with character, all in one of Weymouth's most desirable locations.

EPC: E

Council Tax: TBC

?? Call to book your viewing today – homes with this much history and character don't stay on the market for long!

Room Dimensions

- Dining Room 12'3" x 10'10" (3.75 x 3.31)
- Lounge 11'8" x 11'6" (3.58 x 3.51)
- Kitchen 14'3" x 5'8" (4.36 x 1.75)
- Bedroom One 14'9" x 11'6" (4.52 x 3.53)
- Bedroom Two 14'0" x 11'5" (4.28 x 3.5)
- Bedroom Three 10'10" x 8'7" (3.32 x 2.62)

Application Process

Due to the current high level of demand, we are asking all prospective tenants to submit an application form prior to viewing.

Once in receipt of an application, these will be sent to the landlord and they will shortlist those applicants to a select few, ensuring we are only conducting viewings with relevant parties.

IMPORTANT: Prior to submitting an application, please conduct all other investigations to satisfy yourself with the property - a drive by of the location, viewing the virtual/ video tour (where available), studying the floor-plan/ measurements/ photos.

Please copy and paste the link below into your web browser if you would like an application:

www.wilsonsominey.co.uk/application

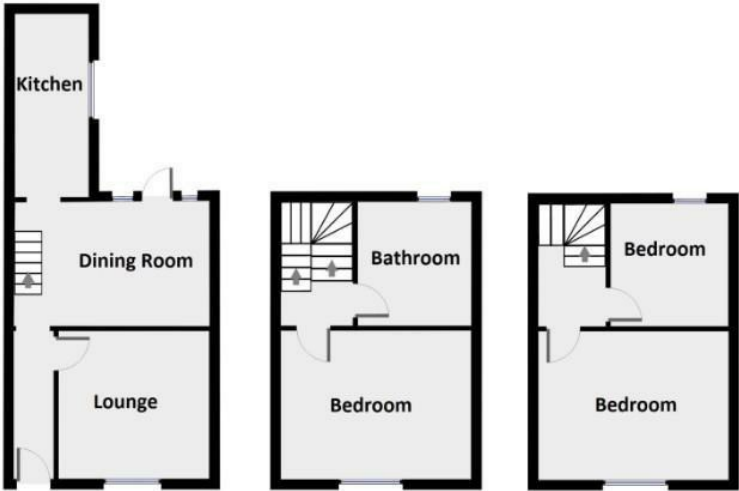

| Energy Efficiency Rating | | | Environmental Impact (CO ₂) Rating | | |
|---|---------|-----------|--|---------|-----------|
| | Current | Potential | | Current | Potential |
| Very energy efficient - lower running costs | | | | | |
| (92 plus) A | | | | | |
| (81-91) B | | | | | |
| (69-80) C | | | | | |
| (55-68) D | | | | | |
| (39-54) E | | | | | |
| (21-38) F | | | | | |
| (1-20) G | | | | | |
| Not energy efficient - higher running costs | | | | | |
| England & Wales | | | England & Wales | | |
| EU Directive 2002/91/EC | | | EU Directive 2002/91/EC | | |

Important Notice: Particulars are prepared for marketing purposes only and should not be treated as a statement of the condition of any building, fixture or appliance. All measurements, floor plans and lease/ maintenance are approximate and not to be relied upon. Purchasers should make their own checks before relying on any of the information provided herein. * For double glazing and gas radiator heating, it is where specified.