



Instinct Guides You



Corscombe Close, Weymouth £1,050 PCM

- Views Over Radipole Lake & Swannery
- Bathroom & En-suite
- Built In Wardrobes
- Moments From the Centre & Beach
- EPC = B
- Two Double Bedrooms
- Allocated Parking
- Balcony
- Large Hall, Perfect For Storage
- Council Tax is Band D



Submit Your
Application Today...

aria | propertymark

Head to www.wilsontominey.co.uk
to complete our application form.

All applications will be considered for viewings. Once advertised Wilson Tominey aims to be in contact within 7 working days.

WilsonTominey  Instinct Guides You



Registration No. 08079158 Directors Mr Wilson, Mr Tominey

Courtesy Notice Upon using WilsonTominey as selling agents ensure we are made aware of contractual obligations you may be under. We can then proceed accordingly.

WilsonTominey Ltd
15 Westham Rd.
DT4 8NS

T 01305 775500
E sales@wilsontominey.co.uk
W www.wilsontominey.co.uk



*** PLEASE SEE APPLICATION PROCESS ***

A TWO DOUBLE BEDROOM EN-SUITE apartment with PARKING and enjoyable VIEWS over Radipole LAKE & SWANNERY, boasting a glimpse of the MARINA. This spacious apartment benefits a lift to all floors and BALCONY to sit and watch the world go by.

Entering the property you are welcomed by a generous size hallway with doors to all rooms, ample storage cupboards and telephone entrance security system.

The large lounge diner situated to the rear of the property offers ample space for furnishings and open views through the patio doors and balcony over the Radipole Lake & Swannery. There is space for a table and chairs on the balcony to enjoy the amazing view.

The kitchen laid adjacent to the lounge is fitted with a range of wall and base units with built in appliances such as a fridge freezer, washer dryer, electric oven and electric hob.

The two bedrooms are both double bedrooms with main benefiting an en-suite and fitted wardrobes with plenty of space for additional furniture again enjoying the view whilst bedroom two enjoys a different aspect and allows space for furnishings.

The bathroom offers a bath with shower over, wash hand basin & WC.

The Council Tax is Band D

The EPC = B

Room Dimensions

Lounge 14'5" x 13'0" (4.41m x 3.98m)

Kitchen 11'4" x 6'0" (3.46m x 1.84m)

Bedroom One 11'8" inc wardrobe x 8'11" (3.57m inc wardrobe x 2.73m)

Bedroom Two 11'4" x 8'10" (3.46m x 2.70m)

Bathroom 7'1" x 5'6" (2.18m x 1.70m)

Application Process

Due to the current high level of demand, we are asking all prospective tenants to submit an application prior to viewing. Once in receipt of an application, the landlord will shortlist those applicants to a select few, ensuring we are only conducting viewings with relevant parties.

IMPORTANT: Prior to submitting an application, please conduct all other investigations to satisfy yourself with the property - a drive by of the location, viewing the virtual/ video tour (where available), studying the floor-plan/ measurements/ photos.

Please copy and paste the link below into your web browser if you would like an application:

wilsontominey.co.uk/application

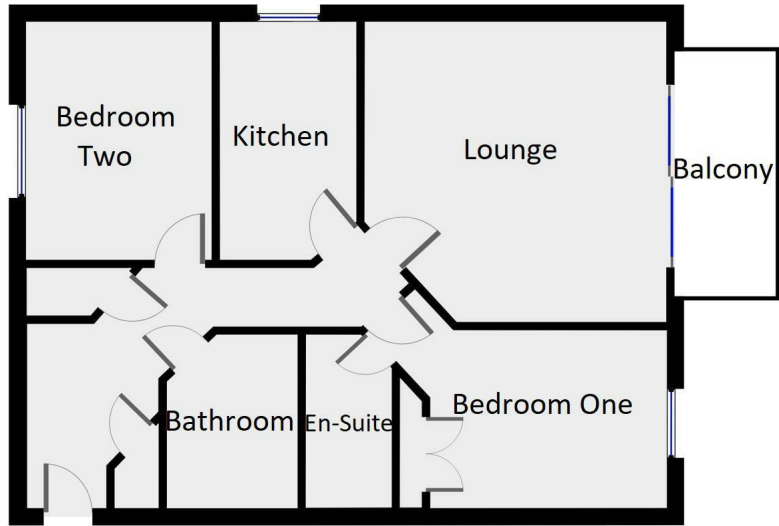

Energy Efficiency Rating		
	Current	Potential
Very energy efficient - lower running costs		
(92 plus) A		
(81-91) B		
(69-80) C		
(55-68) D		
(39-54) E		
(21-38) F		
(1-20) G		
Not energy efficient - higher running costs		
England & Wales	EU Directive 2002/91/EC	

Environmental Impact (CO ₂) Rating		
	Current	Potential
Very environmentally friendly - lower CO ₂ emissions		
(92 plus) A		
(81-91) B		
(69-80) C		
(55-68) D		
(39-54) E		
(21-38) F		
(1-20) G		
Not environmentally friendly - higher CO ₂ emissions		
England & Wales	EU Directive 2002/91/EC	

Important Notice: Particulars are prepared for marketing purposes only and should not be treated as a statement of the condition of any building, fixture or appliance. All measurements, floor plans and lease/ maintenance are approximate and not to be relied upon. Purchasers should make their own checks before relying on any of the information provided herein. * For double glazing and gas radiator heating, it is where specified.