



Instinct Guides You



Portwey Close, Weymouth Offers In Excess Of £425,000

- No Onward Chain
- Four Bedrooms
- Garage & Driveway
- Southerly Garden
- Popular Cul-De-Sac
- Versatile Layout
- Conservatory
- Moments From Town & Harbour



Registration No. 08079158 Directors Mr Wilson, Mr Tominey

Courtesy Notice Upon using WilsonTominey as selling agents ensure we are made aware of contractual obligations you may be under. We can then proceed accordingly.

WilsonTominey Ltd
15 Westham Rd.
DT4 8NS

T 01305 775500
E sales@wilsontominey.co.uk
W www.wilsontominey.co.uk



We are delighted to present this versatile four-bedroom, detached chalet bungalow in the quiet cul-de-sac of Portwey Close, Rodwell. With a southerly-facing rear garden, off-road parking, a garage, and a conservatory, this home offers both comfort and convenience. The property is sold with no onward chain and is just minutes from the picturesque harbourside, a short walk to Weymouth town centre, and the award-winning beach, where you can enjoy coastal living and a wide range of local amenities.

Upon entering, a welcoming porch leads to a spacious hallway with useful storage cupboards. The hallway provides access to the lounge, kitchen, bedrooms one and two, and the modern bathroom. The lounge is a bright and airy space, filled with natural light from its sunny aspect, with ample room for a variety of furniture. The large full-height window and patio doors open directly onto the garden, offering a seamless connection to the outdoors.

Bedroom one is a spacious double room with ample space for storage, while bedroom two is slightly smaller adding to the flexibility of use.. The kitchen is equipped with a range of eye-level and base units, ample work surface, and plumbing for a washing machine. This leads into the conservatory, which also serves as a utility area with access to the garden. The bathroom is modern and includes a vanity unit, a bath with shower over, and WC.

Upstairs, there are two further double bedrooms, offering great flexibility. One of the bedrooms has a glimpse of Weymouth Bay, and both share a shower room.

Externally, the property sits on a superb southerly-facing plot, offering both privacy and seclusion. The large patio area is perfect for alfresco dining and relaxation, with a delightful wooden summer house providing additional outdoor space. To the front, you'll find a garage and a block-paved driveway, providing plenty of off-road parking

This home offers a fantastic opportunity to enjoy a seaside lifestyle in a peaceful location.

Room Dimensions

Lounge 20'2" x 11'5" (6.16 x 3.5)

Kitchen 12'4" x 7'10" (3.76 x 2.41)

Conservatory 15'6" x 6'2" (4.74 x 1.9)

Bedroom One 14'0" x 12'7" (4.28 x 3.86)

Bedroom Two 9'6" x 8'7" (2.91 x 2.62)

Bedroom Three 14'3" x 9'10" (4.36 x 3.0)

Bedroom Four 9'10" x 8'8" (3.0 x 2.65)

Garage 15'3" x 8'6" (4.67 x 2.6)

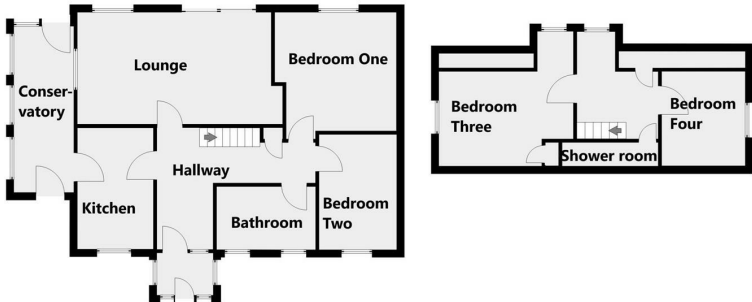

Energy Efficiency Rating		
	Current	Potential
Very energy efficient - lower running costs		
(92 plus) A		82
(81-91) B		
(69-80) C		65
(55-68) D		
(39-54) E		
(21-38) F		
(1-20) G		
Not energy efficient - higher running costs		
England & Wales	EU Directive 2002/91/EC	

Environmental Impact (CO ₂) Rating		
	Current	Potential
Very environmentally friendly - lower CO ₂ emissions		
(92 plus) A		
(81-91) B		
(69-80) C		
(55-68) D		
(39-54) E		
(21-38) F		
(1-20) G		
Not environmentally friendly - higher CO ₂ emissions		
England & Wales	EU Directive 2002/91/EC	

Important Notice: Particulars are prepared for marketing purposes only and should not be treated as a statement of the condition of any building, fixture or appliance. All measurements, floor plans and lease/ maintenance are approximate and not to be relied upon. Purchasers should make their own checks before relying on any of the information provided herein. * For double glazing and gas radiator heating, it is where specified.