



Instinct Guides You



## Dorchester Road, Weymouth Offers Over £170,000

- Duplex Apartment
- Short Stroll To Greenhill Beach
- Two Generous Bedrooms
- Well Presented Throughout
- Utility Room
- Allocated Parking
- Some Far Reaching Sea Views
- Pets Permitted By Request
- Close To A Range Of Amenities



Registration No. 08079158 Directors Mr Wilson, Mr Tominey

Courtesy Notice Upon using WilsonTominey as selling agents ensure we are made aware of contractual obligations you may be under. We can then proceed accordingly.

WilsonTominey Ltd  
15 Westham Rd.  
DT4 8NS

T 01305 775500  
E sales@wilsontominey.co.uk  
W www.wilsontominey.co.uk



Situated in the popular location of LODMOOR with a range of amenities nearby this well-presented two-bedroom apartment offers modern living set in a DUPLEX apartment in a grade II listed building. The home boasts OFF ROAD PARKING, some FAR REACHING VIEWS and an OPEN PLAN KITCHEN/DINER and a UTILITY ROOM.

The hub of the home is certainly the bright and airy living room that enjoys two windows illuminating the space wonderfully. The room is large enough for a range of furniture and thanks to its shape offers excellent storage.

The kitchen/diner has a welcoming feel thanks to its open plan layout and benefits from a range of fitted units with ample work surfaces and space for appliances and maintains the perfect amount of space for dining or entertaining. The room flows to a practical utility space offering additional storage.

The contemporary finish of the bathroom adds modernity to the home with large feature tiles set against a three-piece suite. The bathroom comprises a bath with shower over, wash hand basin and w.c.

Ascending upstairs are the two bedrooms. Bedroom one is a spacious double bedroom that spans the width of the home, two windows mirror the living room and from here they open to a far-reaching vista with some views of the sea. Bedroom two is a generous single bedroom with an integral cupboard and room for furnishings.

At the front of the property, the apartment has an allocated parking space.



## Room Dimensions

**Living Room 16'6" x 12'7" max (5.05 x 3.84 max)**

**Kitchen/Diner 11'2" x 10'9" (3.42 x 3.28 )**

**Bathroom 8'9" x 6'11" (2.68 x 2.13)**

**Utility Area 5'2" x 4'7" (1.58 x 1.42)**

**Bedroom One 14'10" into wardrobe x 9'8" max (4.54 into wardrobe x 2.97 max )**

### Lease & Maintenance Information

The vendor us the lease started at 120 years which commenced in 1982, with 1/7 share of freehold, and 78 years remaining, there is a service charge of £110pcm which is reviewed annually, and the property is grade two listed, and pets are permitted upon request.

PLEASE NOTE - The vendor is pursuing a lease extension to 999 years which be completed before completion takes place.

All details are to be checked with a solicitor before incurring any costs.

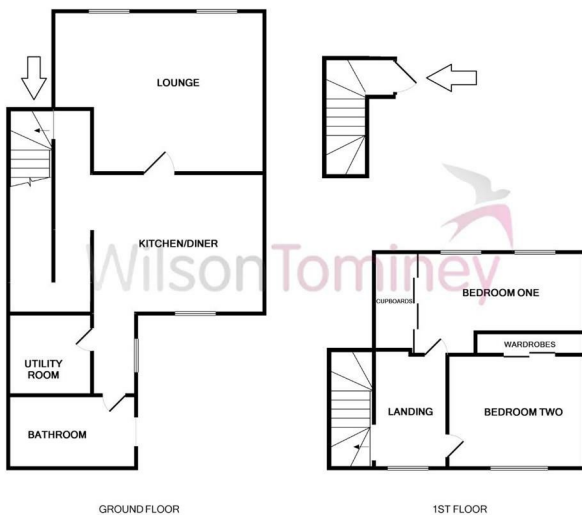

This Floor Plan is for guidance only and is NOT to SCALE

Energy Efficiency Rating		Current	Potential
Very energy efficient - lower running costs			
(92 plus)	A		
(81-91)	B		
(69-80)	C		
(55-68)	D		
(39-54)	E		
(21-38)	F		
(1-20)	G		
Not energy efficient - higher running costs			
England & Wales		EU Directive 2002/91/EC	74

Environmental Impact (CO <sub>2</sub> ) Rating		Current	Potential
Very environmentally friendly - lower CO <sub>2</sub> emissions			
(92 plus)	A		
(81-91)	B		
(69-80)	C		
(55-68)	D		
(39-54)	E		
(21-38)	F		
(1-20)	G		
Not environmentally friendly - higher CO <sub>2</sub> emissions			
England & Wales		EU Directive 2002/91/EC	

Important Notice: Particulars are prepared for marketing purposes only and should not be treated as a statement of the condition of any building, fixture or appliance. All measurements, floor plans and lease/ maintenance are approximate and not to be relied upon. Purchasers should make their own checks before relying on any of the information provided herein. \* For double glazing and gas radiator heating, it is where specified.