



Instinct Guides You



Queen Street, Weymouth Offers In Excess Of £75,000

- Excellently Proportioned
- Convenient Positioning
- Including Outside Space
- Unique Opportunity
- Central Location
- Two Tandem Garages



Registration No. 08079158 Directors Mr Wilson, Mr Tominey

Courtesy Notice Upon using WilsonTominey as selling agents ensure we are made aware of contractual obligations you may be under. We can then proceed accordingly.

WilsonTominey Ltd
15 Westham Rd.
DT4 8NS

T 01305 775500
E sales@wilsontominey.co.uk
W www.wilsontominey.co.uk



A unique opportunity to acquire substantial tandem length double garages, conveniently located within close proximity to Weymouth Town Centre.

The garages house space for approximately four vehicles and also boast some outside yard space to the rear. Both garages provide an abundance of space with excellent proportions with additional potential subject to necessary consents to either add an additional level or extend.

It is uncommon for garages of this size and capacity, located so centrally, to be available on the market.

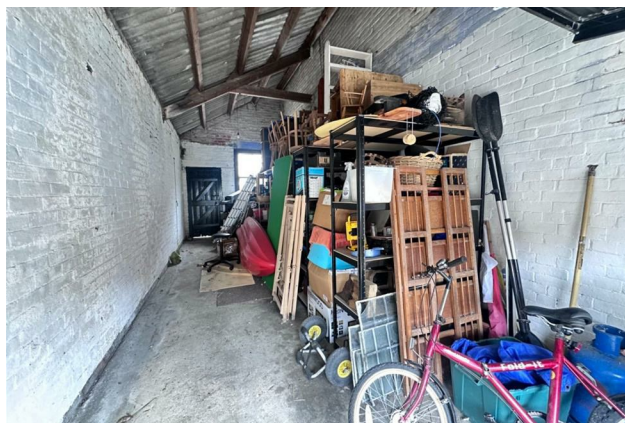

Room Dimensions

Garage One 28'6" x 9'1" (8.69 x 2.77)

Garage Two 29'0" x 9'2" (8.84 x 2.81)

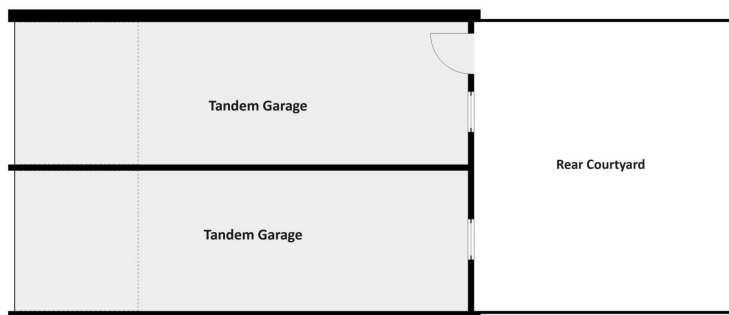

Energy Efficiency Rating		Current	Potential
Very energy efficient - lower running costs	(92 plus) A		
(81-91) B			
(69-80) C			
(55-68) D			
(39-54) E			
(21-38) F			
(1-20) G			
Not energy efficient - higher running costs			
England & Wales		EU Directive 2002/91/EC	

Environmental Impact (CO ₂) Rating		Current	Potential
Very environmentally friendly - lower CO ₂ emissions	(92 plus) A		
(81-91) B			
(69-80) C			
(55-68) D			
(39-54) E			
(21-38) F			
(1-20) G			
Not environmentally friendly - higher CO ₂ emissions			
England & Wales		EU Directive 2002/91/EC	

Important Notice: Particulars are prepared for marketing purposes only and should not be treated as a statement of the condition of any building, fixture or appliance. All measurements, floor plans and lease/ maintenance are approximate and not to be relied upon. Purchasers should make their own checks before relying on any of the information provided herein. * For double glazing and gas radiator heating, it is where specified.