

To Let



Flat 12, Bains Mansions, 2a Philpot Street, London, E1 2DW



Two Bedroom Apartment
£2,300 per calendar month

A modern two bedroom, two bathroom apartment in a period conversion located in the heart of cosmopolitan Whitechapel, offering a superb contemporary living space. Enviably located just a short distance from the City and on the doorstep of Spitalfields Market, Commercial Street and trendy Brick Lane, this stylish apartment is ideal for young professionals.



Viewings by appointment only
info@netlettings.com
0208 981 5551



Location & Transport

-  41 mins walk to Canary Wharf
-  25 mins walk to Liverpool Street
-  29 mins walk to Bank Station

-  Shadwell DLR Station - 9 mins
-  Whitechapel Station - 9 mins

-  14 mins to Canary Wharf - Watney Market (Stop F)
-  17 mins to Liverpool Street - Watney Market (Stop E)
-  22 mins to Bank - Watney Market (Stop E)

NET LETTINGS .COM

18 mins to Canary Wharf
14 mins to Liverpool Street
14 mins to Bank

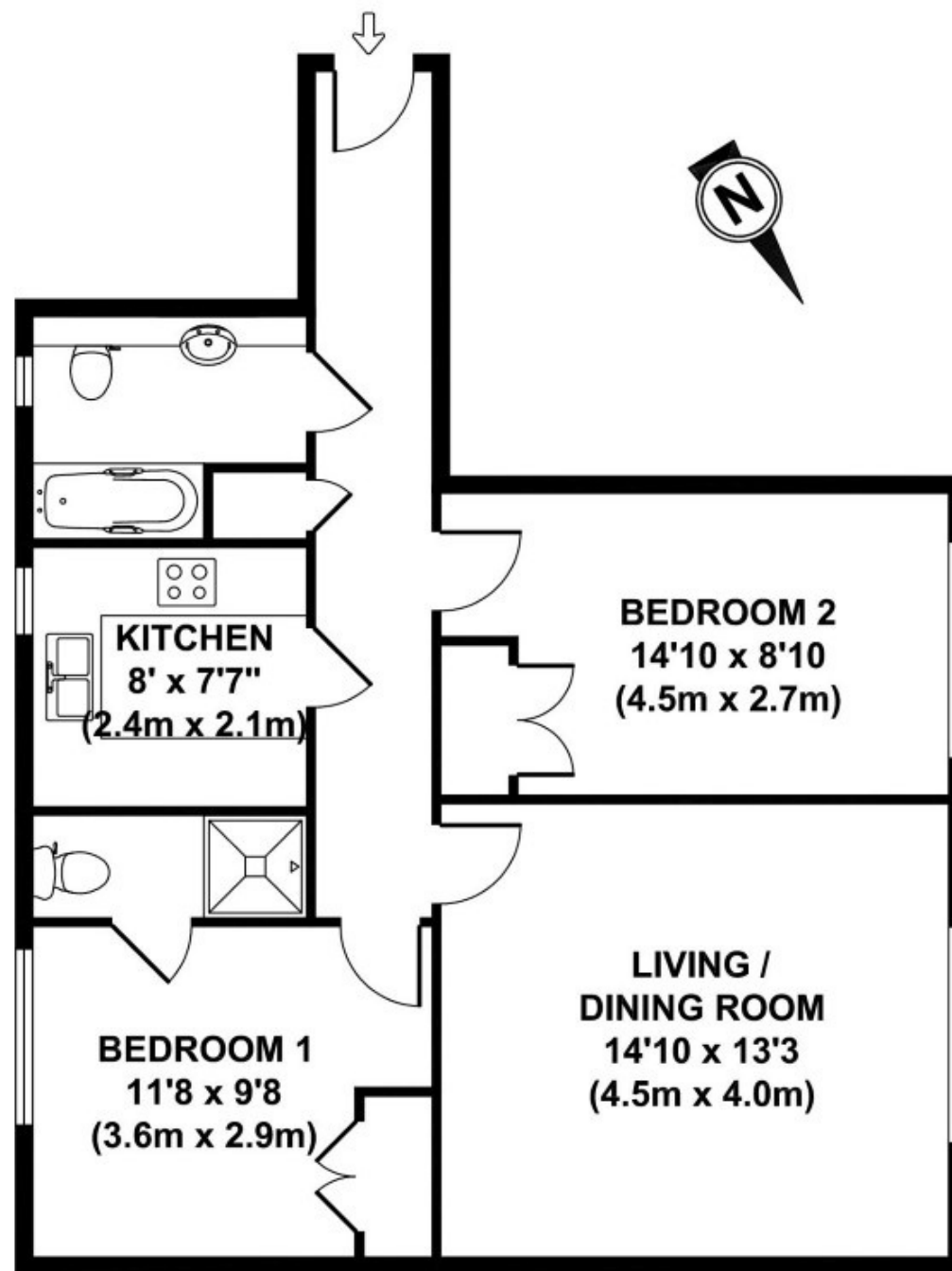

PHILPOT STREET

APPROX. GROSS INTERNAL FLOOR AREA 682 SQ FT / 64 SQ M



