



Flat 101, Simko House, Copperfield Road

London, E3 4RR

£2,100 pcm

Fees Apply

- Canal-Side Warehouse Conversion
- Open Plan Kitchen/Lounge
- Double Bedrooms, Master En-Suite
- Exposed Brickwork
- Overlooking Mile End Park
- Excellent Transport Links



1



2



2



Property Description

Simko House is a canal-side warehouse conversion in this highly desirable conservation area overlooking Mile End Park, this apartment is ideal for professionals. The apartment boasts two double bedrooms, master with fitted wardrobes and en-suite.

The property enjoys an open-plan living space with exposed brickwork and a ultra chic kitchen/diner with quartz worktops and all modern conveniences, wood floors, spotlights, gas central heating with vertical designer radiators and a modern neutral decor throughout. Finished to an extremely high standard this apartment will create a sumptuous style of living for the discerning professional. Offered furnished.

The green open spaces of Mile End Park are to hand and Mile End Stadium is just a stones throw. The accommodation is located in a Residential setting with swift links to the City and Docklands.

The closest underground station is Mile End (Central, District and Hammersmith & City lines). With Limehouse (Docklands Light Railway, British Rail) also within easy reach, while for motorists there is easy access to the A11 and A13 for routes out of London to the East.

Secure parking may also be available.

Please note: Furnishings have been provided for illustration purposes, actual furnishings supplied may vary.



SIMKO HOUSE, COPPERFIELD ROAD, E3

Approx. gross internal area

955 Sq Ft. / 88.7 Sq M.

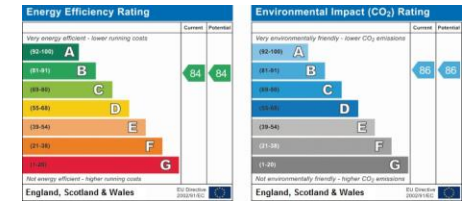
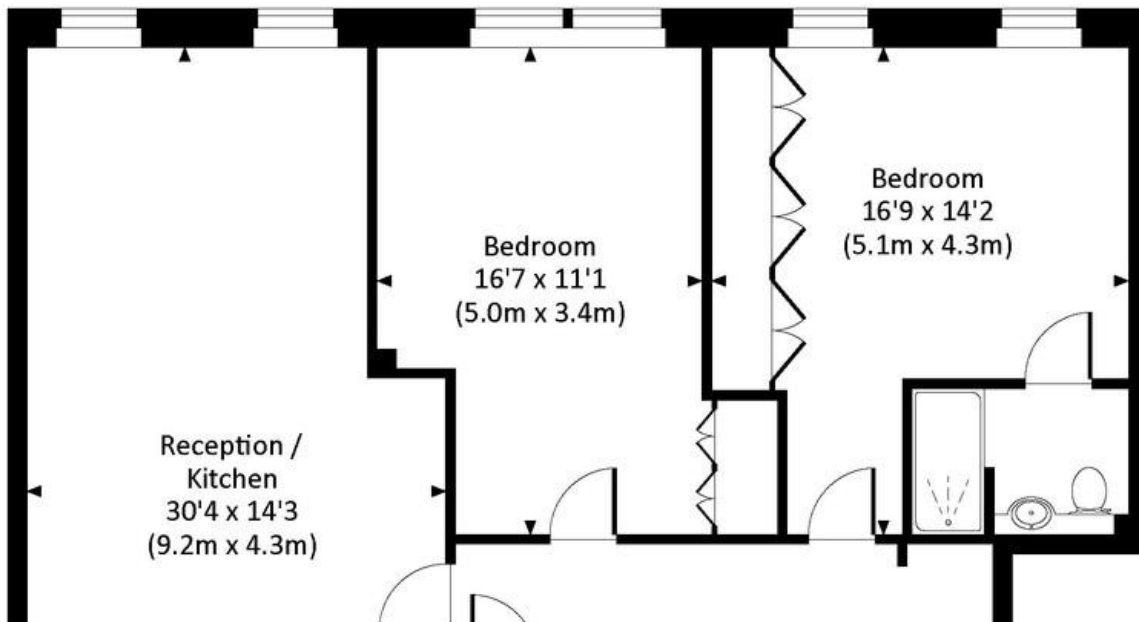

Find us on

[mydeposits.co.uk](https://www.mydeposits.co.uk)



[rightmove](https://www.rightmove.co.uk)
find your happy

[Zoopla.co.uk](https://www.zoopla.co.uk)

PrimeLocation



Registered Office

Suite C, 36-40 Copperfield Road,
London, E3 4RR /08050057

www.netlettings.com
management@netlettings.com
020 8981 5551

Agents Note: Whilst every care has been taken to prepare these particulars, they are for guidance purposes only. All measurements are approximate are for general guidance purposes only and whilst every care has been taken to ensure their accuracy, they should not be relied upon and potential tenants are advised to recheck the measurements.