



6 GILDA COURT

MILL HILL, NW7 2QN

£2,050 PER MONTH

A Three bedroom (no reception) second floor flat in purpose built flat located on the Watford Way, close to bus links & in walking distance of Middlesex University. Available 13th September 2025



JAYSON
RUSSELL

2ND FLOOR
622 sq.ft. (57.8 sq.m.) approx.

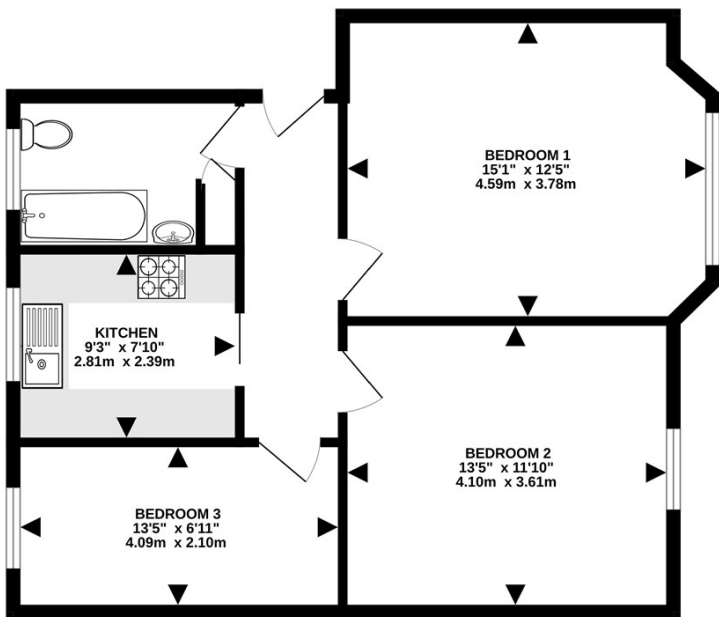

TOTAL FLOOR AREA: 622 sq.ft. (57.8 sq.m.) approx.

Whilst every attempt has been made to ensure the accuracy of the floorplan contained here, measurements of doors, windows, corners and any other items are approximate and no responsibility is taken for any error, omission or mis-statement. This plan is for illustrative purposes only and should be used as such by any prospective purchaser. The services, systems and appliances shown have not been tested and no guarantee as to their operability or efficiency can be given.
Made with Metropix ©2022

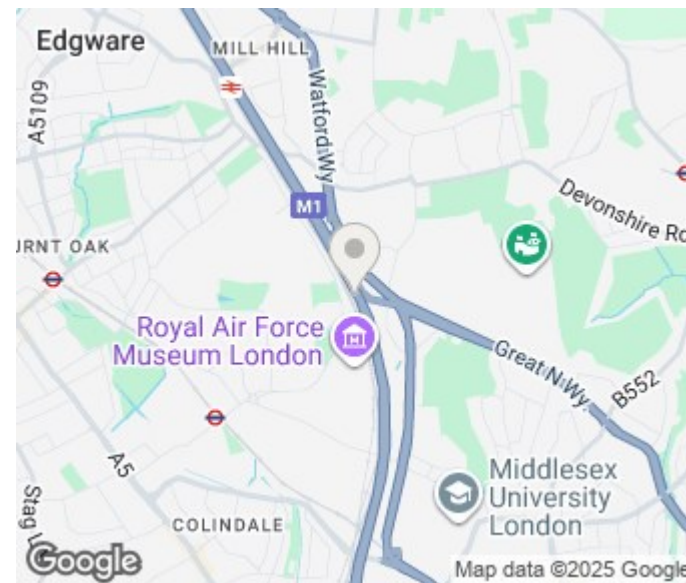

Energy Efficiency Rating		
	Current	Potential
Very energy efficient - lower running costs		
(92 plus) A		
(81-91) B		
(69-80) C		
(55-68) D	60	56
(39-54) E		
(21-38) F		
(1-20) G		
Not energy efficient - higher running costs		
England & Wales	EU Directive 2002/91/EC	

Agents Note: Whilst every care has been taken to prepare these particulars, they are for guidance purposes only. All measurements are approximate and are for general guidance purposes only and whilst every care has been taken to ensure their accuracy, they should not be relied upon and potential buyers/tenants are advised to recheck the measurements

Hendon Lettings
20 Parson Street
London
NW4 1QB

0208 202 1111
info@jaysonrussell.com
www.jaysonrussell.com

