



Warwick Road
Earls Court, SW5

CHESTERTONS





Set within one of Earls Court's most sought-after mansion blocks, this beautifully presented two-bedroom apartment blends classic period character with modern living.

- 2 bedrooms 1 bathroom
- Mansion block apartment
- Lower ground floor
- Over 1,200 square feet
- Lift and porter
- Close to Earls Court tube station

£3,150 pcm

Additional tenant charges apply (fees apply to non-AST tenancies only)

Tenancy Agreement Fee: £300

References per Tenant/Guarantor: £60

Inventory check (approx. £100 – £250 inc. VAT)

chestertons.co.uk/property-to-rent/applicable-fees

Minimum Term: 12 months
Deposit Required: £3,634.62
Local Authority: Kensington and Chelsea
Council Tax Band: F
EPC Rating: To be confirmed
Furnished

Chestertons South Kensington Lettings

44-48 Old Brompton Road
South Kensington
London
SW7 3DY

southkensingtonlettingsusers@chestertons.co.uk
02075891244

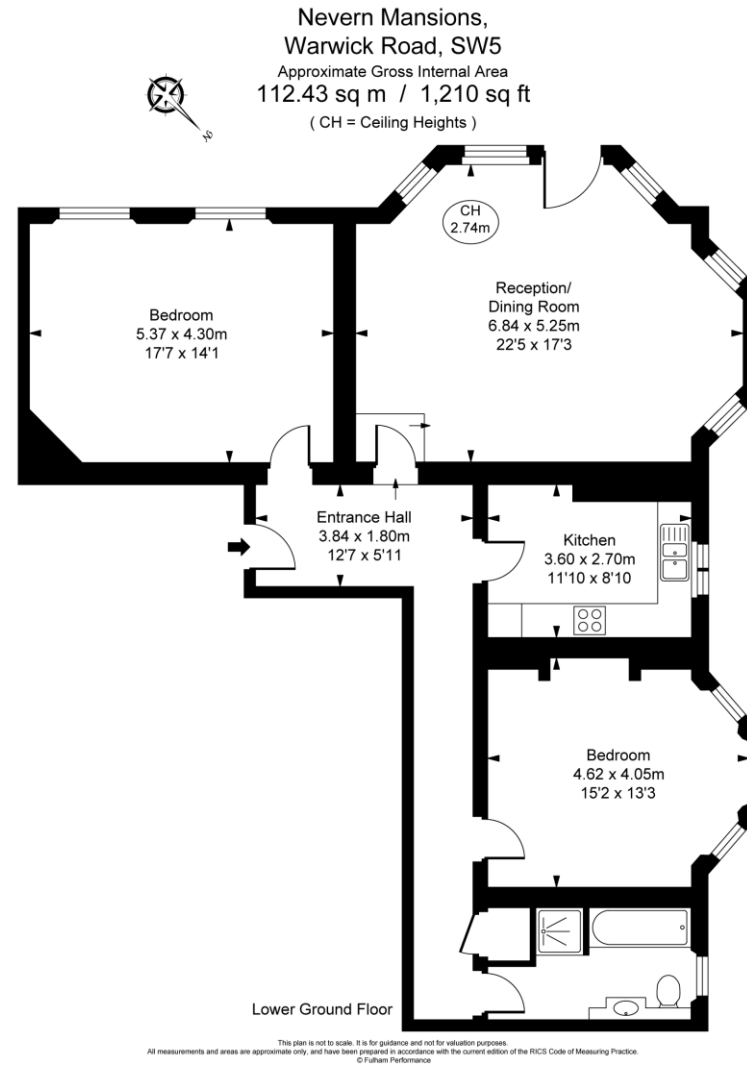

Chesterton UK Services Limited trading as Chestertons for themselves and for the vendor of this property whose agents they are, give notice that (i) these particulars do not constitute any part of an offer or contract, (ii) all statements contained within these particulars are made without responsibility on the part of Chestertons or the vendor, (iii) whilst made in good faith, none of the statements contained within these particulars are to be relied upon as a statement or representation of fact, (iv) any intending purchasers must satisfy themselves by inspection or otherwise as to the correctness of each of the statements contained within these particulars, (v) the vendor does not make or give either Chestertons or any person in their employment any authority to make or give representation or warranty whatsoever in relation to this property. Wide angle lenses may be used. ©Copyright Chestertons | Chesterton Global Ltd | Registered Office 40 Connaught Street, Hyde Park, London W2 2AB Registered Company Number 05334580.

