



Trebovir Road  
Earls Court, SW5

CHESTERTONS







A spacious and charming studio that has come onto the market for rentals. The self contained Studio apartment has excellent floor space, a kitchen, fully fitted bathroom and separate utility cupboard.

The property is available on a furnished basis only and is professionally managed. With the property being moments from Earls Court tube station and local amenities, this is the perfect home for a single professional or student.

Earls Court has excellent transport throughout London, as well as bars, restaurants and supermarkets.

- Studio apartment
- Furnished
- Approx. 250 sqft
- Close to Earls Court tube station

### £1,495 pcm

Additional tenant charges apply (fees apply to non-AST tenancies only)

Tenancy Agreement Fee: £300

References per Tenant/Guarantor: £60

Inventory check (approx. £100 – £250 inc. VAT)

[chestertons.co.uk/property-to-rent/applicable-fees](http://chestertons.co.uk/property-to-rent/applicable-fees)

Energy Efficiency Rating		Current	Potential
Very energy efficient - lower running costs	A		
Energy efficient - lower running costs	B		
Decent energy efficiency - lower running costs	C		
Some energy efficiency - lower running costs	D		
Not very energy efficient - higher running costs	E		
Not energy efficient - higher running costs	F		
Not energy efficient - higher running costs	G		
EU Directive 2002/91/EC			
England, Scotland & Wales			

**Minimum Term:** 12 months  
**Deposit Required:** £1,725.00  
**Local Authority:** Royal Borough of Kensington & Chelsea  
**Council Tax Band:** C  
**EPC Rating:** D  
**Furnished**

### Chestertons South Kensington Lettings

44-48 Old Brompton Road  
 South Kensington  
 London  
 SW7 3DY

[southkensington@chestertons.co.uk](mailto:southkensington@chestertons.co.uk)  
 02075891244



Faris House,  
Trebovir Road, SW5  
Approximate Gross Internal Area  
16.79 sq m / 181 sq ft

( CH = Ceiling Heights )

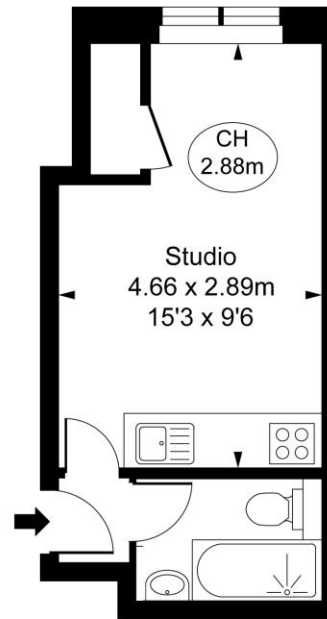

Third Floor

This plan is not to scale. It is for guidance and not for valuation purposes.  
All measurements and areas are approximate only, and have been prepared in accordance with the current edition of the RICS Code of Measuring Practice.  
© Fulham Performance

Chesterton Global Ltd trading as Chestertons for themselves and for the vendor of this property whose agents they are, give notice that (i) these particulars do not constitute any part of an offer or contract, (ii) all statements contained within these particulars are made without responsibility on the part of Chestertons or the vendor, (iii) whilst made in good faith, none of the statements contained within these particulars are to be relied upon as a statement or representation of fact, (iv) any intending purchasers must satisfy themselves by inspection or otherwise as to the correctness of each of the statements contained within these particulars, (v) the vendor does not make or give either Chestertons or any person in their employment any authority to make or give representation or warranty whatsoever in relation to this property. Wide angle lenses may be used. ©Copyright Chestertons | Chesterton Global Ltd | Registered Office 40 Connaught Street, Hyde Park, London W2 2AB Registered Company Number 05334580.



This paper is  
100% recyclable