



Trebovir Road  
Earls Court, SW5

CHESTERTONS





A spacious and charming studio that has come onto the market for rentals. The self contained Studio apartment has excellent floor space, a kitchen, fully fitted bathroom and separate utility cupboard.

The property is available on a furnished basis only and is professionally managed. With the property being moments from Earls Court tube station and local amenities, this is the perfect home for a single professional or student.

Earls Court has excellent transport throughout London, as well as bars, restaurants and supermarkets.

- Studio apartment
- Furnished
- Approx. 250 sqft
- Close to Earls Court tube station

### £1,400 pcm

Additional tenant charges apply (fees apply to non-AST tenancies only)

Tenancy Agreement Fee: £300

References per Tenant/Guarantor: £60

Inventory check (approx. £100 – £250 inc. VAT)

[chestertons.co.uk/property-to-rent/applicable-fees](http://chestertons.co.uk/property-to-rent/applicable-fees)

Energy Efficiency Rating		Current	Potential
100-105	A		
81-100	B		
69-81	C	76	81
55-69	D		
39-55	E		
21-39	F		
1-21	G		

Not energy efficient - higher running costs

EU Directive 2002/91/EC

**Minimum Term:** 6 months  
**Deposit Required:** £1,615.38  
**Local Authority:** Royal Borough of Kensington & Chelsea  
**Council Tax Band:** C  
**EPC Rating:** C  
**Furnished**

*Chestertons South Kensington Lettings*

44-48 Old Brompton Road  
 South Kensington  
 London  
 SW7 3DY

[southkensington@chestertons.co.uk](mailto:southkensington@chestertons.co.uk)  
 02075891244

## Faris House, SW5

Approximate gross internal area

247 sq ft / 22.95 sq m

Key :  
CH - Ceiling Height

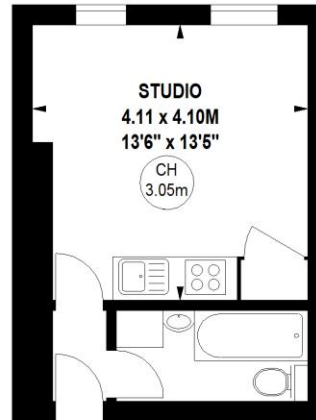
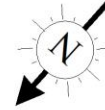

### Third Floor

The floor plan is not to scale and measurements and areas shown are approximate and therefore should be used for illustrative purposes only. The plan has been prepared in accordance with the RICS code of Measuring Practice and whilst we have confidence in the information produced, it must not be relied on. If there is any aspect of particular importance, you should carry out or commission your own inspection of the property.  
Copyright of FeaturePRO.

