



Sheen Court

Richmond, TW10

Asking Price £425,000

Offered with no chain, a share of the free hold and a long lease, is this wonderful two double bedroom third floor flat within a very sought after private development close to Richmond.

The flat is located on the top floor and benefits from a good size west facing balcony overlooking the attractive grounds. There is a spacious dual aspect sitting room as well as two generous double bedrooms, all enjoying the original parquet wooden flooring. There is a kitchen and bathroom which require modernisation and a storage cupboard in the hallway.

Sheen Court is popular development with parking and beautifully kept communal grounds. It's located close to North Sheen station (0.7 miles) and is a short bus journey to Richmond Town Centre. There are a number of outstanding schools locally and Richmond Park is 1.3m away from the property.

CHESTERTONS



Sheen Court

Richmond, TW10

- Two Double Bedroom
- Sought after development
- Share of freehold
- Requires modernisation
- No chain



Tenure: Share of Freehold
Service Charge: £1346
Ground Rent: £25 pa
Local Authority: London Borough Of Richmond Upon Thames
Council Tax Band: D

Score	Energy rating	Current	Potential
92+	A		
81-91	B		
69-80	C		
55-68	D	61 D	73 C
39-54	E		
21-38	F		
1-20	G		

Chestertons East Sheen Sales

254A Upper Richmond Road West
East Sheen
London
SW14 8AG
sheen@chestertons.co.uk
020 8104 0580
chestertons.co.uk

Sheen Court, Richmond, Surrey, TW10

○ - Ceiling Height

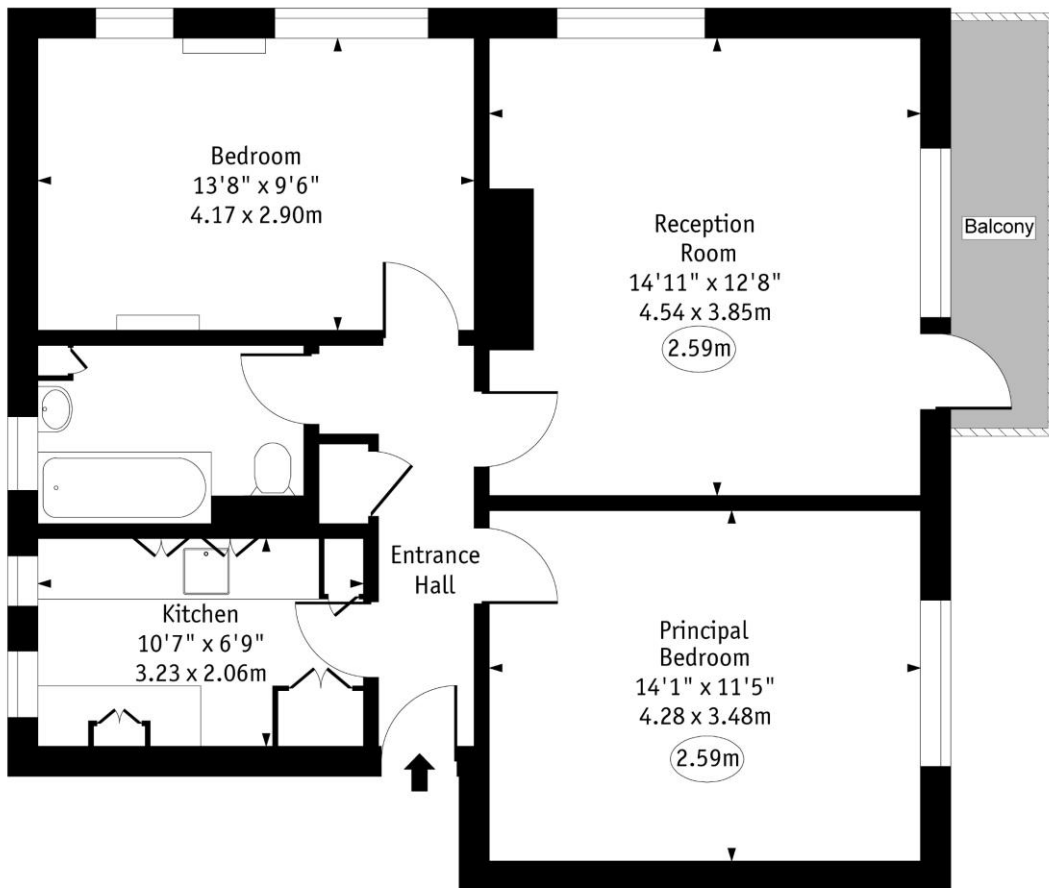

Third Floor

Approx Gross Internal Area 715 Sq Ft - 66.46 Sq M

Every attempt has been made to ensure the accuracy of the floor plan shown. However, all measurements, fixtures, fittings, and data shown are approximate interpretations and for illustrative purposes only. Measured according to the RICS. Not To Scale.

www.goldlens.co.uk
Ref. No. 029087WiH

