



Upper Richmond Road West

East Sheen, SW14

Guide Price £475,000

A beautifully presented light and attractive garden flat near the centre of Sheen. The open plan kitchen and reception room has bi-fold doors opening onto a large private decked patio and lawned garden.



Upper Richmond Road West

East Sheen, SW14

- One bedroom garden flat
- Private garden
- Separate reception room/study area
- Open plan kitchen extension



A beautifully presented one bedroom garden flat in the centre of East Sheen.

Located on the ground floor light floods through the extended roof on to a fitted open plan kitchen and through bi-fold doors you access a stunning garden with decking and seating area and lawn with gate leading out to a back passageway. This passageway is often used by the owner for access, it's secure and can be very handy for bringing bikes to the back of the property and moving large items

This lovely light and well finished home has a double bedroom with a light well and walk-in wardrobe. You can access the stylish bathroom with underfloor heating through the bedroom and living area and in the centre of the flat is a seating area, which can also be flexibly used as a guest sleeping or work from home study area with shutters that open out to incorporate it in to the kitchen/dining room which also has underfloor heating. A Nest system controls the boiler system in the flat.

The flat is located a short distance to Mortlake Station, the parks of Sheen including Richmond Park and the shops, cafe's and supermarkets in the town centre.

Tenure: Leasehold 91 years 11 months

Service Charge: £75

Ground Rent: £200

Local Authority: Richmond upon Thames

Council Tax Band: C

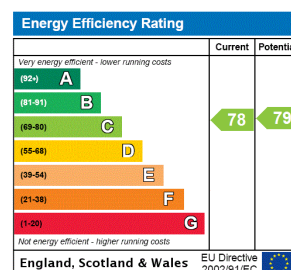

Chestertons East Sheen Sales

254A Upper Richmond Road West

East Sheen

London

SW14 8AG

sheen@chestertons.co.uk

020 8104 0580

chestertons.co.uk

Upper Richmond Road West, SW14

Approximate gross internal area

51.19 sq m / 551 sq ft

Key :
CH - Ceiling Height

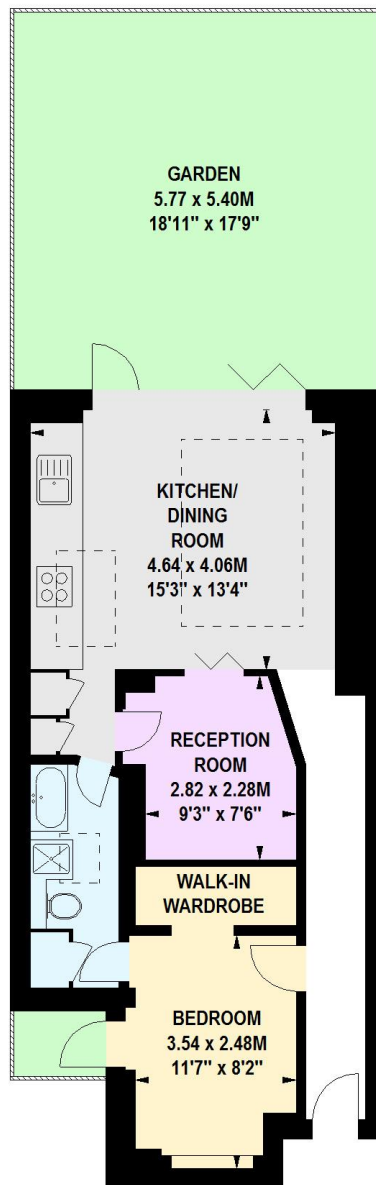
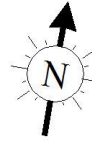

Ground Floor

This floor plan is a representation for guidance purposes only, not for valuation.
Any figure is approximate and must not be relied on as a statement of fact.
Copyright of Wyatt Dixon Homes

