



7 LEYBURN CLOSE

MASHAM, RIPON, HG4 4HB

£900 PCM

Recently modernised Semi Detached House situated within easy walking distance of Masham town centre. The spacious well appointed accommodation comprises, hall, sitting room, kitchen, utility, downstairs bathroom, landing, 3 bedrooms, WC, uPVC double glazing, gas central heating, gardens, off street parking to the rear.

NORMAN F. BROWN

Est. 1967

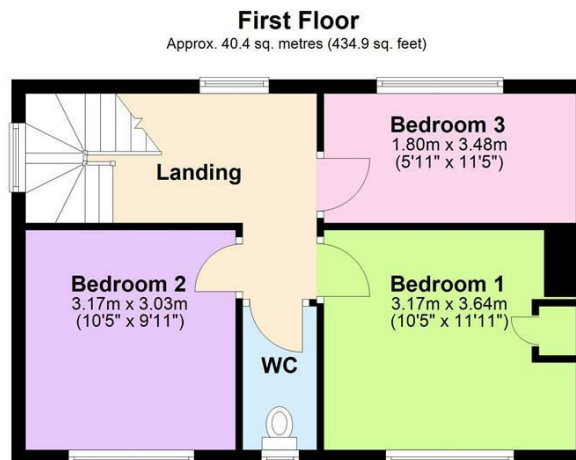

Total area: approx. 91.6 sq. metres (986.4 sq. feet)



Energy Efficiency Rating		
	Current	Potential
Very energy efficient - lower running costs		
(92 plus) A		
(81-91) B		82
(69-80) C	66	
(55-68) D		
(39-54) E		
(21-38) F		
(1-20) G		
Not energy efficient - higher running costs		
England & Wales	EU Directive 2002/91/EC	

Agents Note: Whilst every care has been taken to prepare these particulars, they are for guidance purposes only. All measurements are approximate and are for general guidance purposes only and whilst every care has been taken to ensure their accuracy, they should not be relied upon and potential buyers/tenants are advised to recheck the measurements

Bedale Office Lettings
6 Bridge Street
Bedale
North Yorkshire
DL8 2AD

01677 422282
bedale@normanfbrown.co.uk
www.normanfbrown.co.uk

NORMAN F.BROWN

Est. 1967