



65 ASH TREE CLOSE BEDALE, DL8 1UJ

£725 PCM

A well presented two bedroom semi detached home located in a quiet cul de sac. The property has a modern style including a contemporary bathroom and kitchen and has benefits including a garage with off street parking, enclosed rear garden, a gas fired heating system and double glazed windows.

NORMAN F. BROWN

Est. 1967

65 ASH TREE CLOSE

- RENT - £735pcm in advance, exclusive of rates/all outgoing if the Landlord agrees to a pet • No Smoking • EPC Rating D (68) • Council Tax Band 'B' • Holding Deposit - £167 (equivalent to 1 weeks rent) to be transferred to Tenancy Deposit if tenancy proceeds • Tenancy Deposit: £835



TERM

6/12 Months Certain (Assured Shorthold Tenancy).

RENT

£725 per calendar month in advance, exclusive of rates and all other outgoing.

£735 per calendar month in advance, exclusive of rates and all other outgoing if the Landlord agrees to the tenant having a pet.

HOLDING DEPOSIT

£167 (equivalent to 1 weeks rent) to be transferred to Tenancy Deposit if tenancy Proceeds

BOND

£835

CONTENTS INSURANCE

The tenant is responsible for arranging their own contents insurance.

APPLICATION PROCESS & FEES

All applicants shall be requested to complete detailed application forms. We shall undertake comprehensive reference checks which will include right to rent ID checks in accordance with the Immigration Act 2014. In accordance with the Tenant Fees Act 2019 we request that the prospective tenant(s), to reserve the property and to demonstrate commitment to rent the property whilst reference checks take place, pays a holding deposit to ourselves which is equivalent to not more than one week's rent, which shall be put towards the deposit

payable at the start of the tenancy (and shall be held subject to conditions, further details upon request).

We are a member of the, The Property Ombudsman, Milford House, 43-55 Milford Street, Salisbury, SP1 2BP, telephone number 01722333306, fax number 01722332296, email admin@tpos.co.uk, website www.tpos.co.uk

Our clients account details are as follows: NFB & DB & JF Brown Clients Account At Barclays Bank, Market Place, Richmond. This account is not interest bearing.

As members of the Royal Institution of Chartered Surveyors (RICS) we carry out a monthly reconciliation of our clients account and are activities are subject to monitoring under the institutions conduct and disciplinary regulations. The RICS operates a client's money protection scheme of which we are a member (further details available upon request).

RESTRICTIONS

No Smokers. 1 Pet will be considered.

Please note you must have earnings/income of £21,750 pa or more to qualify to apply for this property. You must also be able to move within 6 weeks of applying.

NOTE

FIRST MONTH'S RENT AND BOND TO BE PAID BY
DIRECT TRANSFER INTO OUR CLIENTS
ACCOUNT IN ADVANCE OF THE TENANCY START
DATE

65 ASH TREE CLOSE



Ground Floor

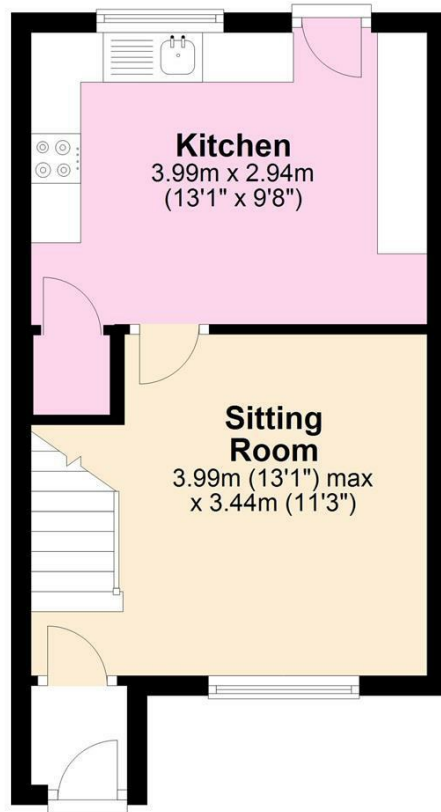

First Floor

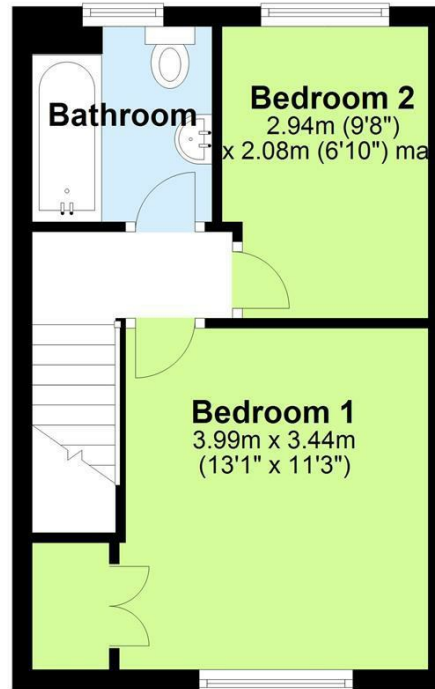

Energy Efficiency Rating		Current	Potential
Very energy efficient - lower running costs			
(92 plus) A			89
(81-91) B			
(69-80) C		68	
(55-68) D			
(39-54) E			
(21-38) F			
(1-20) G			
Not energy efficient - higher running costs			
England & Wales		EU Directive 2002/91/EC	

Agents Note: Whilst every care has been taken to prepare these particulars, they are for guidance purposes only. All measurements are approximate and are for general guidance purposes only and whilst every care has been taken to ensure their accuracy, they should not be relied upon and potential buyers/tenants are advised to recheck the measurements

Bedale Office Lettings
6 Bridge Street
Bedale
North Yorkshire
DL8 2AD

01677 422282
bedale@normanfbrown.co.uk
www.normanfbrown.co.uk

NORMAN F. BROWN

Est. 1967