



18 NEWSTEADS, AISKEW
BEDALE, DL8 1BD

£185,000
FREEHOLD

An excellent three bedroom town house located close to the Bedale town centre offering a great layout over three floors plus an allocated parking space, rear garden, gas fired heating and double glazing. With a stylish interior, this lovely home is will suit a variety of different lifestyles.

NORMAN F. BROWN

Est. 1967

Ground Floor

Approx. 32.8 sq. metres (352.7 sq. feet)

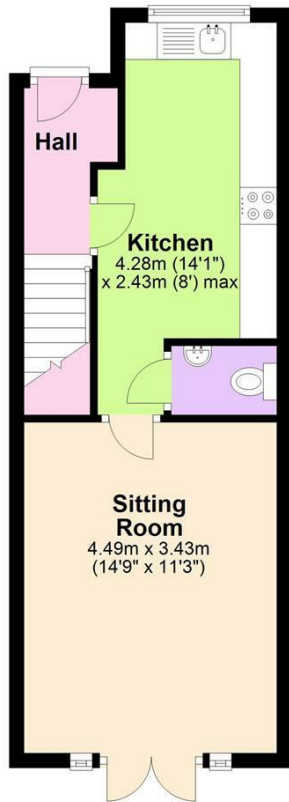

First Floor

Approx. 30.9 sq. metres (333.0 sq. feet)

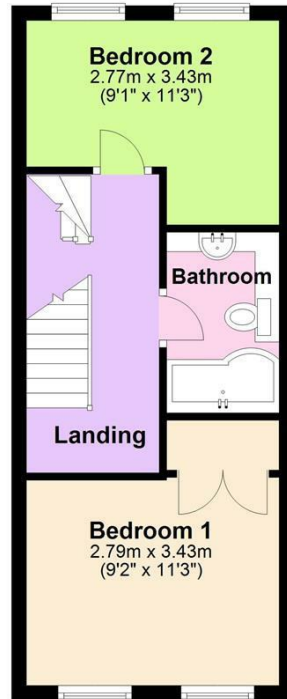

Second Floor

Approx. 18.4 sq. metres (197.9 sq. feet)

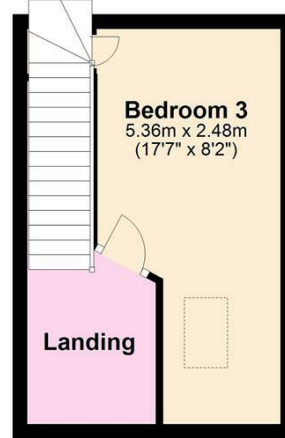

Total area: approx. 82.1 sq. metres (883.6 sq. feet)



Energy Efficiency Rating		
	Current	Potential
Very energy efficient - lower running costs		
(92 plus) A		90
(81-91) B	78	
(69-80) C		
(55-68) D		
(39-54) E		
(21-38) F		
(1-20) G		
Not energy efficient - higher running costs		
England & Wales	EU Directive 2002/91/EC	

Agents Note: Whilst every care has been taken to prepare these particulars, they are for guidance purposes only. All measurements are approximate and are for general guidance purposes only and whilst every care has been taken to ensure their accuracy, they should not be relied upon and potential buyers/tenants are advised to recheck the measurements

Bedale Office Sales
6 Bridge Street
Bedale
North Yorkshire
DL8 2AD

01677 422282
bedale@normanfbrown.co.uk
www.normanfbrown.co.uk

NORMAN F. BROWN

Est. 1967