



**FLOOR LAYOUT**

Not to Scale - For Identification Purposed Only

CELLAR  
182 sq.ft. (16.9 sq.m.) approx.

GROUND FLOOR  
440 sq.ft. (40.9 sq.m.) approx.

1ST FLOOR  
426 sq.ft. (39.5 sq.m.) approx.

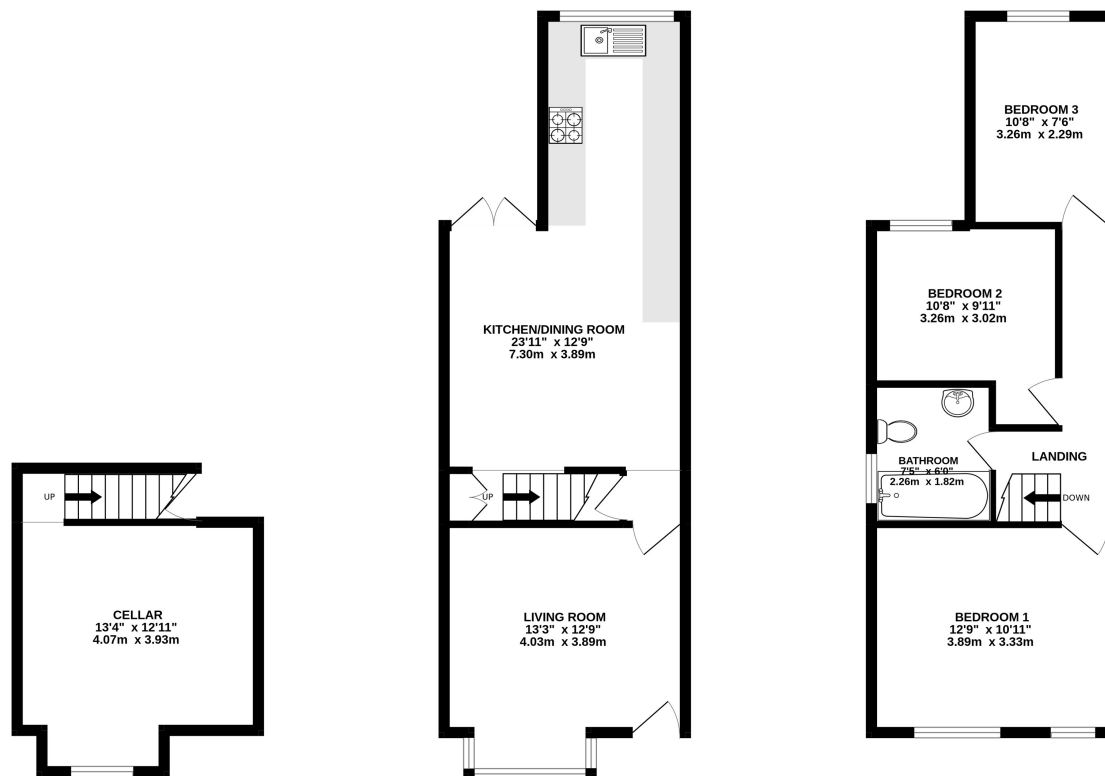

TOTAL FLOOR AREA: 1047 sq.ft. (97.3 sq.m.) approx.

Whilst every attempt has been made to ensure the accuracy of the floorplan contained here, measurements of doors, windows, rooms and any other items are approximate and no responsibility is taken for any error, omission or mis-statement. This plan is for illustrative purposes only and should be used as such by any prospective purchaser. The services, systems and appliances shown have not been tested and no guarantee as to their operability or efficiency can be given.  
Made with Metropix ©2022

[www.edwardmellor.co.uk](http://www.edwardmellor.co.uk)

134, Castle Street, SK3 9JH  
T: 0161 476 2112  
E: [edgeley@edwardmellor.co.uk](mailto:edgeley@edwardmellor.co.uk)



*The agent has not tested apparatus, equipment, fittings or services and so cannot verify they are in working order or fit for their purpose. The buyer is advised to obtain verification from their Solicitor or Surveyor. Photographs are reproduced for general information and it must not be inferred that any item is included for sale with the property. Please note that all measurements are approximate. These particulars are issued on the understanding that any negotiations in regard to this property are carried out through Edward Mellor Ltd. This property is offered subject to not being sold or withdrawn on receipt of reply. These particulars are believed to be correct but do not form a contract for sale. None of the statements contained in these particulars as to this property are to be relied on as statements or representations of fact. The vendor does not make or give, and neither Edward Mellor Ltd. nor any person in their employment has any authority to make or give, any representation or warranty in relation to this property.*





## Features

- Beautifully Presented Throughout.
- Hi-Spec Integrated Kitchen.
- Three Well Proportioned Bedrooms.
- 2 Reception Rooms
- Brimming With Charm & Character

A wonderfully presented, bay fronted, three bedroom property offering a perfect blend of classic period features combined with modern style and wonderful presentation. Situated on a desirable road within the popular residential area of Edgeley the property is considered a perfect home for both first time buyers and

growing families. The property has been updated & decorated to a very high standard and should be viewed without delay. An internal inspection will reveal: A welcoming living room with feature fireplace, a sociable dining room with French patio doors and an open aspect to a recently upgraded, hi-spec integrated kitchen. On the first floor you will

find three well proportioned bedrooms and a charming three piece bathroom. Other features include full UPVC double glazing, gas central heating with combi boiler, a useful single chambered cellar and an enclosed lawned garden to the rear. Call to register your interest NOW!!



The accommodation on offer briefly comprises:: A welcoming living room with feature central fireplace, a sociable dining room with French patio doors and an open aspect to a recently upgraded, hi-spec integrated kitchen. On the first floor you will find three well proportioned bedrooms and a charming three piece bathroom. Other features include full UPVC double glazing, gas central heating with combi boiler, a useful single chambered cellar and an enclosed lawned garden to the rear. Call to register your interest NOW!! Directions from Edward Mellors in Edgeley: proceed along Edgeley Road turning right onto Northgate Road where the property can be located on the right hand side just before Chatham Street.

