



## FLOOR LAYOUT

Not to Scale - For Identification Purposes Only

GROUND FLOOR  
371 sq.ft. (34.5 sq.m.) approx.

1ST FLOOR  
368 sq.ft. (34.2 sq.m.) approx.

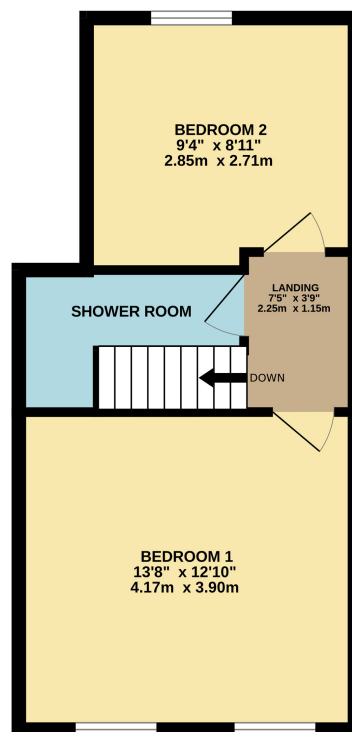
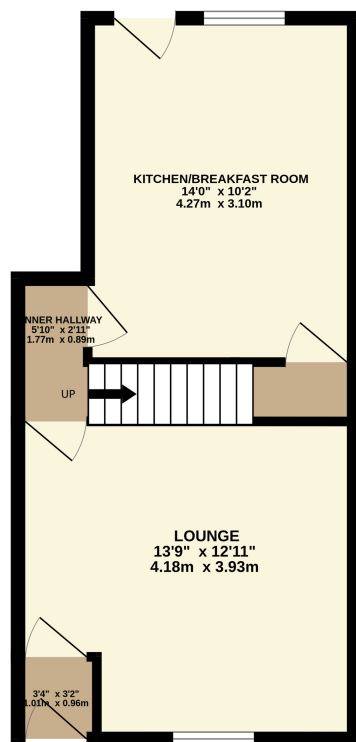

TOTAL FLOOR AREA: 739 sq.ft. (68.7 sq.m.) approx.

Whilst every attempt has been made to ensure the accuracy of the floorplan contained here, measurements of doors, windows, rooms and any other items are approximate and no responsibility is taken for any error, omission or mis-statement. This plan is for illustrative purposes only and should be used as such by any prospective purchaser. The services, systems and appliances shown have not been tested and no guarantee as to their operability or efficiency can be given.  
Made with Metropix ©2024

[www.edwardmellor.co.uk](http://www.edwardmellor.co.uk)

182, London Road, SK7 4DQ  
T: 0161 456 6000  
E: [hazelgrove@edwardmellor.co.uk](mailto:hazelgrove@edwardmellor.co.uk)



*The agent has not tested apparatus, equipment, fittings or services and so cannot verify they are in working order or fit for their purpose. The buyer is advised to obtain verification from their Solicitor or Surveyor. Photographs are reproduced for general information and it must not be inferred that any item is included for sale with the property. Please note that all measurements are approximate. These particulars are issued on the understanding that any negotiations in regard to this property are carried out through Edward Mellor Ltd. This property is offered subject to not being sold or withdrawn on receipt of reply. These particulars are believed to be correct but do not form a contract for sale. None of the statements contained in these particulars as to this property are to be relied on as statements or representations of fact. The vendor does not make or give, and neither Edward Mellor Ltd. nor any person in their employment has any authority to make or give, any representation or warranty in relation to this property.*



### Features

- Superb 2 Bedroom Period Terraced
- Central Hazel Grove Location
- Bathed in Period Charm & Character
- Attractively Fitted Kitchen & Shower Room
- Delightful Enclosed Garden

Call Now To Book Your Viewing Slot For Our Open Day Event Saturday 7th September. - Welcome to Chapel Street in the heart of Hazel Grove. This superbly presented 2 double bedroom period terraced combines the perfect blend of period charm and character with a "chic" and stylish interior and is

ideally suited to a First Time Buyer. The property is simply ready to move into and offers accommodation over 2 good size floors as well as pleasant gardens to the front and rear which provide the perfect space for outdoor entertaining. In addition, there is an attractively fitted breakfast kitchen and

a recently fitted 3 piece shower room. The property is ideally situated within easy access of every day amenities in Hazel Grove centre including shops, schools and good public transport links. Viewing highly recommended.

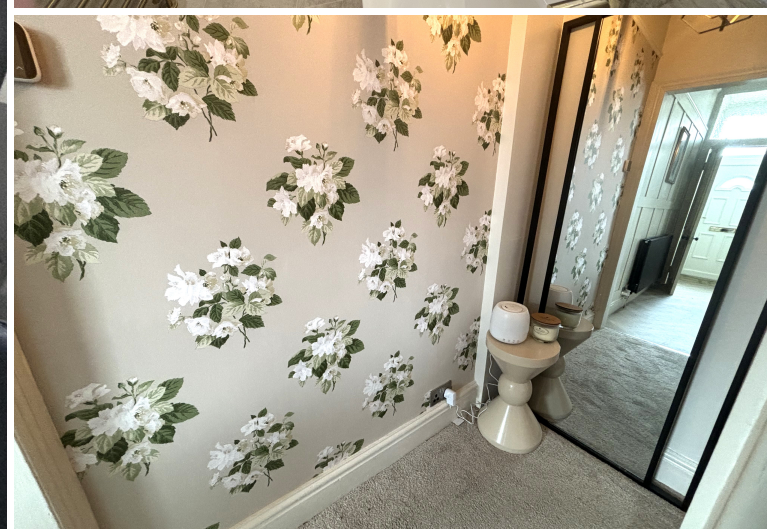

The accommodation on offer briefly comprises : Enclosed entrance porch, front living room with decorative wall panelling and feature period fireplace, inner hallway with stairs to the first floor and attractively fitted breakfast kitchen with ample room for dining. At first floor level, a landing leads to 2 great size double bedrooms and a superbly fitted 3 piece shower room. The rear garden is low maintenance and offers the ideal outdoor space for entertaining family and friends and has a useful brick built outbuilding for additional storage.

