



Woodgrove Court | Hazel Grove | SK7 4GD

EDWARD
mellor



Features

- Fabulous 2 Bedroom Retirement Apartment
- Available With No Chain
- Superbly Fitted Kitchen & Bathroom
- 2 Double Bedrooms + Dressing Room
- Garage

Woodgrove Court is a recently built select development of retirement apartments for the over 60s, situated in the heart of Hazel Grove adjacent to Sainsburys Superstore and Chemists. The original development was constructed by McCarthy & Stone and this

particular apartment forms part of the new development constructed in 2007 with a high standard of fittings and larger layout. Inside, you will find that a warm and friendly atmosphere exists among its residents with an emphasis of independent living and care of the

highest standard through the 24 hour care line and house manager facility. This is an exciting opportunity to acquire a first floor two bedroom apartment which is serviced by either lift or stairs and enjoys views via a "Juliet balcony" from the ample size living room.



The apartment is available with no vendor chain and has been attractively priced so an early inspection is highly recommended. The development benefits from a video security entry system, residents lounge, guest suite, laundry, electric storage heating, uPVC double glazing, modern fitted kitchen and bathroom facilities, pleasant communal gardens, parking and is one of the few apartments to have its own garage. The accommodation on offer briefly comprises secure communal entrance door and communal areas, private entrance door, entrance hall with ample storage, living room with feature Juliet balcony, attractively fitted kitchen with integrated appliances, superbly fitted shower room and 2 double bedrooms (one with a walk in wardrobe and an adjoining dressing room).



FLOOR LAYOUT

Not to Scale - For Identification Purposes Only

FIRST FLOOR
692 sq.ft. (64.3 sq.m.) approx.

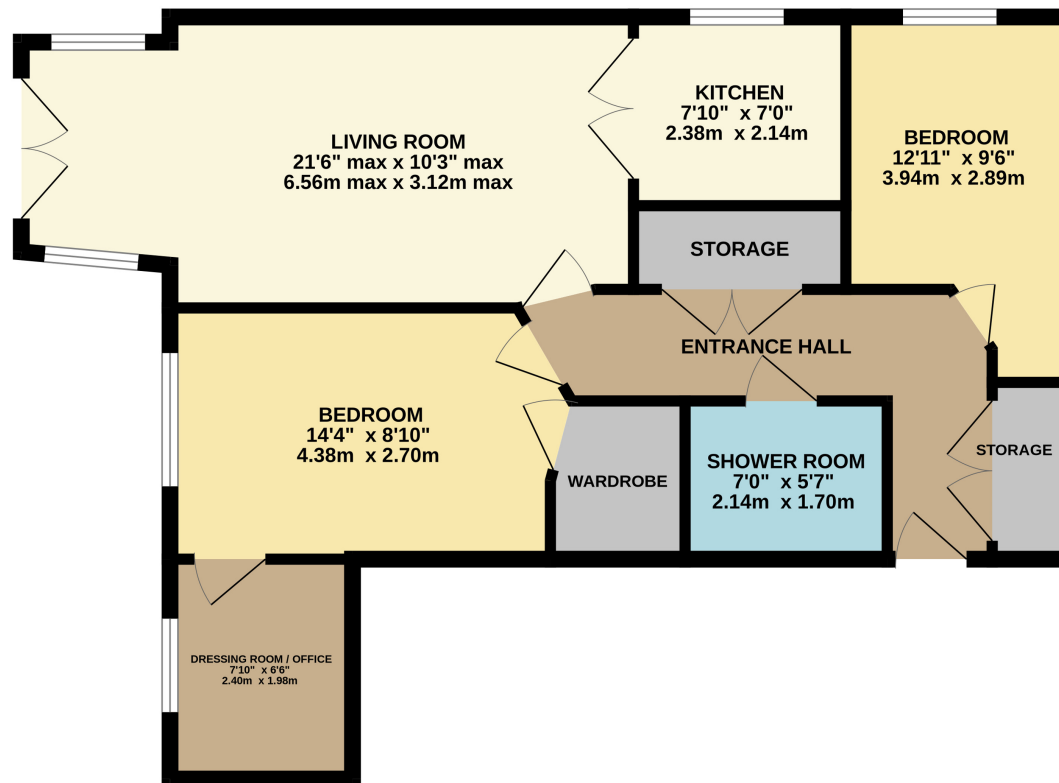

TOTAL FLOOR AREA : 692 sq.ft. (64.3 sq.m.) approx.

Whilst every attempt has been made to ensure the accuracy of the floorplan contained here, measurements of doors, windows, rooms and any other items are approximate and no responsibility is taken for any error, omission or mis-statement. This plan is for illustrative purposes only and should be used as such by any prospective purchaser. The services, systems and appliances shown have not been tested and no guarantee as to their operability or efficiency can be given.
Made with Metropix ©2025

Important Information

- Council Tax Band: C
- Tenure: Leasehold
- Years Remaining on the Lease : 107 Years
- Annual Ground Rent: £496

EPC Rating

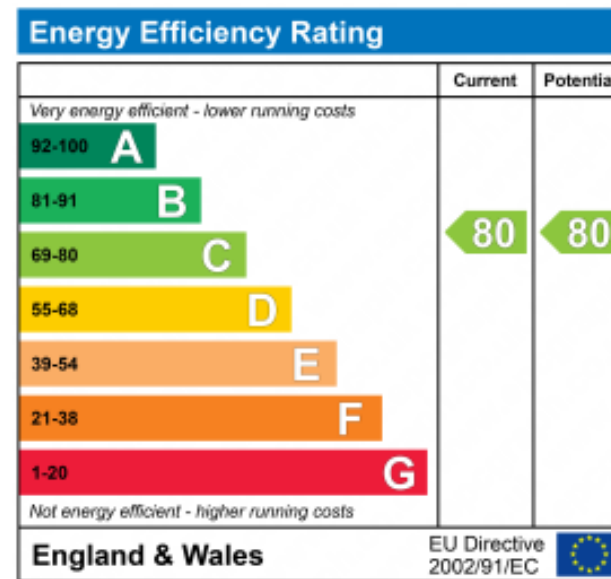

182, London Road, SK7 4DQ
T: 0161 456 6000
E: hazeltgrove@edwardmellor.co.uk



The agent has not tested apparatus, equipment, fittings or services and so cannot verify they are in working order or fit for their purpose. The buyer is advised to obtain verification from their Solicitor or Surveyor. Photographs are reproduced for general information and it must not be inferred that any item is included for sale with the property. Please note that all measurements are approximate. These particulars are issued on the understanding that any negotiations in regard to this property are carried out through Edward Mellor Ltd. This property is offered subject to not being sold or withdrawn on receipt of reply. These particulars are believed to be correct but do not form a contract for sale. None of the statements contained in these particulars as to this property are to be relied on as statements or representations of fact. The vendor does not make or give, and neither Edward Mellor Ltd. nor any person in their employment has any authority to make or give, any representation or warranty in relation to this property.