

FLOOR LAYOUT

Not to Scale - For Identification Purposes Only

BASEMENT
181 sq.ft. (16.8 sq.m.) approx.

GROUND FLOOR
384 sq.ft. (35.6 sq.m.) approx.

1ST FLOOR
381 sq.ft. (35.4 sq.m.) approx.

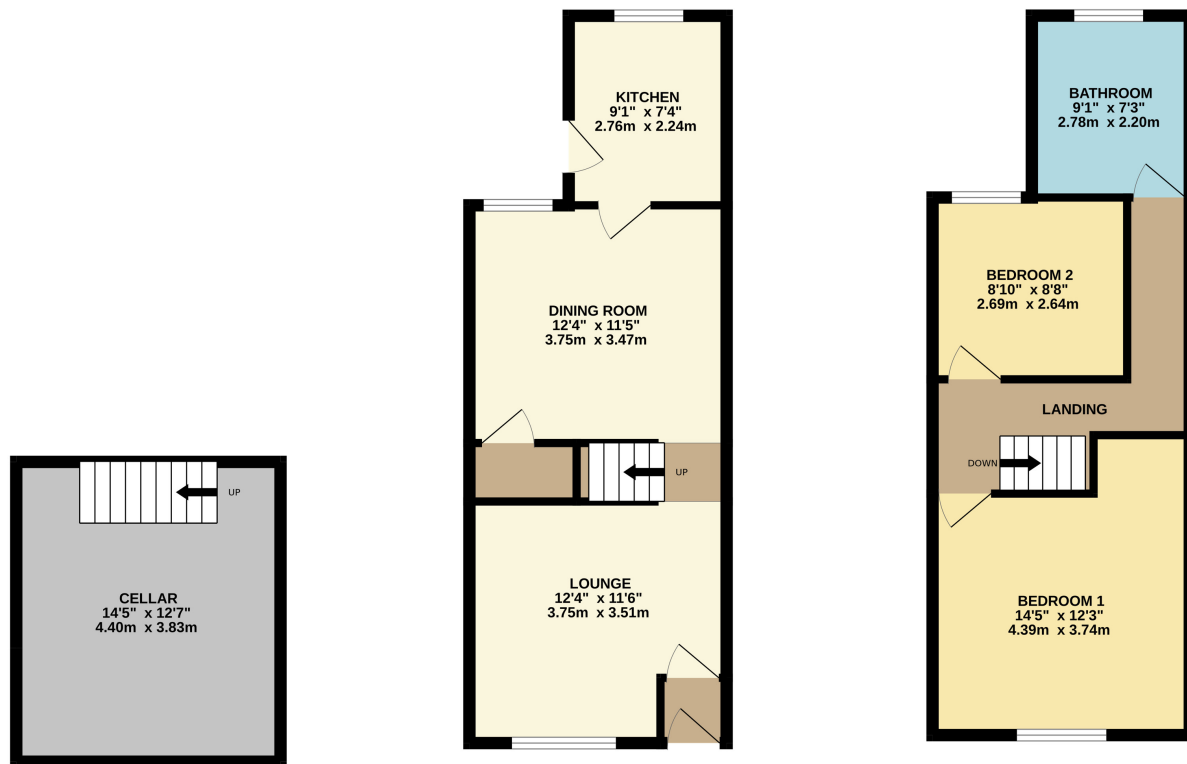

TOTAL FLOOR AREA: 945 sq.ft. (87.8 sq.m.) approx.

Whilst every attempt has been made to ensure the accuracy of the floorplan contained here, measurements of doors, windows, rooms and any other items are approximate and no responsibility is taken for any error, omission or mis-statement. This plan is for illustrative purposes only and should be used as such by any prospective purchaser. The services, systems and appliances shown have not been tested and no guarantee as to their operability or efficiency can be given.
Made with Metropix ©2024

www.edwardmellor.co.uk

182, London Road, SK7 4DQ
T: 0161 456 6000
E: hazelgrove@edwardmellor.co.uk



The agent has not tested apparatus, equipment, fittings or services and so cannot verify they are in working order or fit for their purpose. The buyer is advised to obtain verification from their Solicitor or Surveyor. Photographs are reproduced for general information and it must not be inferred that any item is included for sale with the property. Please note that all measurements are approximate. These particulars are issued on the understanding that any negotiations in regard to this property are carried out through Edward Mellor Ltd. This property is offered subject to not being sold or withdrawn on receipt of reply. These particulars are believed to be correct but do not form a contract for sale. None of the statements contained in these particulars as to this property are to be relied on as statements or representations of fact. The vendor does not make or give, and neither Edward Mellor Ltd. nor any person in their employment has any authority to make or give, any representation or warranty in relation to this property.



Features

- Beautifully Refurbished Mid Terraced
- No Onward Chain
- 2 Reception Rooms
- 2 Double Bedoms
- Superbly Fitted Kitchen & Bathroom

Attention all First Time Buyers looking for their dream first home !!! This stunning 2 double bedroom property is being offered For Sale with NO ONWARD CHAIN and is simply ready to move into with an exceptional standard of refurbishment throughout. Perhaps the exception to the "average

norm", this is a home that will be the envy of family and friends and simply must be viewed. An incredibly deceptive period home which boasts accommodation over 3 impressive floors including useful cellars for additional storage and 2 formal reception rooms for entertaining and

social gatherings. The property also enjoys a prime cul de sac location which is on the doorstep of every day amenities in this highly regarded suburb of Offerton. We challenge you to find a better first home so an early viewing is essential.



Freshly decorated and with new carpets throughout, this beautiful home also features a brand new kitchen and bathroom and has a natural flow which emphasizes its grand scale. From the Victorian style entrance porch with lead glass door is lovely size living room with feature central fireplace leading to an inner hallway with stairs ascending to the first floor. A generous size dining room is ideal fro entertaining and provides access to the cellars as well as the superbly appointed kitchen. To the first floor, an L shaped landing leads to 2 double bedrooms with the master bedroom having a feature cast iron period fireplace to add to its period charm and newly installed downlights to accentuate the brightness of the double room. A refurbished and spacious 3 piece family bathroom suite with sleek polish chrome fittings and taps completes the first floor accommodation. The property also enjoys a walled garden frontage whilst to the rear is an enclosed lawned garden for outdoor entertaining.

